

# CITY OF MERCER ISLAND

KING COUNTY



WASHINGTON

## 2021 STREET RELATED UTILITY IMPROVEMENTS

PROJECT NUMBER: 21-24

- SCHEDULE A - ARTERIAL STORM DRAINAGE
- SCHEDULE B - RESIDENTIAL STORM DRAINAGE
- SCHEDULE C - ARTERIAL WATER
- SCHEDULE D - RESIDENTIAL WATER

APRIL 2021

BID DOCUMENT

SCHEDULE B & D  
RESIDENTIAL UTILITY IMPROVEMENTS  
82ND AVE SE & SE 62ND ST

SCHEDULE A & C  
ARTERIAL UTILITY IMPROVEMENTS  
EAST MERCER WAY

### SHEET INDEX

- |     |  |
|-----|--|
| 1   | COVER AND NOTES  |
| 2-4 | SCHEDULE A & C - ARTERIAL UTILITY IMPROVEMENTS - EAST MERCER WAY             |
| 5   | SCHEDULE B & D - RESIDENTIAL UTILITY IMPROVEMENTS - 82ND AVE SE & SE 62ND ST |
| 6   | WATER DETAILS  |
| 7   | STORM DRAINAGE DETAILS   |

### GENERAL NOTES

1. TRAFFIC CONTROL SIGNS SHALL CONFORM TO M.U.T.C.D.
2. UTILITIES THAT ARE NOT ABANDONED SHALL BE SUPPORTED AND MAINTAINED DURING CONSTRUCTION.
3. EXISTING UTILITY LOCATIONS ARE APPROXIMATE. CONTRACTOR SHALL VERIFY ALL UNDERGROUND UTILITY ELEVATIONS AND REPORT ANY DISCREPANCIES TO THE ENGINEER PRIOR TO CONSTRUCTION.
4. DRIVEWAY ACCESS/EGRESS MUST BE MAINTAINED AT ALL TIMES UNLESS OTHERWISE AGREED TO BY THE PROPERTY OWNER.
5. CALL ONE CALL 48 HOURS BEFORE YOU DIG FOR UTILITY LOCATES: 1-800-424-5555 OR 811
6. REMOVAL LIMITS ARE APPROXIMATE. LIMITS SHALL BE STAKED BY THE CONTRACTOR AND APPROVED BY THE ENGINEER. TREES WITHIN THE CLEARING LIMITS SHALL BE REMOVED AFTER APPROVAL BY THE ENGINEER.
7. PROTECT ALL PLANT MATERIAL OUTSIDE OF SURFACE REMOVAL LIMITS.

### GENERAL TESC NOTES

1. THE TESC FACILITIES SHOWN ON THIS PLAN MUST BE CONSTRUCTED PRIOR TO OR IN CONJUNCTION WITH ALL CLEARING AND GRADING SO AS TO ENSURE THAT THE TRANSPORT OF SEDIMENT TO SURFACE WATERS, DRAINAGE SYSTEMS, AND ADJACENT PROPERTIES IS MINIMIZED.
2. THE TESC FACILITIES SHOWN ON THIS PLAN ARE THE MINIMUM REQUIREMENTS FOR ANTICIPATED SITE CONDITIONS. DURING THE CONSTRUCTION PERIOD, THESE TESC FACILITIES SHALL BE UPGRADED AS NEEDED FOR UNEXPECTED STORM EVENTS AND MODIFIED TO ACCOUNT FOR CHANGING SITE CONDITIONS (E.G. ADDITIONAL COVER MEASURES, ADDITIONAL SUMP PUMPS, RELOCATION OF DITCHES AND SILT FENCES, PERIMETER PROTECTION ETC.).
3. CONTRACTOR SHALL INSTALL INLET PROTECTION PER DTL 1/7 AT ALL EXISTING AND NEW CATCH BASINS WITHIN THE PROJECT LIMITS AS WELL AS DOWNSTREAM OF THE WORK AREA, AS DIRECTED BY THE ENGINEER.

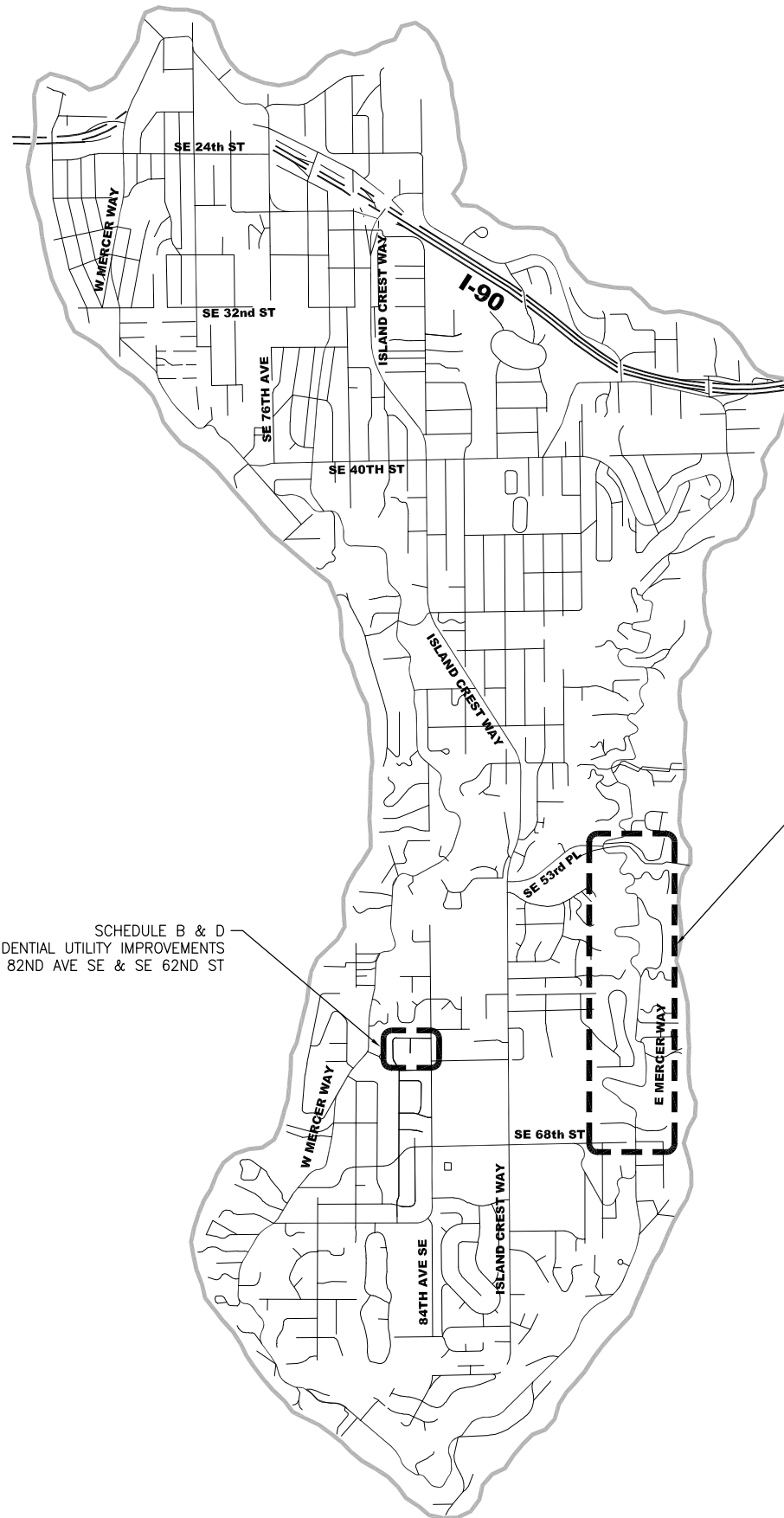

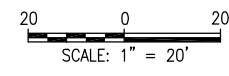

### GENERAL NOTES

1. TYPICAL STORM DRAINAGE TRENCH SECTION PER DTL 2/7.
2. TYPICAL WATER SERVICE TRENCH SECTION PER MI STD DTL W-3/6.
3. ARTERIAL HMA PAVING DEPTH SHALL MATCH EX ASPH DEPTH TO A MAX OF 8" OR AS DIRECTED BY ENGINEER.
4. SEE WATER SERVICE TABLES ON SHEET 7 FOR SERVICE INFORMATION.

### CONSTRUCTION NOTES

#### SCHEDULE A - ARTERIAL STORM DRAINAGE

1. INSTALL APPROX 95 LF OF 6" SOLID WALL SDR 35 PVC PIPE AT 2% MIN SLOPE AND 12" MIN COVER. CONNECT UPSTREAM END TO EX 4" PVC WITH 6"x4" REDUCER AND INSTALL 6" WYE, 6" RISER, AND 6" SCREW PLUG FOR CLEANOUT. INSTALL CAST IRON CLEANOUT RING AND COVER (OLYMPIC FOUNDRY M1007 OR EQUAL) BEHIND EX PAVEMENT. CONNECT DOWNSTREAM END TO EX CB 43B-37
2. EXCAVATE APPROX 75 LF OF DITCH TO RE-ESTABLISH FLOWLINE. LINE WITH 2"-4" ROCK PER DTL 4/7
3. INSTALL CITY-SUPPLIED 12" TRASH RACK AS DIRECTED BY ENGINEER. PAID AS FORCE ACCOUNT
4. INSTALL NEW TYPE 1 CB AS FIELD LOCATED AND ADJUST TO GRADE PER DTL 3/7. INSTALL APPROX 30 LF OF 8" DI PIPE FOR CROSSING. CONNECT INTO EX CB 42-57. MAINTAIN 2% MIN SLOPE AND APPROX 18" OF COVER

#### SCHEDULE C - ARTERIAL WATER

1. FURNISH AND INSTALL 12" FIRE HYDRANT EXTENSION AND PAINT PER SECTION 7-14
2. PERFORM EXPLORATORY EXCAVATION TO EXPOSE THE SERVICE LINE FOR THE FIRST THREE TO FIVE FEET ON THE CITY SIDE OF THE METER SO THE ENGINEER MAY VERIFY SERVICE LINE MATERIAL PRIOR TO REPLACEMENT. GALVANIZED IRON SERVICES WILL BE REPLACED
3. INSTALL NEW 1" WATER SERVICE PER MI STD DTL W-13/6. DISCONNECT AND ABANDON EX WATER SERVICE IN PLACE. RECONNECT TO EX METER AND METER SETTER IN EX METER BOX
4. MOLE NEW SERVICE LINE UNDER CONCRETE DRIVEWAY PAVEMENT
5. RELOCATE EX METER, SETTER, AND METER BOX TO 5' SOUTHWESTERLY OF EX LOCATION AS DIRECTED BY ENGINEER. RECONNECT TO HOMEOWNER'S SERVICE LINE WITH LIKE SIZE COPPER

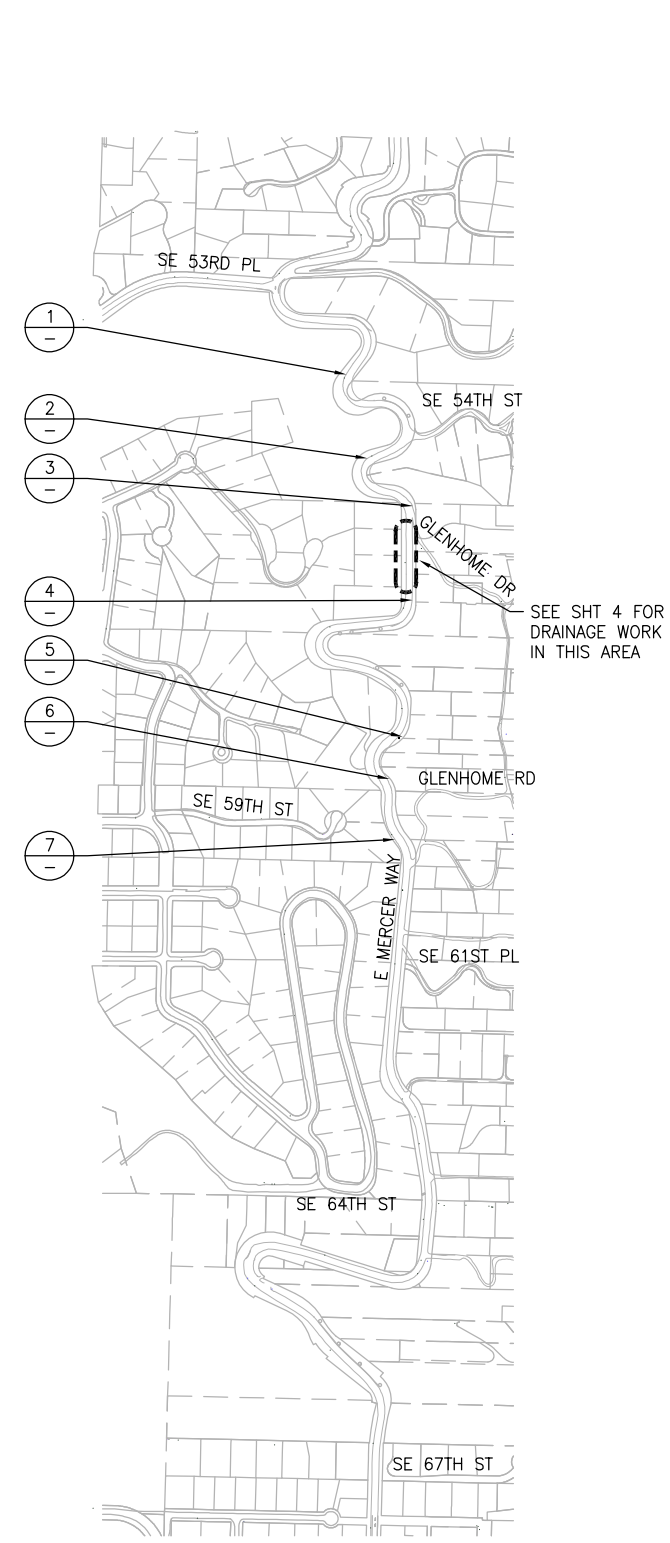

**KEY MAP**  
SCALE: 1"=400'

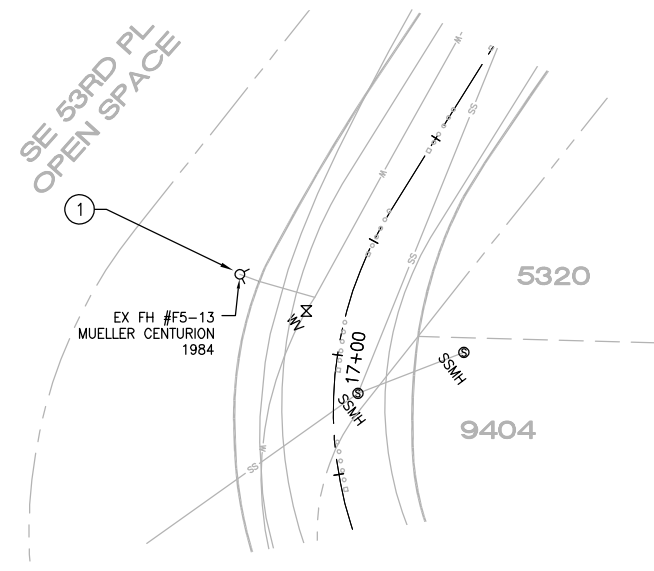

**1 FH #F5-13**  
SCALE: 1"=20'

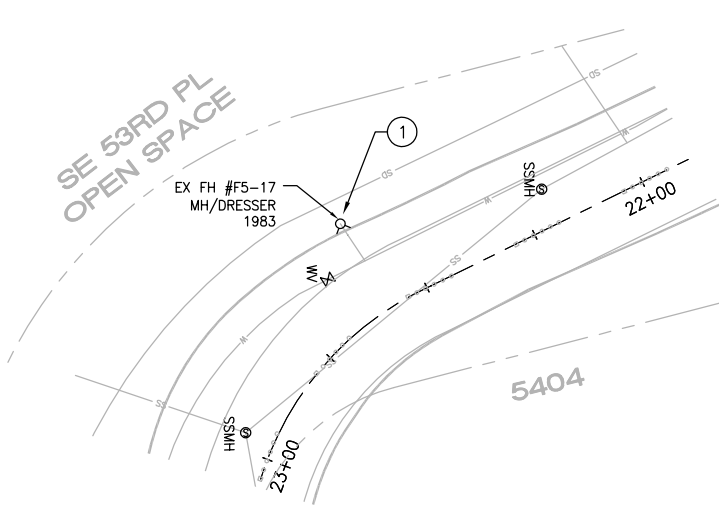

**2 FH #F5-17**  
SCALE: 1"=20'

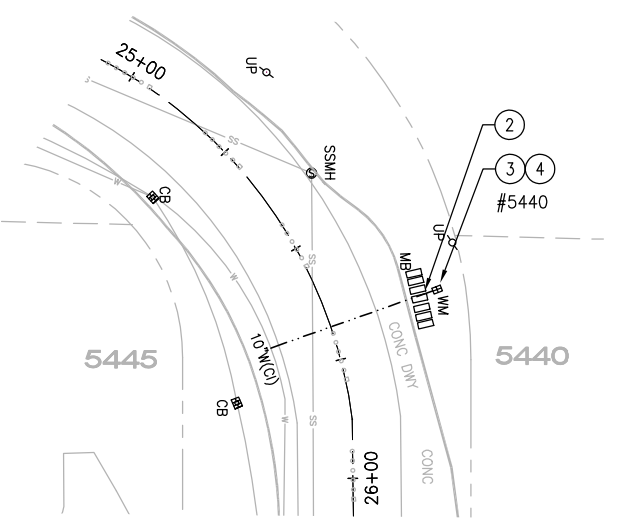

**3 WM #5440**  
SCALE: 1"=20'

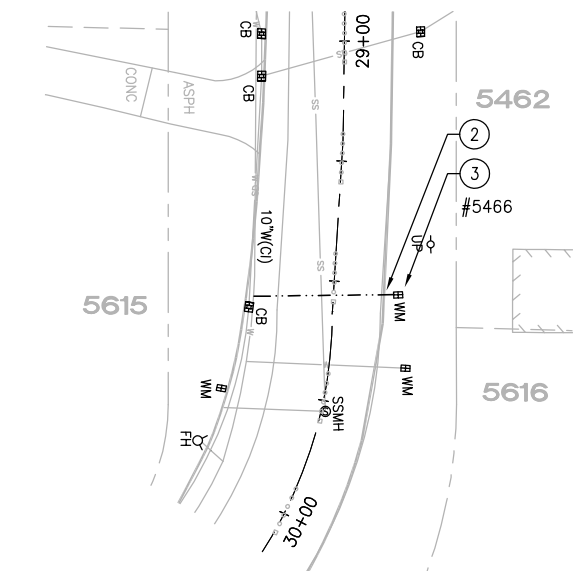

**4 WM #5466**  
SCALE: 1"=20'

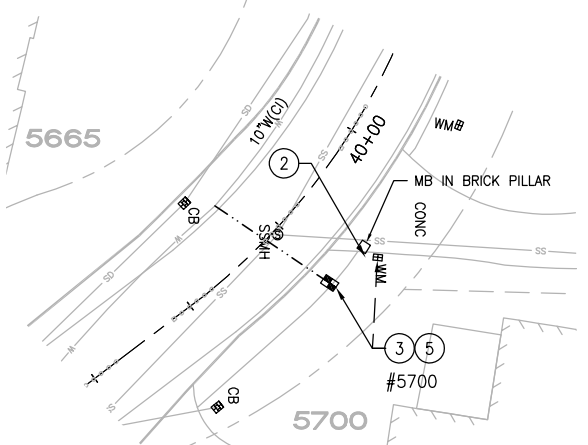

**5 WM #5700**  
SCALE: 1"=20'

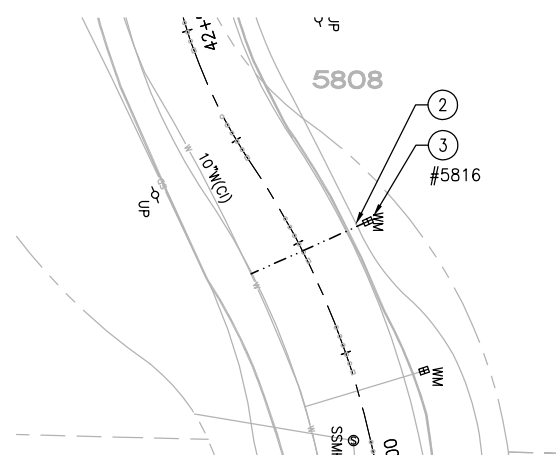

**6 WM #5816**  
SCALE: 1"=20'

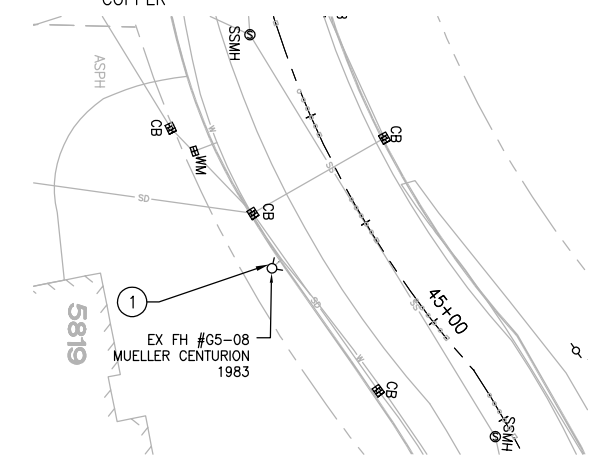

**7 FH #G5-08**  
SCALE: 1"=20'

File: Z:\2020 Projects\Utility\Plans\202004\_P-ITL-EUW.dwg ID: john Date: 15-Apr-21 1:13:47pm



**CM DESIGN GROUP**  
1318 East Pike Street  
Seattle, WA 98122  
206-659-0612

REV. NO.	DATE	DESCRIPTION

**BID DOCUMENT**



DATE	4/15/21
DESIGN	JST
DRAFT	JST
CHECK	JST

**CITY OF MERCER ISLAND**  
**2021 STREET RELATED**  
**UTILITY IMPROVEMENTS**  
SCHEDULE A & B  
ARTERIAL UTILITY IMPROVEMENTS  
E MERCER WAY

PROJECT	21-24
SCALE	AS NOTED
SHEET	2 OF 7



20 0 20  
SCALE: 1" = 20'

### GENERAL NOTES

1. TYPICAL STORM DRAINAGE TRENCH SECTION PER DTL 2/7.
2. TYPICAL WATER SERVICE TRENCH SECTION PER MI STD DTL W-3/6.
3. ARTERIAL HMA PAVING DEPTH SHALL MATCH EX ASPH DEPTH TO A MAX OF 8" OR AS DIRECTED BY ENGINEER.
4. SEE WATER SERVICE TABLES ON SHEET 7 FOR SERVICE INFORMATION.

### CONSTRUCTION NOTES

#### SCHEDULE A - ARTERIAL STORM DRAINAGE

- 1 INSTALL APPROX 95 LF OF 6" SOLID WALL SDR 35 PVC PIPE AT 2% MIN SLOPE AND 12" MIN COVER. CONNECT UPSTREAM END TO EX 4" PVC WITH 6"x4" REDUCER AND INSTALL 6" WYE, 6" RISER, AND 6" SCREW PLUG FOR CLEANOUT. INSTALL CAST IRON CLEANOUT RING AND COVER (OLYMPIC FOUNDRY M1007 OR EQUAL) BEHIND EX PAVEMENT. CONNECT DOWNSTREAM END TO EX CB 43B-37
- 2 EXCAVATE APPROX 75 LF OF DITCH TO RE-ESTABLISH FLOWLINE. LINE WITH 2"-4" ROCK PER DTL 4/7
- 3 INSTALL CITY-SUPPLIED 12" TRASH RACK AS DIRECTED BY ENGINEER. PAID AS FORCE ACCOUNT
- 4 INSTALL NEW TYPE 1 CB AS FIELD LOCATED AND ADJUST TO GRADE PER DTL 3/7. INSTALL APPROX 30 LF OF 8" DI PIPE FOR CROSSING. CONNECT INTO EX CB 42-57. MAINTAIN 2% MIN SLOPE AND APPROX 18" OF COVER

#### SCHEDULE C - ARTERIAL WATER

- 1 FURNISH AND INSTALL 12" FIRE HYDRANT EXTENSION AND PAINT PER SECTION 7-14
- 2 PERFORM EXPLORATORY EXCAVATION TO EXPOSE THE SERVICE LINE FOR THE FIRST THREE TO FIVE FEET ON THE CITY SIDE OF THE METER SO THE ENGINEER MAY VERIFY SERVICE LINE MATERIAL PRIOR TO REPLACEMENT. GALVANIZED IRON SERVICES WILL BE REPLACED
- 3 INSTALL NEW 1" WATER SERVICE PER MI STD DTL W-13/6. DISCONNECT AND ABANDON EX WATER SERVICE IN PLACE. RECONNECT TO EX METER AND METER SETTER IN EX METER BOX
- 4 MOLE NEW SERVICE LINE UNDER CONCRETE DRIVEWAY PAVEMENT
- 5 RELOCATE EX METER, SETTER, AND METER BOX TO 5' SOUTHWESTERLY OF EX LOCATION AS DIRECTED BY ENGINEER. RECONNECT TO HOMEOWNER'S SERVICE LINE WITH LIKE SIZE COPPER

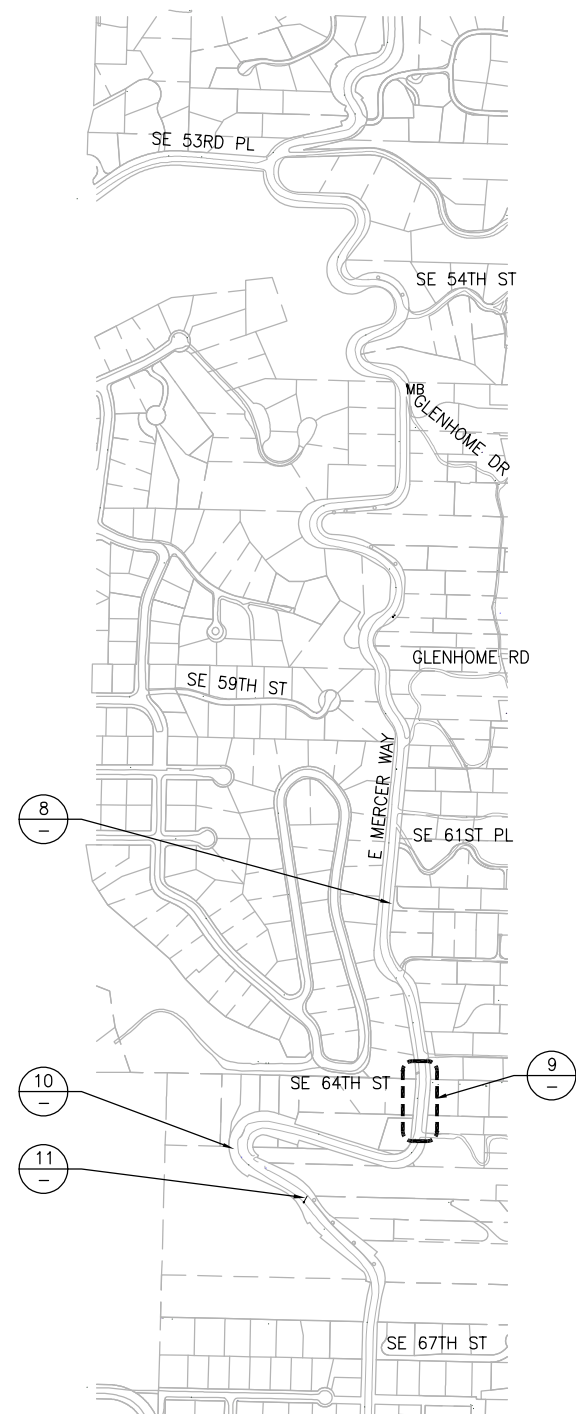

### KEY MAP

SCALE: 1"=400'

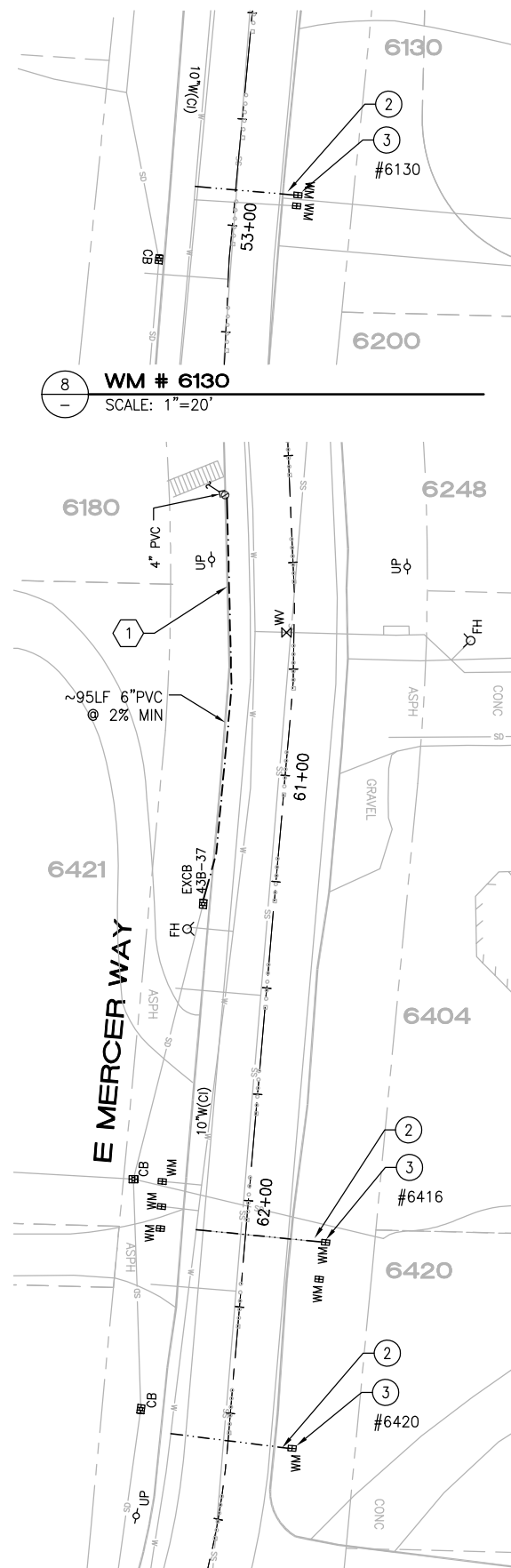

### DETAIL 8

SCALE: 1"=20'

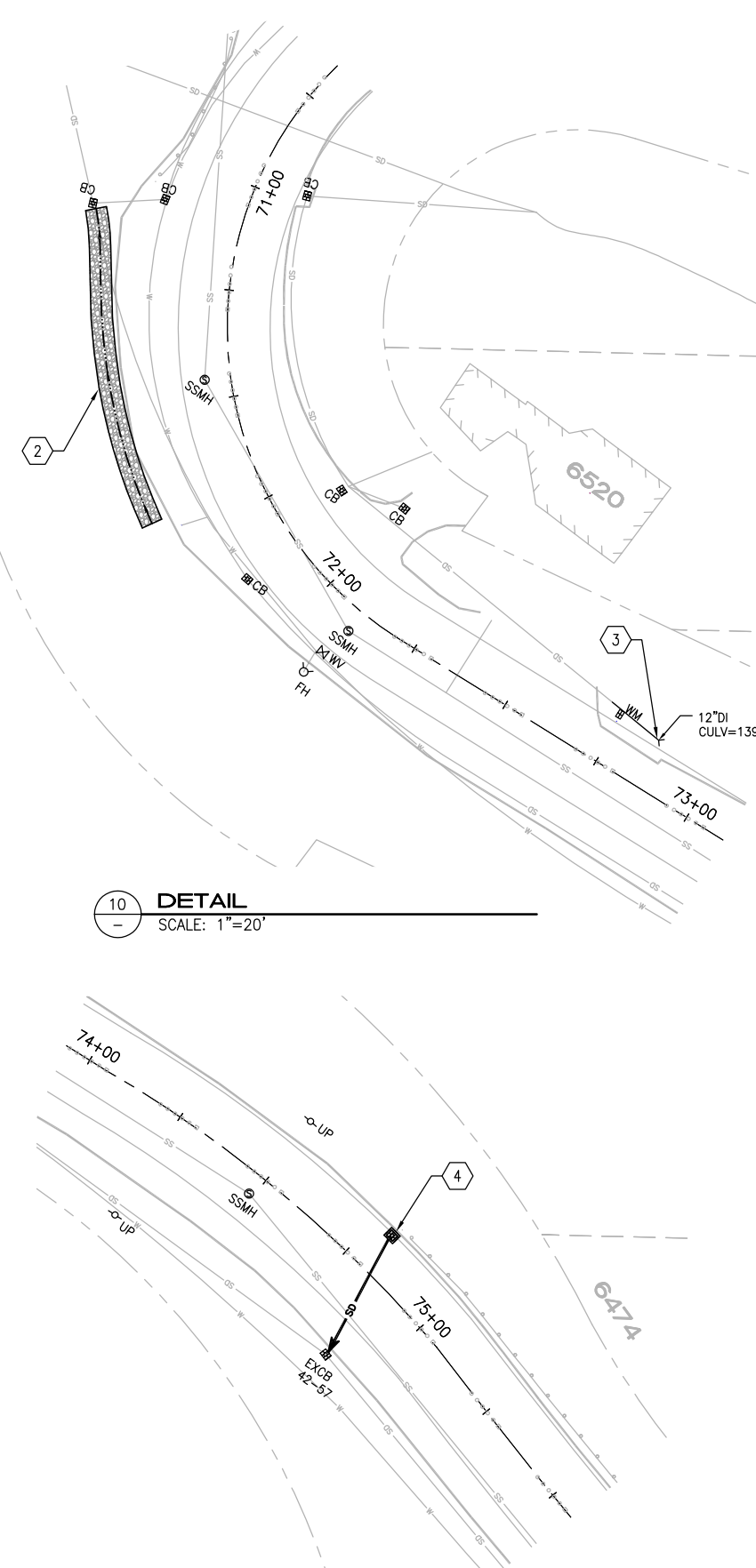

### DETAIL 10

SCALE: 1"=20'

### DETAIL 11

SCALE: 1"=20'

File: Z:\2020 Projects\Utility Plans\20004\_P-ITL-EMW.dwg ID: john Date: 15-Apr-21 11:15:55am



CM DESIGN GROUP

1318 East Pike Street  
Seattle, WA 98122  
206-659-0612

REV. NO. DATE DESCRIPTION

BID DOCUMENT

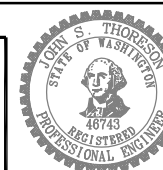

DATE	4/15/21
DESIGN	JST
DRAFT	JST
CHECK	JST

CITY OF MERCER ISLAND  
2021 STREET RELATED  
UTILITY IMPROVEMENTS

SCHEDULE A & B  
ARTERIAL UTILITY IMPROVEMENTS  
E MERCER WAY

PROJECT 21-24

SCALE AS NOTED

SHEET

3 OF 7

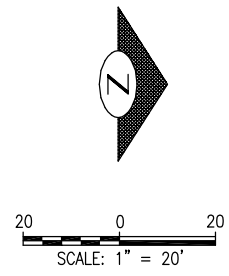
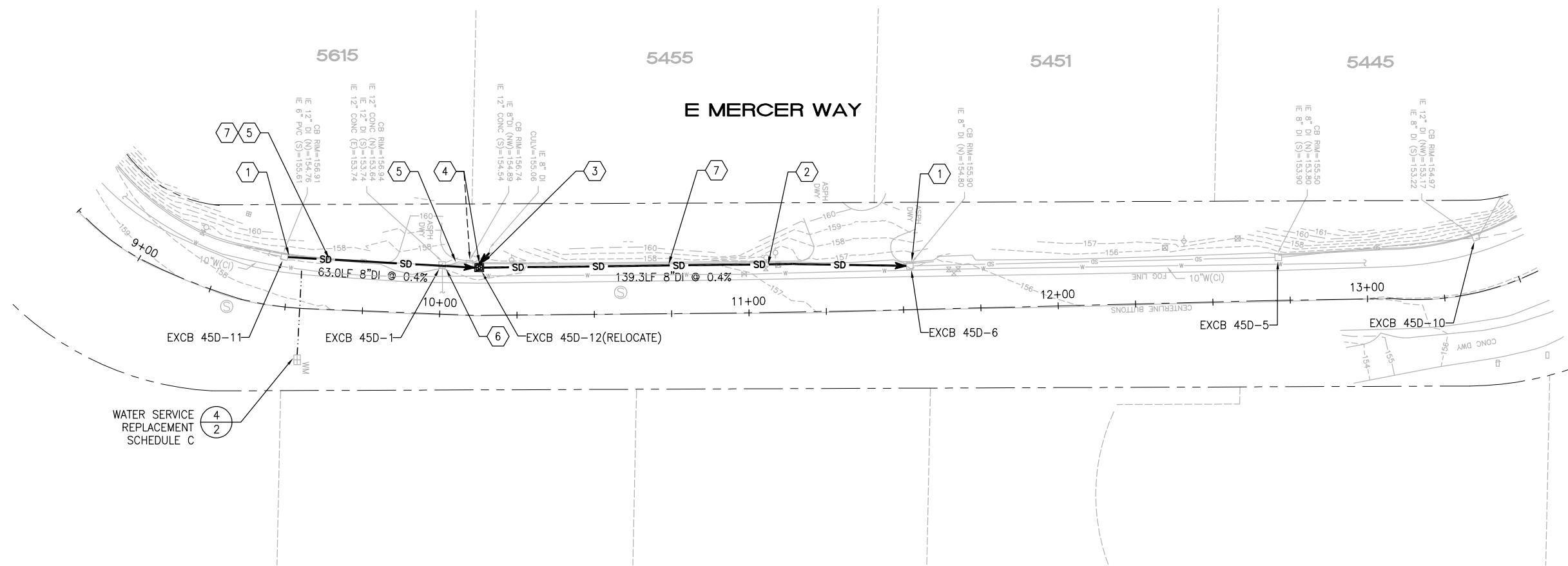

- ### GENERAL NOTES
1. TYPICAL STORM DRAINAGE TRENCH SECTION PER DTL 2/7.
  2. ARTERIAL HMA PAVING DEPTH SHALL MATCH EX ASPH DEPTH TO A MAX OF 8" OR AS DIRECTED BY ENGINEER.
  3. STATIONS AND OFFSETS ARE PROVIDED FOR REFERENCE. SURVEY IS NOT REQUIRED.

- ### CONSTRUCTION NOTES
- SCHEDULE A - ARTERIAL STORM DRAINAGE
- 1 CONNECT TO EX CB AT EX IE
  - 2 HORIZONTALLY DEFLECT 8"DI PIPE AS DIRECTED BY ENGINEER TO PASS PIPE BETWEEN HYDRANT AND VALVE
  - 3 RECONNECT EX 8"DI PIPE STUB INTO RELOCATED CB
  - 4 RELOCATE EXCB 45D-12 APPROX 3' NORTH AND 1' EAST AS DIRECTED BY ENGINEER AND ADJUST TO GRADE PER DTL 3/7
  - 5 REMOVE APPROX 49LF EX 12"DI PIPE AND 6LF OF 12"CONC PIPE
  - 6 REMOVE EX CB 45D-1. REMOVE APPROX 6LF OF EX 12"CONC PIPE TO THE EAST AS DIRECTED BY ENGINEER. PLUG AND ABANDON REMAINING PIPE CROSSING
  - 7 INSTALL NEW PIPE

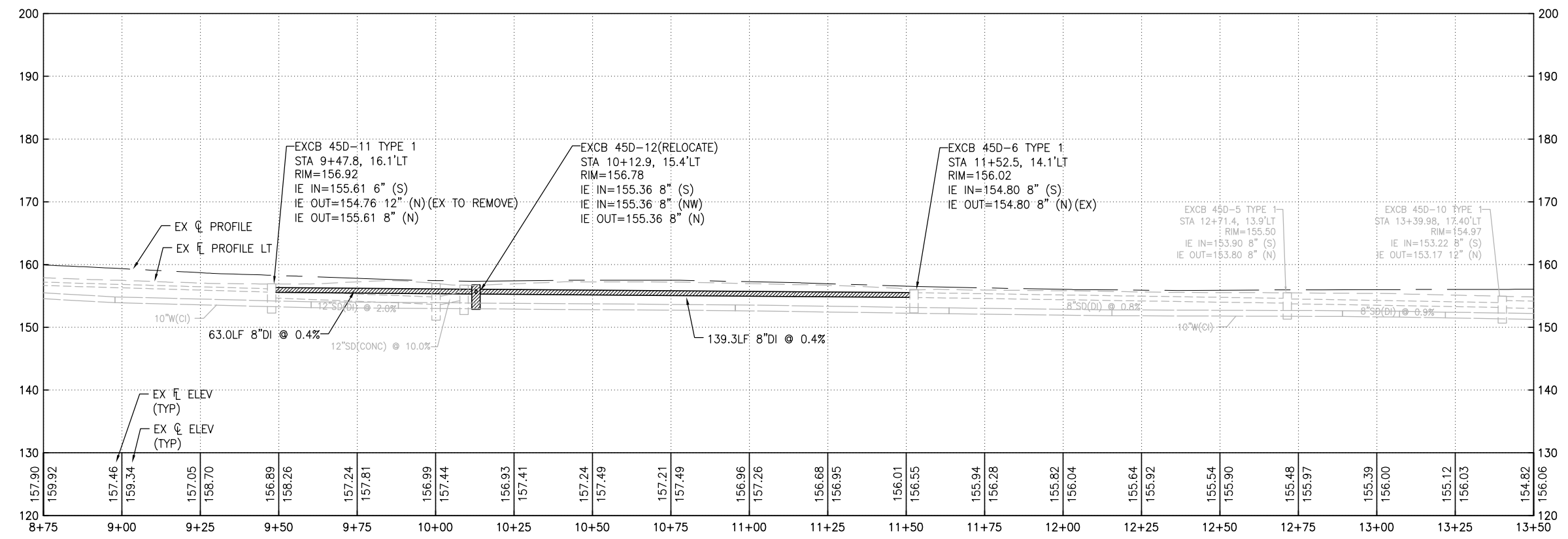

File: Z:\2019 Projects\19018\_MI\_2020\_Overlays\Drawings\19018\_P-STRA-EMW.dwg ID: john Date: 15-Apr-21 11:35:27am



**CM DESIGN GROUP**  
 1318 East Pike Street  
 Seattle, WA 98122  
 206-659-0612

REV. NO.	DATE	DESCRIPTION

**BID DOCUMENT**



DATE	4/15/21
DESIGN	JUST
DRAFT	JUST
CHECK	JUST

**CITY OF MERCER ISLAND**  
**2021 STREET RELATED**  
**UTILITY IMPROVEMENTS**  
 SCHEDULE A & B  
 ARTERIAL UTILITY IMPROVEMENTS  
 E MERCER WAY

PROJECT	21-24
SCALE	H. 1"=20' V. 1"=10'
SHEET	<b>4</b> OF <b>7</b>

File: Z:\2020 Projects\Utility Plans\20204\_P-ITL-601.dwg ID: john Date: 15-Apr-21 1:14:02pm

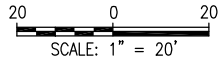
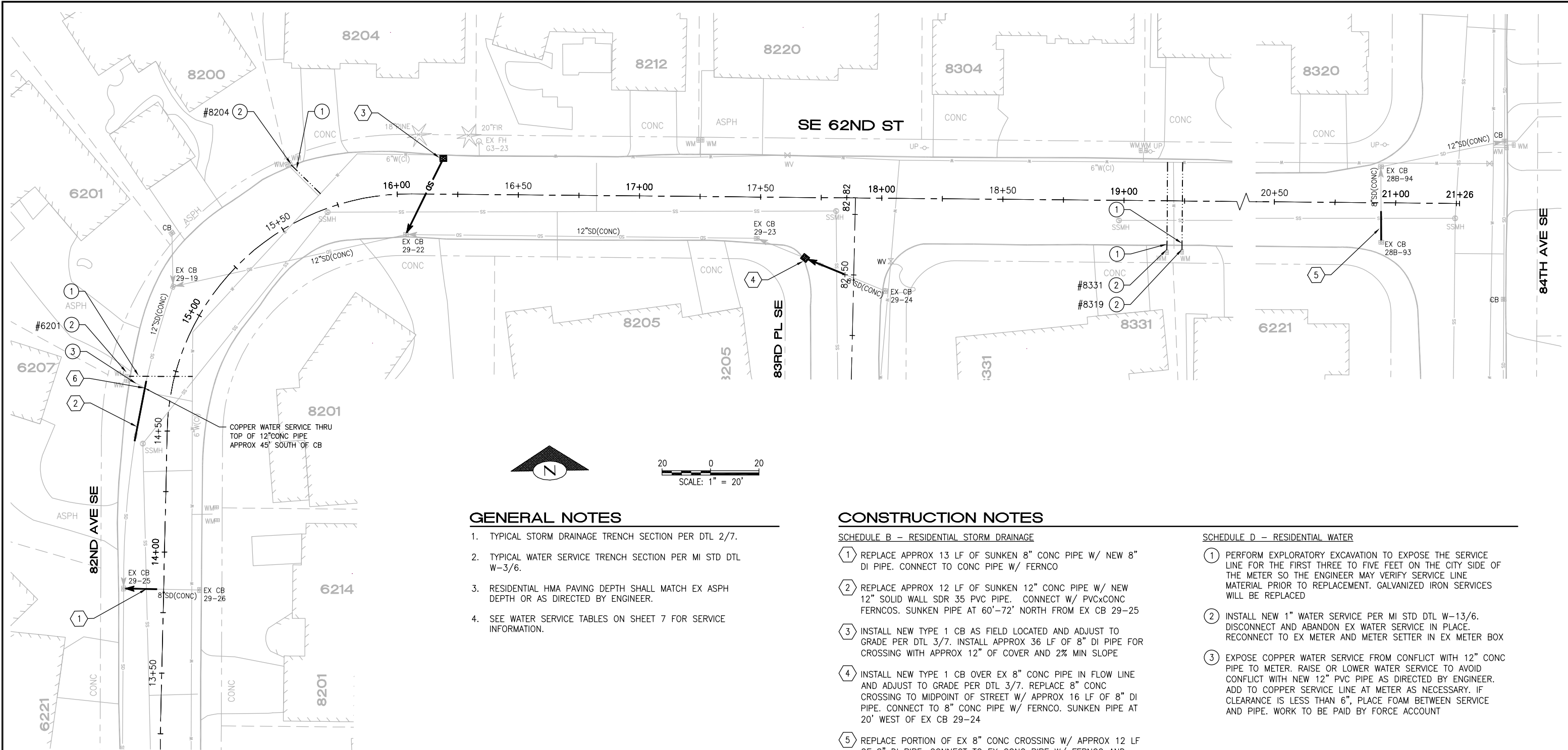

**GENERAL NOTES**

1. TYPICAL STORM DRAINAGE TRENCH SECTION PER DTL 2/7.
2. TYPICAL WATER SERVICE TRENCH SECTION PER MI STD DTL W-3/6.
3. RESIDENTIAL HMA PAVING DEPTH SHALL MATCH EX ASPH DEPTH OR AS DIRECTED BY ENGINEER.
4. SEE WATER SERVICE TABLES ON SHEET 7 FOR SERVICE INFORMATION.

**CONSTRUCTION NOTES**

SCHEDULE B – RESIDENTIAL STORM DRAINAGE

- ① REPLACE APPROX 13 LF OF SUNKEN 8" CONC PIPE W/ NEW 8" DI PIPE. CONNECT TO CONC PIPE W/ FERNCO
- ② REPLACE APPROX 12 LF OF SUNKEN 12" CONC PIPE W/ NEW 12" SOLID WALL SDR 35 PVC PIPE. CONNECT W/ PVCxCONC FERNCOS. SUNKEN PIPE AT 60'-72' NORTH FROM EX CB 29-25
- ③ INSTALL NEW TYPE 1 CB AS FIELD LOCATED AND ADJUST TO GRADE PER DTL 3/7. INSTALL APPROX 36 LF OF 8" DI PIPE FOR CROSSING WITH APPROX 12" OF COVER AND 2% MIN SLOPE
- ④ INSTALL NEW TYPE 1 CB OVER EX 8" CONC PIPE IN FLOW LINE AND ADJUST TO GRADE PER DTL 3/7. REPLACE 8" CONC CROSSING TO MIDPOINT OF STREET W/ APPROX 16 LF OF 8" DI PIPE. CONNECT TO 8" CONC PIPE W/ FERNCO. SUNKEN PIPE AT 20' WEST OF EX CB 29-24
- ⑤ REPLACE PORTION OF EX 8" CONC CROSSING W/ APPROX 12 LF OF 8" DI PIPE. CONNECT TO EX CONC PIPE W/ FERNCO AND CONNECT INTO CB. SUNKEN PIPE AT 19-25' SOUTH OF EX CB 28B-94
- ⑥ EXTEND 12" PVC PIPE REPLACEMENT NORTH APPROX 13' (25LF NEW PIPE TOTAL) TO REPAIR EX 12" CONC PIPE WITH COPPER WATER SERVICE PUNCHED THROUGH. MAINTAIN EX STORM PIPE ALIGNMENT. SEE SCH D NOTE 3 BELOW FOR WATER SERVICE WORK

SCHEDULE D – RESIDENTIAL WATER

- ① PERFORM EXPLORATORY EXCAVATION TO EXPOSE THE SERVICE LINE FOR THE FIRST THREE TO FIVE FEET ON THE CITY SIDE OF THE METER SO THE ENGINEER MAY VERIFY SERVICE LINE MATERIAL PRIOR TO REPLACEMENT. GALVANIZED IRON SERVICES WILL BE REPLACED
- ② INSTALL NEW 1" WATER SERVICE PER MI STD DTL W-13/6. DISCONNECT AND ABANDON EX WATER SERVICE IN PLACE. RECONNECT TO EX METER AND METER SETTER IN EX METER BOX
- ③ EXPOSE COPPER WATER SERVICE FROM CONFLICT WITH 12" CONC PIPE TO METER. RAISE OR LOWER WATER SERVICE TO AVOID CONFLICT WITH NEW 12" PVC PIPE AS DIRECTED BY ENGINEER. ADD TO COPPER SERVICE LINE AT METER AS NECESSARY. IF CLEARANCE IS LESS THAN 6", PLACE FOAM BETWEEN SERVICE AND PIPE. WORK TO BE PAID BY FORCE ACCOUNT



**CM DESIGN GROUP**  
 1318 East Pike Street  
 Seattle, WA 98122  
 206-659-0612

REV. NO.	DATE	DESCRIPTION

**BID DOCUMENT**



DATE	4/15/21
DESIGN	JST
DRAFT	JST
CHECK	JST

**CITY OF MERCER ISLAND**  
**2021 STREET RELATED**  
**UTILITY IMPROVEMENTS**  
 SCHEDULE C & D  
**RESIDENTIAL UTILITY IMPROVEMENTS**  
 82ND AVE SE & SE 62ND ST

PROJECT	21-24
SCALE	1"=20'
SHEET	5 OF 7

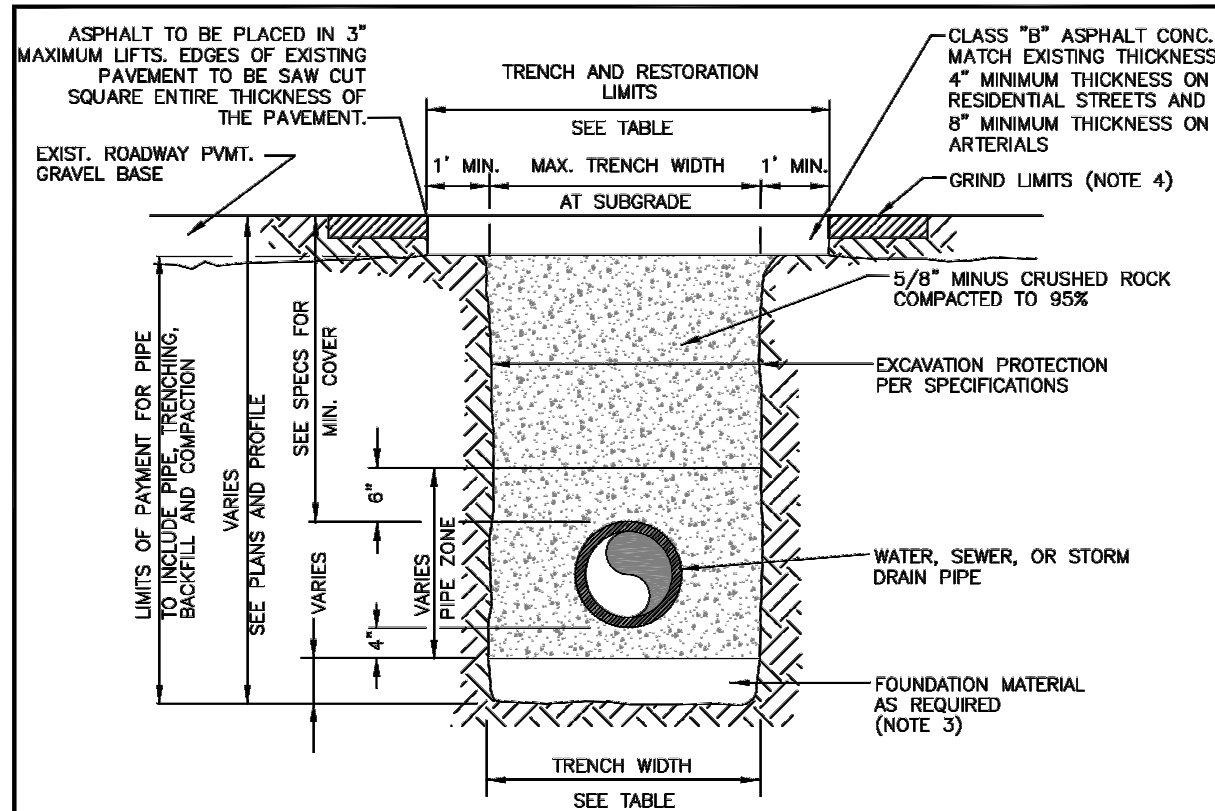

WIDTH TRENCH			
PIPE SIZE	PIPE ZONE MAX. TRENCH WIDTH	MAX. TRENCH WIDTH AT SUBGRADE	MAX. RESTORATION WIDTH AT SURFACE
WATER SERVICES	2'-0"	2'-0"	4'-0"
4" OR 6"	2'-2"	3'-0"	5'-0"
8"	2'-4"	4'-0"	6'-0"
10"	2'-6"	4'-0"	6'-0"
12"	2'-8"	4'-6"	6'-6"
16"	3'-0"	5'-0"	7'-0"

**NOTES**

- CALL IN LOCATES TWO BUSINESS DAYS BEFORE YOU DIG. (1-800-424-5555)
- IN RIGHT-OF-WAY USE 100% 5/8 MINUS CRUSHED ROCK FOR BEDDING, PIPE ZONE AND BACKFILL
- FOUNDATION MATERIAL SHALL BE 1 1/2" MINUS CRUSHED ROCK OR OTHER AGGREGATE AS APPROVED BY CITY ENGINEER.
- GRIND AND OVERLAY LIMITS SHALL EXTEND A MINIMUM OF 10' PAST THE END OF TRENCH AREAS.
- SEAL ALL FINAL PATCHING AND PAVING SEAMS WITH LIQUID ASPHALT. SQUEEGEE OR MOP THE SEALER. COVER WITH DRY SAND.



**CITY OF MERCER ISLAND  
STANDARD DETAILS  
WATER**

**TRENCH SECTION**

3-29-2021 NO SCALE **W-3**

APPROVED

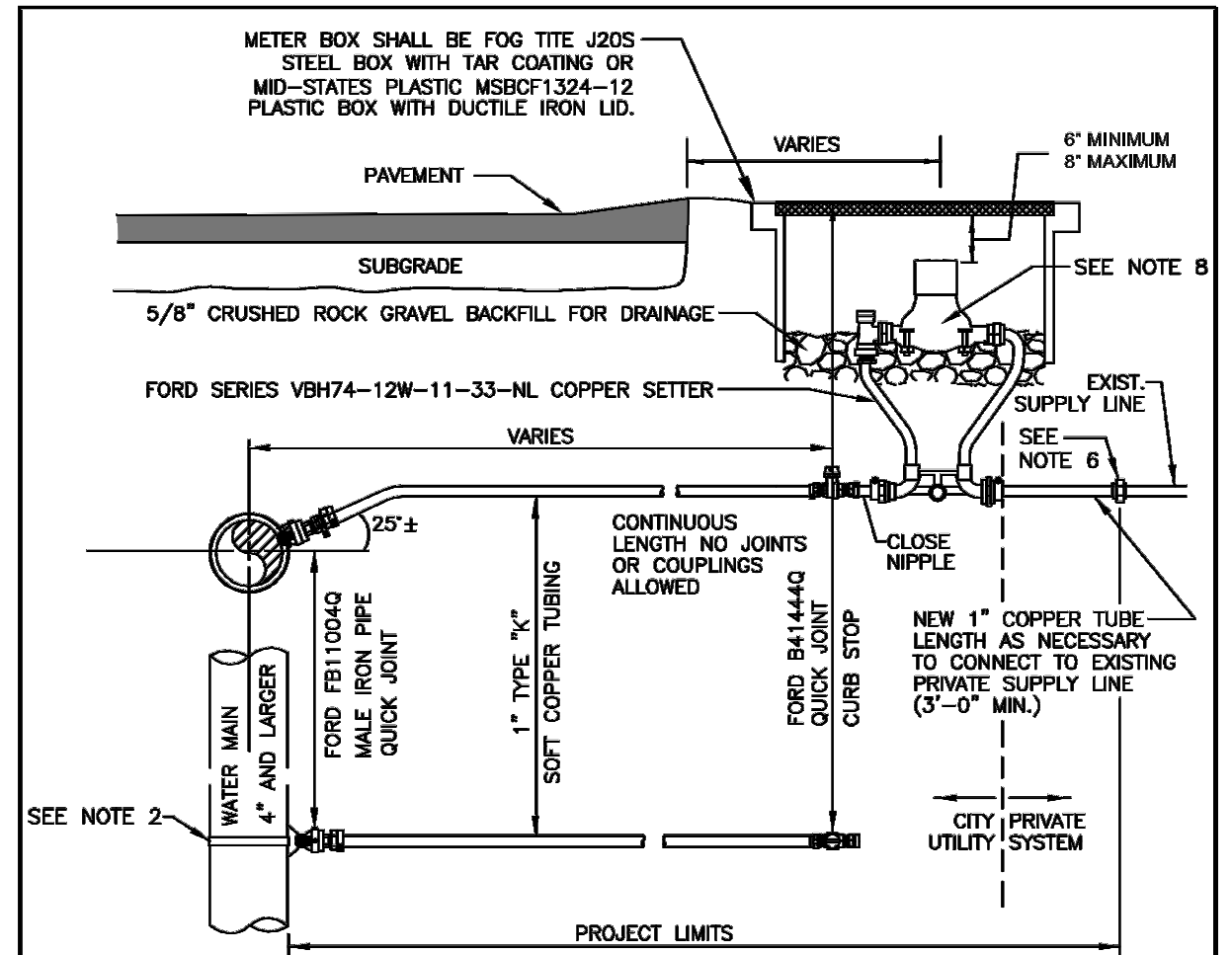

**NOTES**

- WATER SERVICES SHALL COMPLY WITH THE REDUCTION OF LEAD IN DRINKING WATER ACT DATED 01/04/2014.
- ON EXISTING WATER MAINS USE NYLON COATED D.I. SADDLE WITH STAINLESS STEEL DOUBLE STRAPS, ROMAC 202NS, OR APPROVED EQUAL.
- MINIMUM DISTANCE BETWEEN CORP STOPS SHALL BE 18". MINIMUM DISTANCE BETWEEN TAPS, BETWEEN CORP STOP AND PIPE ENDS SHALL BE 24", ALL HORIZONALLY STAGGERED.
- PLASTIC METER BOXES SHALL NOT BE INSTALLED WITHIN ROADWAY, SIDEWALK, OR DRIVEWAYS.
- UPON CITY ENGINEER'S APPROVAL, METER BOXES ARE ALLOWED TO BE INSTALLED IN PORTLAND CEMENT CONCRETE PAVEMENT OR SIDEWALK.
- WHEN CONNECTING TO EXISTING PRIVATE SUPPLY LINE CONTAINING FERROUS METAL, PROVIDE INSULATING COUPLING (DB SERIES WITH C21 SERIES ADAPTERS) AND PROVIDE REDUCER AS NECESSARY TO MATCH EXISTING PRIVATE SUPPLY LINE DIAMETER.
- SERVICE LINE SHALL BE PERPENDICULAR TO THE WATER MAIN AND STRAIGHT TO WATER METER, UNLESS OTHERWISE APPROVED BY CITY ENGINEER. PROVIDE WINDING SLACK IN THE SERVICE LINE BETWEEN THE MAIN AND WATER METER.
- WATER METER SUPPLIED BY CITY.
- ALL FITTINGS TO BE BRASS COMPRESSION TYPE, FORD QUICK JOINT OR EQUAL.
- NO SERVICE CONNECTIONS BETWEEN BLOW-OFF AND END OF MAIN.



**CITY OF MERCER ISLAND  
STANDARD DETAILS  
WATER**

**1" WATER METER INSTALLATION**

02-05-2021 NO SCALE **W-13**

APPROVED

File: Z:\2020 Projects\Utility Plans\2004\_P-101-021.dwg ID: john Date: 15-Apr-21 1:14:07pm



REV. NO.	DATE	DESCRIPTION

**BID DOCUMENT**

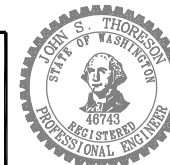

DATE	4/15/21
DESIGN	JST
DRAFT	JST
CHECK	JST

**CITY OF MERCER ISLAND  
2021 STREET RELATED  
UTILITY IMPROVEMENTS**

WATER DETAILS

PROJECT	21-24
SCALE	NONE
SHEET	6 OF 7

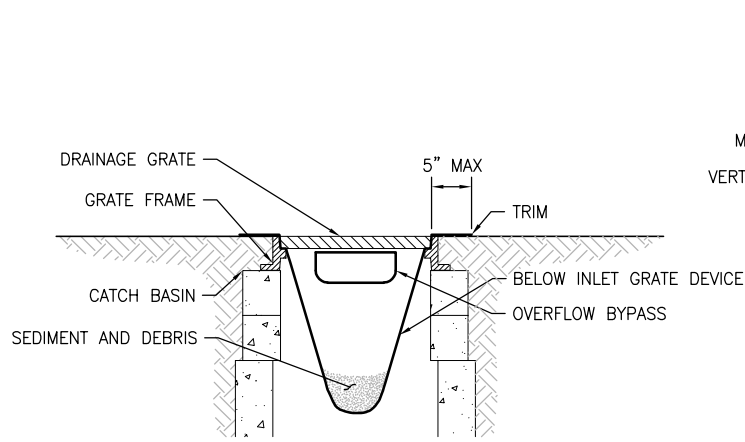

- NOTES:
1. SIZE THE BELOW INLET GRATE DEVICE (BIGD) FOR THE STORM WATER STRUCTURE IT WILL SERVICE.
  2. THE BIGD SHALL HAVE A BUILT-IN HIGH-FLOW RELIEF SYSTEM (OVERFLOW BYPASS).
  3. THE RETRIEVAL SYSTEM MUST ALLOW REMOVAL OF THE BIGD WITHOUT SPILLING THE COLLECTED MATERIAL.

1 INLET PROTECTION  
NTS

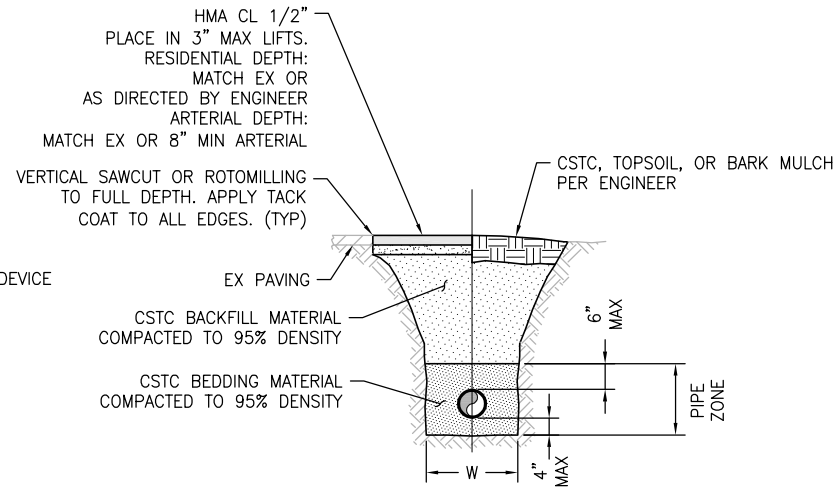

- NOTE:  
ALL CSTC PIPE BEDDING AND BACKFILL PAID FOR PER TON BY CSTC BID ITEM.

2 TYPICAL STORM DRAIN TRENCH  
NTS

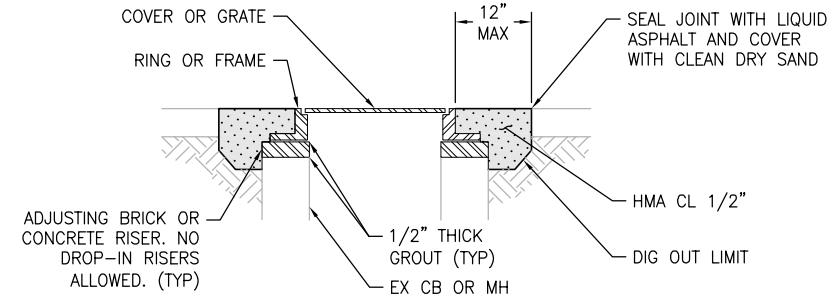

- NOTES:
1. ASPHALT PERIMETER SHALL EXTEND 2" BELOW ADJUSTMENT RINGS.
  2. UTILITIES WITH CONCRETE RINGS AROUND STRUCTURE SHALL HAVE CONCRETE REMOVED AND REPLACED WITH ACP PER THIS DETAIL.
  3. ADD OR REMOVE BRICK AND/OR RISERS TO ACHIEVE REQUIRED FINISHED RIM ELEVATION.
  4. CATCH BASINS IN THE FLOWLINE SHALL BE ADJUSTED TO FINISH GRADE PRIOR TO PAVING UNLESS DIRECTED BY THE ENGINEER.
  5. MANHOLES, VALVE BOXES, AND MONUMENTS SHALL BE ADJUSTED TO FINISH GRADE AFTER PAVING.

3 TYPICAL UTILITY ADJUSTMENT  
NTS

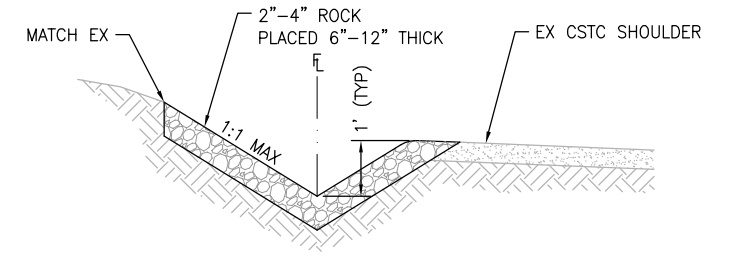

4 DITCH RESTORATION  
NTS

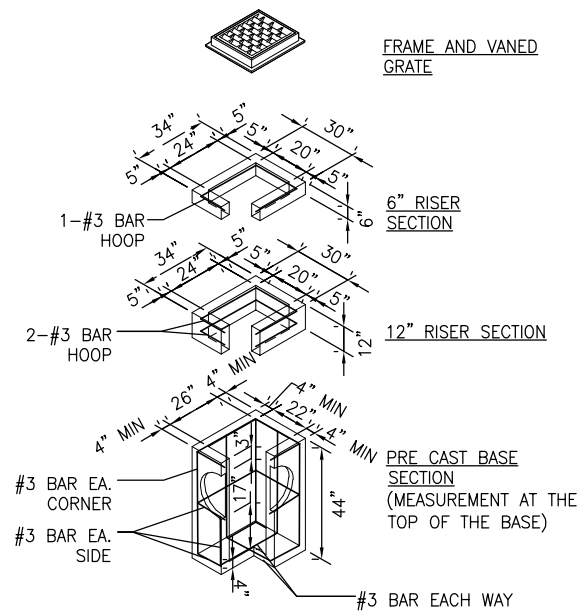

- NOTES:
1. CATCH BASIN TO BE IN ACCORDANCE WITH ASTM C 478 (AASHTO M 199) & ASTM C 890 UNLESS OTHERWISE SHOWN ON PLANS OR NOTED IN THE STANDARD SPECIFICATIONS. AS AN ACCEPTABLE ALTERNATE TO REBAR, WELDED WIRE FABRIC HAVING A MINIMUM AREA OF 0.12 SQUARE INCHES PER FOOT MAY BE USED. WELDED WIRE FABRIC SHALL COMPLY TO ASTM A 497 (AASHTO M 221). WIRE FABRIC SHALL NOT BE PLACED IN THE KNOCKOUTS.
  2. THE BOTTOM OF THE PRE CAST BASE MAY BE ROUNDED.
  3. PRE CAST BASES SHALL BE FURNISHED W/ CUTOUTS OR KNOCKOUTS. KNOCKOUTS SHALL HAVE A WALL THICKNESS OF 2" MINIMUM. KNOCKOUTS MAY BE ON ALL 4 SIDES W/ MAXIMUM DIAMETER OF 20". KNOCKOUTS MAY BE EITHER ROUND OR "D" SHAPE. PIPE TO BE INSTALLED IN FACTORY SUPPLIED KNOCKOUTS. KNOCKOUT OR CUTOUT HOLE SIZE IS EQUAL TO PIPE OUTER DIAMETER PLUS CATCH BASIN WALL THICKNESS.
  4. THE MAXIMUM DEPTH FROM THE FINISHED GRADE TO THE PIPE INVERT IS 5'-0".
  5. THE TAPER ON THE SIDES OF THE PRE CAST BASE SECTION & RISER SECTION SHALL NOT EXCEED 1/2" PER FT.
  6. CATCH BASIN FRAME & GRATE SHALL BE IN ACCORDANCE W/ STANDARD SPECIFICATIONS & MEET THE STRENGTH REQUIREMENTS OF FEDERAL SPECIFICATION RR-F-621D. MATING SURFACES SHALL BE FINISHED TO ASSURE NON-ROCKING FIT. FRAME & GRATE SHALL BE INSTALLED W/ FLANGE DOWN, CATCH BASIN FRAME AND GRATES SHALL BE 18"x24" VANED UNLESS OTHERWISE SHOWN OR INDICATED.

5 CATCH BASIN TYPE 1  
NTS

SCHEDULE C - ARTERIAL WATER SERVICE TABLE										
LAST NAME	ADDRESS	LONG/SHORT	YEAR OF HOUSE	METER SIZE	METER NUMBER	WATERMAIN SIZE AND MATERIAL	LENGTH OF SERVICE LINE TRENCH	LENGTH OF SERVICE LINE IN PAVEMENT	PAIR SERVICES (Y/N)	COMMENTS
KESAPRADIST	5440 EMW	LONG	1967	1"	73682850	10" CI	43'	36'	NO	30' OF WATER SERVICE IN ASPHALT 10' IN CONCRETE. METER IS 6' BEHIND MAILBOX. SHOULD BE HOLE HOGGED.
TARDIF	5466 EMW	LONG	1952	5/8"	40202669	10" CI	31'	27'	NO	
GAMRATH	5700 EMW	LONG	1955	5/8"	35466704	10" CI	29'	23'	NO	WATER METER IS BEHIND A SMALL BRICK PILLAR, FOR ADDRESS 5660. MOVE SERVICE FOR 5700 5' TO THE SW
ROGOVY	5816 EMW	LONG	1958	5/8"	33711924	10" CI	30'	24'	NO	
HULST, JONAH	6130 EMW	LONG	1968	3/4"	42967714	10" CI	25'	21'	NO	
AIRIS	6416 EMW	LONG	1969	3/4"	47406488	10" CI	30'	22'	NO	
WELCH	6420 EMW	LONG	1926	5/8"	42967702	10" CI	29'	21'	NO	WATER METER IS OFF THE EDGE OF EMW DOWN AN EMBANKMENT

SCHEDULE D - RESIDENTIAL WATER SERVICE TABLE										
LAST NAME	ADDRESS	LONG/SHORT	YEAR OF HOUSE	METER SIZE	METER NUMBER	WATERMAIN SIZE AND MATERIAL	LENGTH OF SERVICE LINE TRENCH	LENGTH OF SERVICE LINE IN PAVEMENT	PAIR SERVICES (Y/N)	COMMENTS
OLSON	6201 82ND AVE	LONG	1966	5/8"	33712651	6" CI	29'	25'	YES, BUT ONE ALREADY CHANGED TO COPPER	
CARTWRIGHT	8204 SE 62 ST	LONG	1966	5/8"	63186838	6" CI	21'	20'	YES, BUT ONE ALREADY CHANGED TO COPPER	METER NUMBER IS DIFFERENT THAN FIELD PIC. UTILITY BILLING HAS 61386838
LEUNG	8319 SE 62 ST	LONG	1967	5/8"	36925484	6" CI	37'	33'	YES	BEHIND SMALL BUSH
BURR	8331 SE 62 ST	LONG	1967	5/8"	36925531	6" CI	37'	33'	YES	BEHIND SMALL BUSH

WATER SERVICE TABLES



REV. NO.	DATE	DESCRIPTION

BID DOCUMENT

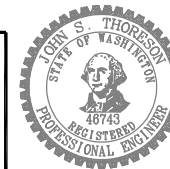

DATE	
DESIGN	4/15/21
DRAFT	JST
CHECK	JST

CITY OF MERCER ISLAND  
2021 STREET RELATED  
UTILITY IMPROVEMENTS  
STORM DETAILS

PROJECT	21-24
SCALE	NONE
SHEET	7 OF 7