

# CITY OF MERCER ISLAND

## PUBLIC WORKS DEPARTMENT

76TH AVENUE SE  
MID-BLOCK CROSSWALK  
PROJECT NO. SP121

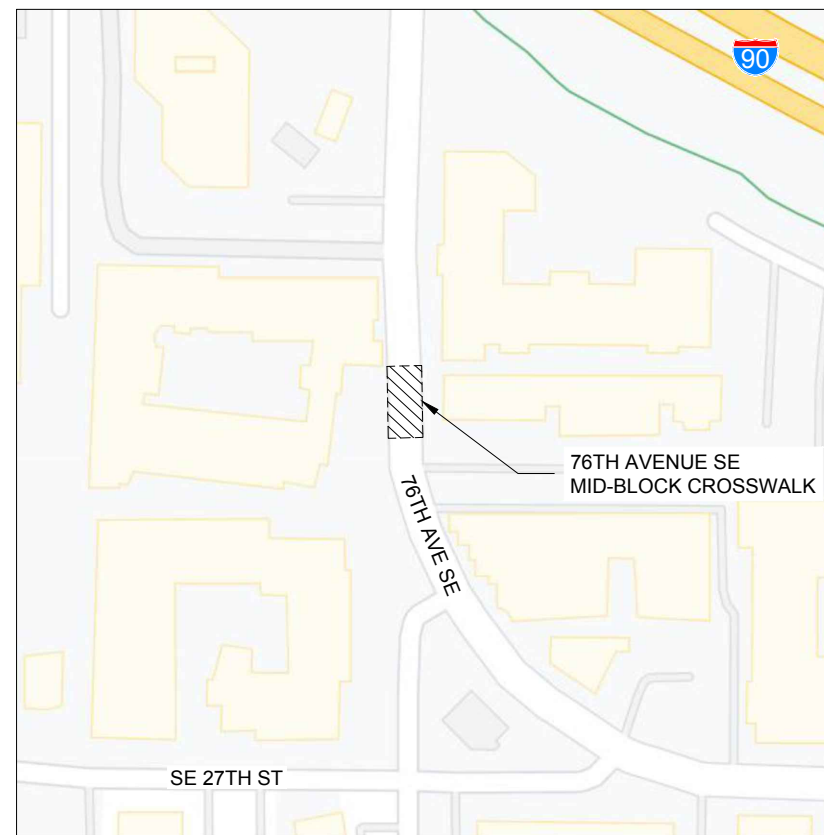
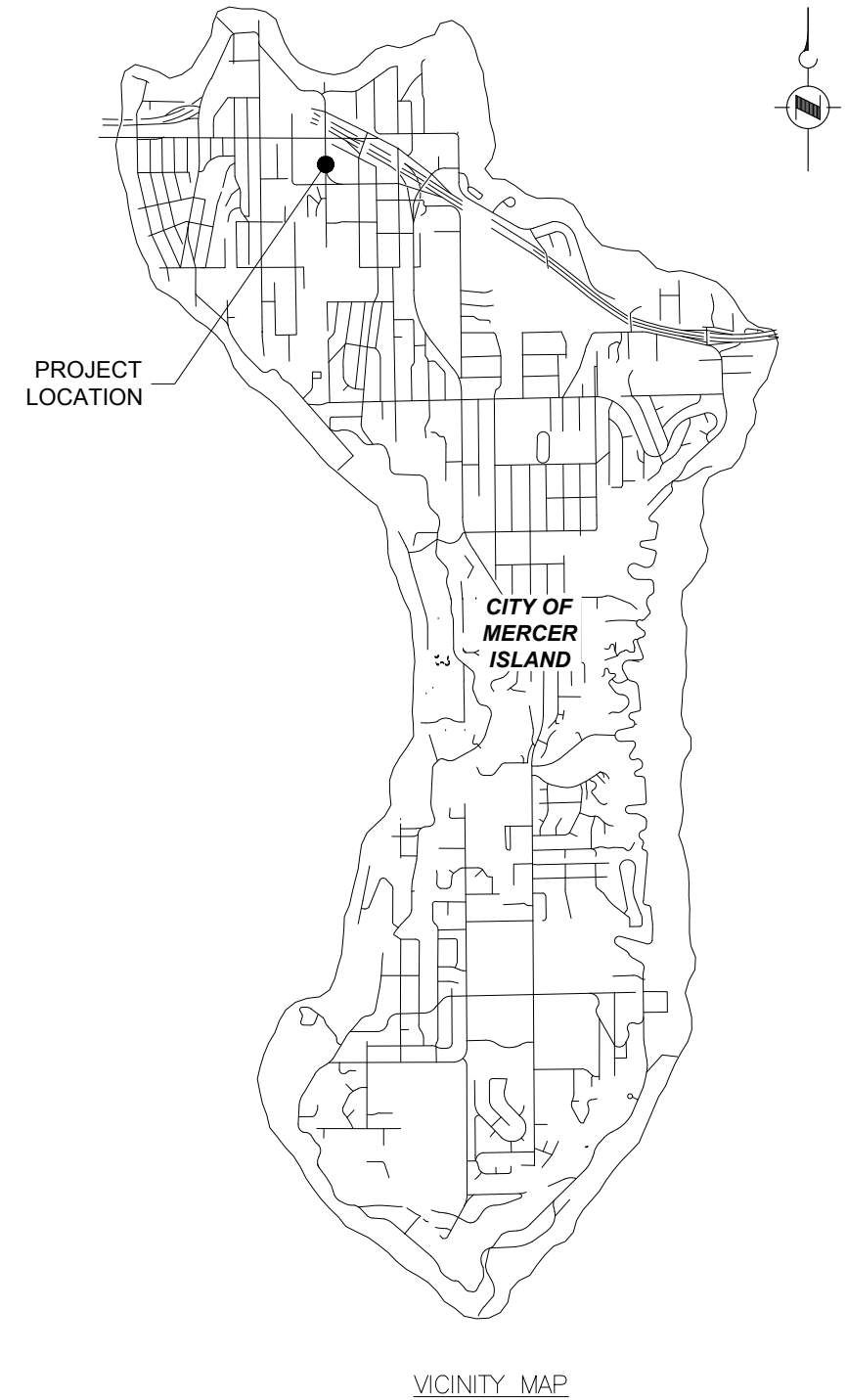

AREA MAP

VICINITY MAP

DRAWING INDEX	
Sheet No.	Drawing Title
1	COVER SHEET, VICINITY MAP, & DRAWING INDEX
2	SURVEY CONTROL
3	SITE PREPARATION AND TESC PLAN
4	ROADWAY SECTIONS AND DETAILS
5	ROADWAY AND CHANNELIZATION PLAN
6	RRFB PLAN
7	RRFB DETAILS
8 - 19	WSDOT STANDARD PLANS
20	CITY OF MERCER ISLAND STANDARD DETAILS

BID DOCUMENTS

NUMBER	REVISION DESCRIPTION	BY	APP.	DATE



SURVEYED: \_\_\_\_\_  
 DRAWN BY: HAS/RAS  
 DESIGN BY: SK  
 CHECK BY: JXL  
 PROJ MGR: RJH  
 FILE: Cover Sheet.dwg



CITY OF MERCER ISLAND  
 76TH AVENUE SE  
 MID-BLOCK CROSSWALK  
 COVER SHEET, VICINITY MAP, & DRAWING INDEX

SHEET NO. 1 OF 20  
 PROJECT NO. \_\_\_\_\_  
 FED AID NO. \_\_\_\_\_  
 DATE: 3/3/2022

\\dks-seq-001\Company\p\projects\21\21160-000 mercer island 21-40 76th ave se mid-block crosswalk\03 design\04 CAD\Civil Plans.dwg 3/7/2022 3:19 PM

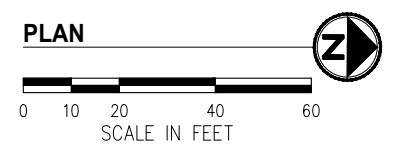
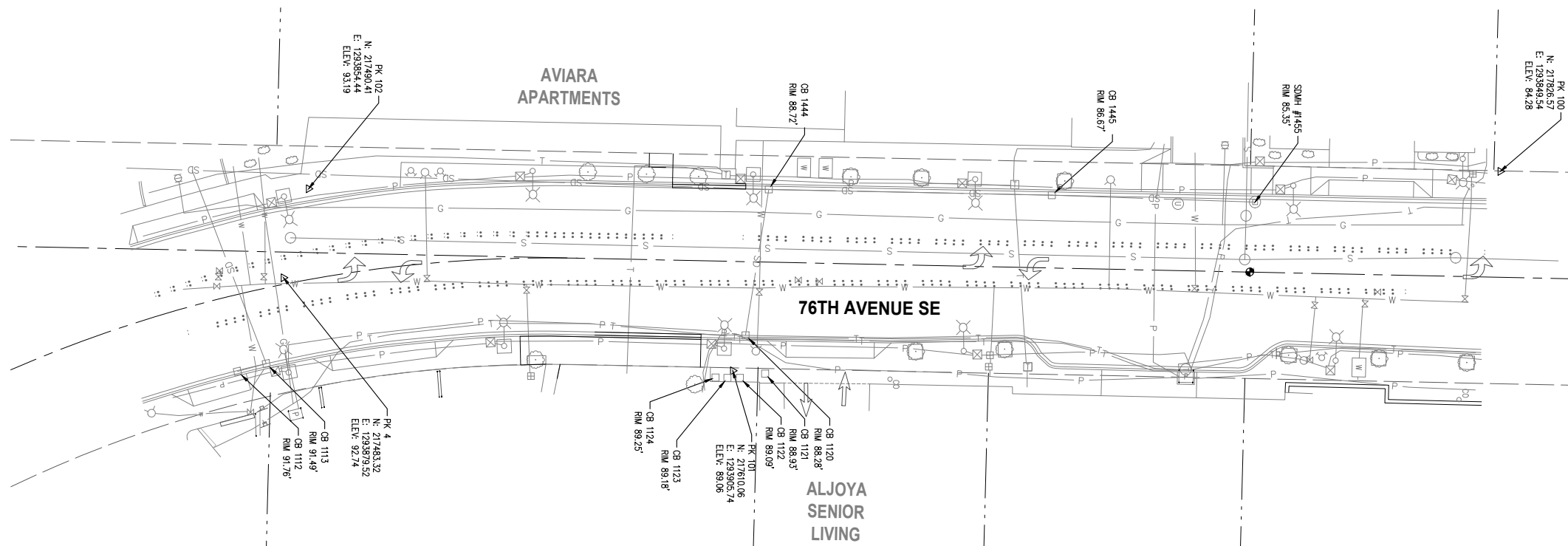

**NOTES**

1. THE PURPOSE OF THIS TOPOGRAPHIC SURVEY IS FOR CIVIL ENGINEERING DESIGN. THIS IS NOT A BOUNDARY SURVEY. SOURCES OF BOUNDARY INFORMATION AS SHOWN INCLUDE FIELD-TIED MONUMENTATION, PLATS, COUNTY RECORDS OF SURVEY, AND AUDITOR INDEXING INFORMATION.
2. THE LOCATIONS OF EXISTING UNDERGROUND UTILITY SYSTEMS, AS SHOWN HEREON, ARE TAKEN FROM UTILITY LOCATE PAINT MARKS OR AS-BUILT PLANS AND ARE SHOWN IN AN APPROXIMATE WAY ONLY.

THE CONTRACTOR SHALL DETERMINE THE EXACT LOCATION OF ALL EXISTING UTILITIES BEFORE COMMENCING WORK, AND AGREES TO BE FULLY RESPONSIBLE FOR ANY AND ALL DAMAGES WHICH MIGHT BE OCCASIONED BY THE CONTRACTOR'S FAILURE TO EXACTLY LOCATE AND PRESERVE ANY AND ALL UNDERGROUND UTILITIES. ALL LOCATOR SERVICES SHOULD BE CONTACTED PRIOR TO ANY CONSTRUCTION OR SUBSURFACE EXPLORATION. CALL 1-800-424-5555.

3. FIELD SURVEY: KPG, NOVEMBER, 2020. LICENSEE MICHAEL R. BOWEN, P.L.S. NO. 29294/RONALD D. REICHEL, P.L.S. NO. 38015.
4. CONTOUR INTERVAL = 1 FOOT, ±0.5 FOOT PER NATIONAL MAPPING STANDARDS. CONTOURS DERIVED FROM DIRECT FIELD OBSERVATIONS.
5. STORM AND SEWER CONNECTIONS HAVE BEEN DRAWN FROM CENTER OF LID TO CENTER OF LID.
6. THE LOCATIONS AND DIMENSIONS OF UNDERGROUND VAULTS HAVE NOT BEEN VERIFIED AND ARE APPROXIMATE.

**HORIZONTAL DATUM**

WASHINGTON STATE PLANE COORDINATE SYSTEM, NORTH ZONE, NAD 83/91.

**VERTICAL DATUM**

NAVD 88

CONTROL POINT LIST				
PT #	DESCRIPTION	NORTHING	EASTING	ELEVATION
4	PK	217483.32	1293879.52	92.74'
100	PK	217826.57	1293849.54	84.28'
101	PK	217610.06	1293905.74	89.06'
102	SPIKE	217490.41	1293854.44	93.19'

**BID DOCUMENTS**

NUMBER	REVISION DESCRIPTION	BY	APP.	DATE

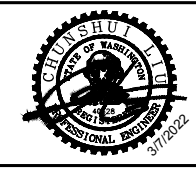

SURVEYED: \_\_\_\_\_  
 DRAWN BY: HAS/RAS  
 DESIGN BY: SK  
 CHECK BY: JXL  
 PROJ MGR: RJH  
 FILE: Civil Plans.dwg



**CITY OF MERCER ISLAND**  
 76TH AVENUE SE  
 MID-BLOCK CROSSWALK  
 SURVEY CONTROL

SHEET NO. 2 OF 20  
 PROJECT NO. \_\_\_\_\_  
 FED AID NO. \_\_\_\_\_  
 DATE: 3/3/2022

\\dks-seq-001\Company\p\projects\21\21160-000 mercer island 21-40 76th ave se mid-block crosswalk\03 design\04 CAD\Civil Plans.dwg 3/7/2022 3:19 PM

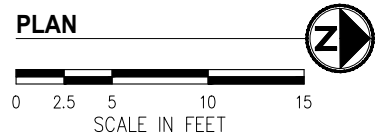
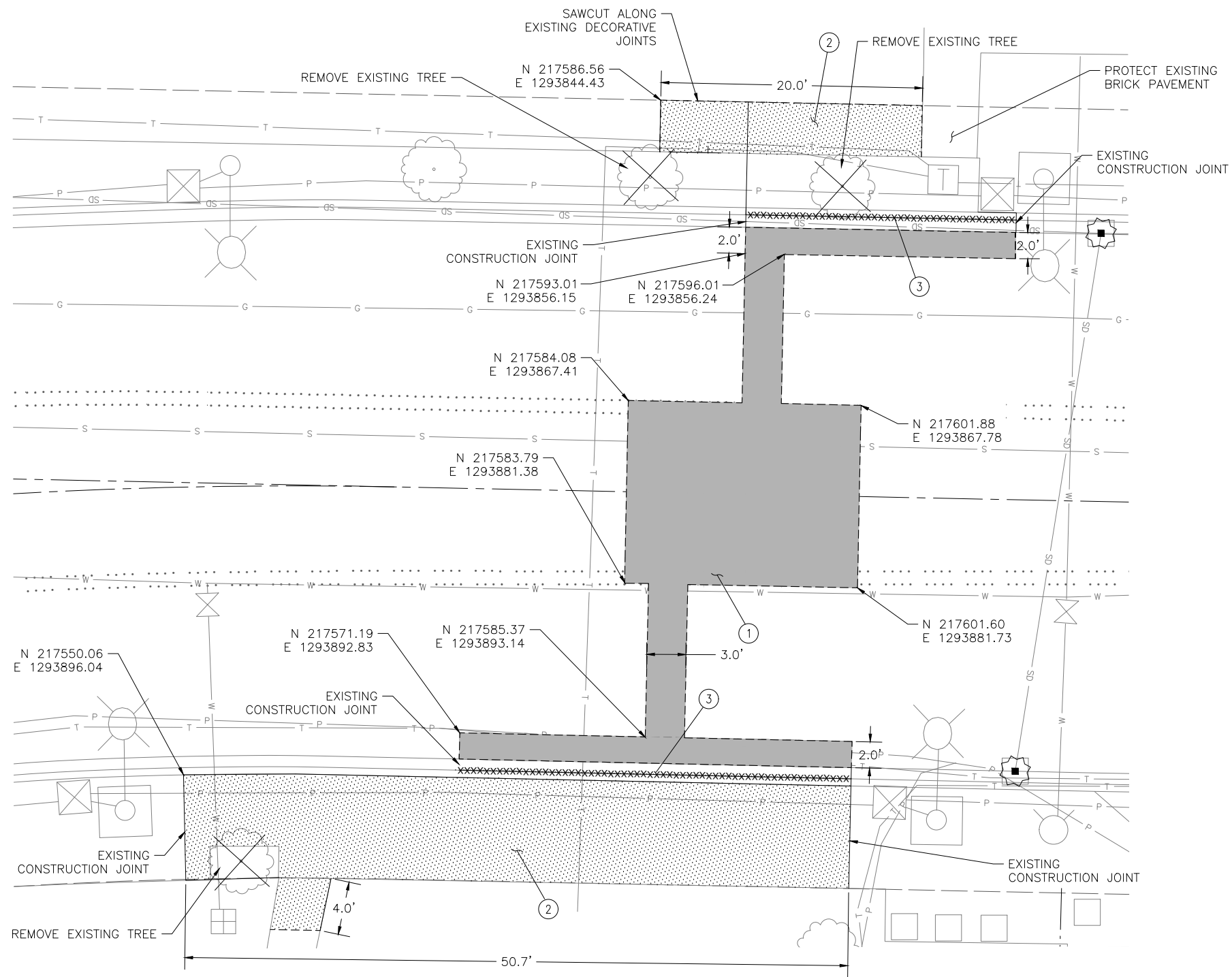

**GENERAL SITE PREPARATION & TESC NOTES**

1. THIS PLAN HAS BEEN PREPARED FOR THE CONTRACTOR'S CONVENIENCE IN LOCATING, PROTECTING, AND AVOIDING CONFLICTS WITH EXISTING UTILITIES. IT IS BASED UPON BEST AVAILABLE INFORMATION AND IS NOT NECESSARILY ACCURATE OR COMPLETE.
2. REMOVAL LIMITS SHOWN ON PLANS ARE APPROXIMATE.
3. CATCH BASIN INSERTS SHALL BE PLACED IN ALL EXISTING CATCH BASINS WITHIN THE CONSTRUCTION LIMITS AT THE TIME OF INSTALLATION. INSERTS MUST BE TRIMMED TO WITHIN 2 INCHES OF THE GRATE. CONTRACTOR SHALL CLEAN INSERTS THROUGHOUT THE PROJECT. CONTRACTOR SHALL REMOVE INSERTS WHEN THE PROJECT IS COMPLETED.
4. REMOVAL SHALL BE SEQUENCED WITH CONSTRUCTION TO MINIMIZE TRAFFIC IMPACTS AND IMPACTS TO ADJACENT PARCELS.
5. PRESERVE AND PROTECT ALL ABOVE AND BELOW GRADE IMPROVEMENTS THAT ARE TO REMAIN IN PLACE AND FACILITIES THAT ARE TO REMAIN IN PLACE UNTIL NEW FACILITIES ARE COMPLETE AND OPERATIONAL. CONTRACTOR IS RESPONSIBLE FOR DAMAGE.
6. PRESERVE AND PROTECT ALL PLANT MATERIAL OUTSIDE THE REMOVAL LIMITS.
7. MAINTAIN DRIVEWAY ACCESS TO EACH PARCEL AT ALL TIMES, UNLESS OTHERWISE APPROVED BY THE ENGINEER AND PROPERTY OWNER.
10. FOR EROSION AND SEDIMENT CONTROL STANDARD PLAN NOTES, SEE WSDOT STANDARD PLAN I-40.20-00.

**SITE PREPARATION NOTES**

- ① SAWCUT AND REMOVE ASPHALT PAVEMENT.
- ② SAWCUT AND REMOVE CONCRETE SIDEWALK.
- ③ SAWCUT AND REMOVE CONCRETE CURB AND GUTTER.

**LEGEND**

- REMOVE CONC. SIDEWALK
- REMOVE ASPHALT PAVEMENT
- FULL DEPTH SAWCUT
- CURB AND GUTTER REMOVAL
- INLET PROTECTION

**BID DOCUMENTS**

NUMBER	REVISION DESCRIPTION	BY	APP.	DATE



SURVEYED: \_\_\_\_\_  
 DRAWN BY: HAS/RAS  
 DESIGN BY: SK  
 CHECK BY: JXL  
 PROJ MGR: RJH  
 FILE: Civil Plans.dwg



**CITY OF MERCER ISLAND**  
 76TH AVENUE SE  
 MID-BLOCK CROSSWALK  
 SITE PREPARATION AND TESC PLAN

SHEET NO. 3 OF 20  
 PROJECT NO. \_\_\_\_\_  
 FED AID NO. \_\_\_\_\_  
 DATE: 3/3/2022

\\dks-seq-001\Company\p\projects\21\21160-000 mercer island 21-40 76th ave se mid-block crosswalk\03 design\04 CAD\Civil Plans.dwg 3/7/2022 3:19 PM

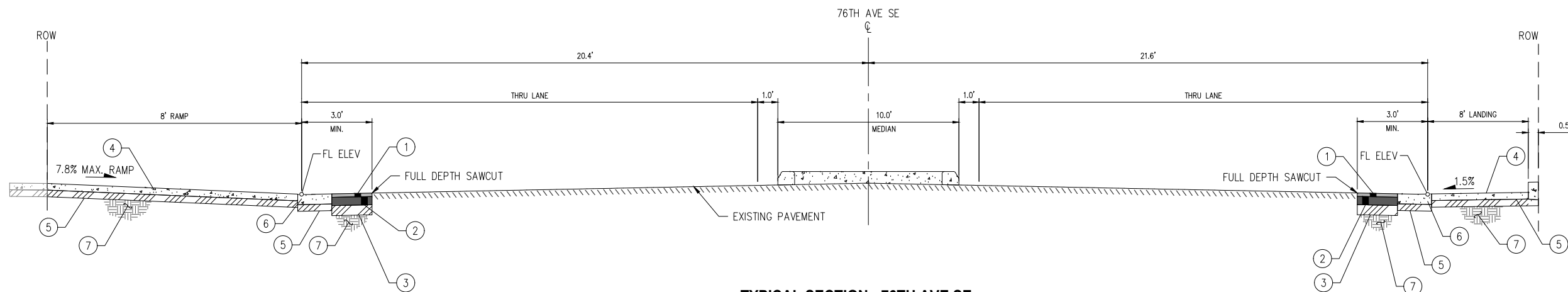

**TYPICAL SECTION - 76TH AVE SE**

LOOKING NORTH  
NTS

**TYPICAL SECTION GENERAL NOTES**

- SUBGRADE PREPARATION SHALL BE IN ACCORDANCE WITH SECTION 2-06 OF THE STANDARD SPECIFICATIONS.
- ALL CEMENT CONC. USED IN THE PROJECT SHALL BE CLASS 4000.

**MATERIAL CODE**

#	DESCRIPTION
1	2" HMA CL 1/2" PG 64-22 FOR OVERLAY
2	6" HMA CL 1/2" PG 64-22 (2 LIFTS)
3	6" CRUSHED SURFACING BASE COURSE
4	4" CEMENT CONC. SIDEWALK
5	4" CRUSHED SURFACING BASE COURSE
6	18" CEMENT CONC. TRAFFIC CURB AND GUTTER PER COMI STD PLAN 101
7	COMPACTED SUBGRADE

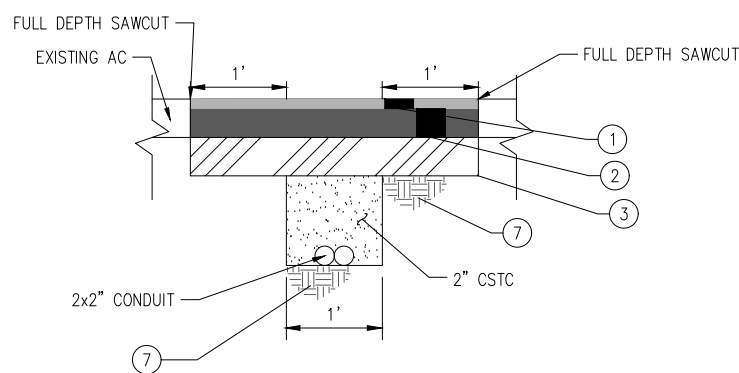

**TYPICAL CONDUIT TRENCH DETAIL**

NTS

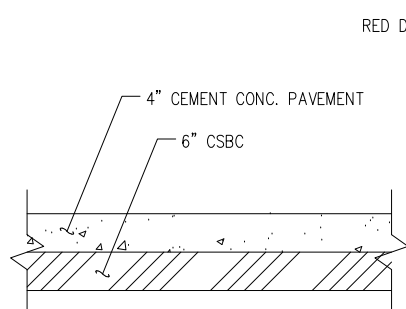

**PEDESTRIAN REFUGE ISLAND SECTION**

NTS

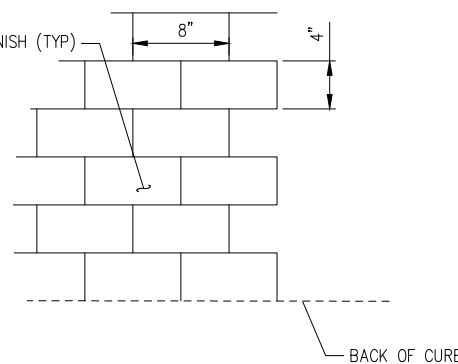

**STAMPED CONCRETE FINISH DETAIL**

NTS

**NOTES:**

- ENGINEER TO APPROVE FINAL DECORATIVE STAMPED CEMENT CONCRETE PAVEMENT LAYOUT PRIOR TO INSTALLATION.
- DECORATIVE FINISH SHALL BE CONTINUOUS.

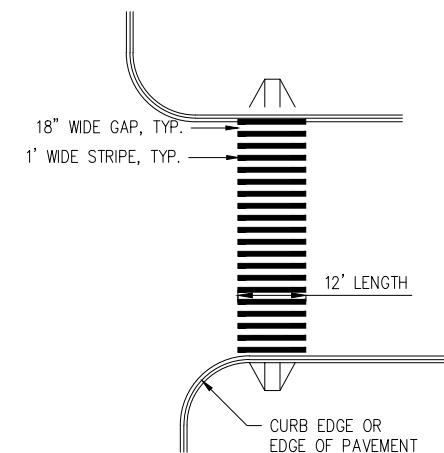

**CROSSWALK LAYOUT**

NTS

**NOTES:**

- USE WHITE THERMOPLASTIC UNLESS OTHERWISE DIRECTED BY CITY STREET ENGINEER.
- FOR USE AT SCHOOL CROSSINGS, MID-BLOCK CROSSINGS AND WHERE ARE PEDESTRIAN FACILITIES ON BOTH SIDES OF THE ROADWAY NEEDING CROSSWALK MARKINGS TO DEFINE THE WALKING ROUTE.

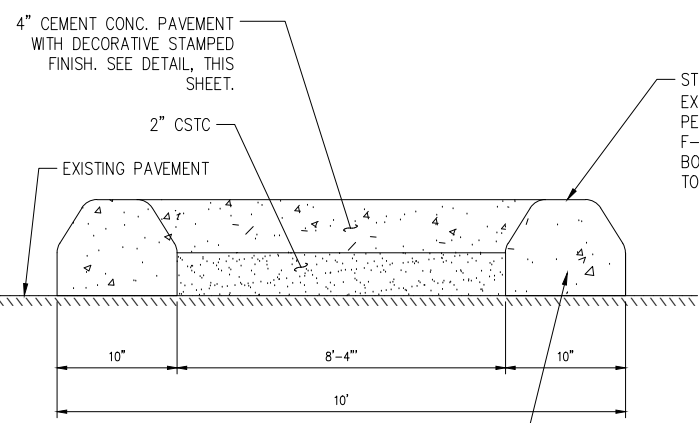

**MEDIAN DETAIL**

NTS

STANDARD CEMENT CONCRETE EXTRUDED CURB, TYPE 6 (TYP) PER WSDOT STANDARD DETAIL F-10.42-00 USING EPOXY BONDING AGENTS TO BOND CURB TO PAVEMENT

CURB SHALL BE PAINTED YELLOW WITH REFLECTIVE GLASS BEADS

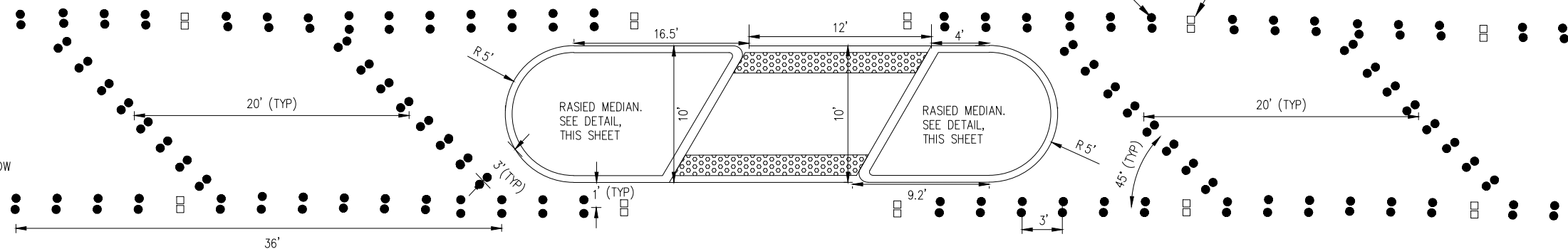

**RAISED AND STRIPED MEDIAN DETAIL**

NTS

**BID DOCUMENTS**

NUMBER	REVISION DESCRIPTION	BY	APP.	DATE



SURVEYED: \_\_\_\_\_  
 DRAWN BY: HAS/RAS  
 DESIGN BY: SK  
 CHECK BY: JXL  
 PROJ MGR: RJH  
 FILE: Civil Plans.dwg



**CITY OF MERCER ISLAND**  
 76TH AVENUE SE  
 MID-BLOCK CROSSWALK  
 ROADWAY SECTIONS AND DETAILS

SHEET NO. 4 OF 20  
 PROJECT NO. \_\_\_\_\_  
 FED AID NO. \_\_\_\_\_  
 DATE: 3/3/2022

\\dks-seq-001\Company\p\projects\21160-000 mercer island 21-40 76th ave se mid-block crosswalk\03 design\04 CAD\Civil Plans.dwg 3/7/2022 3:20 PM

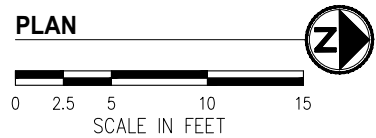
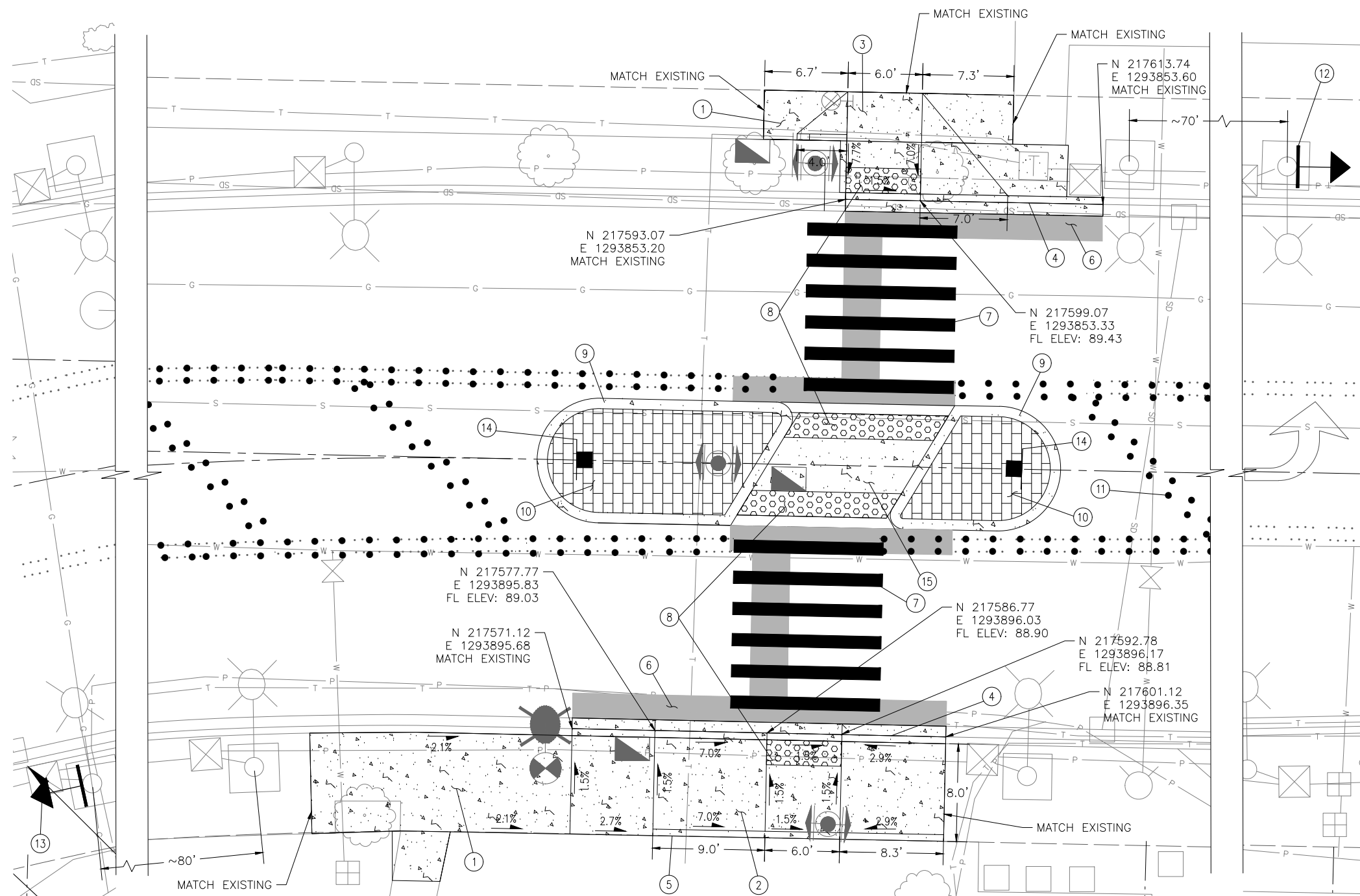

**GENERAL ROADWAY NOTES**

1. INSTALL CEMENT CONCRETE CURB, GUTTER, SIDEWALK, MEDIAN, AND HMA PER TYPICAL SECTIONS AND DETAILS, SHEET 4.
2. ALL CEMENT CONC USED FOR PAVEMENT, SIDEWALKS, AND CURB AND GUTTER SHALL BE CLASS 4000.
3. FOR REMOVAL LIMITS AND TEMPORARY EROSION AND SEDIMENT CONTROL MEASURES, SEE SITE PREPARATION & TESC PLAN, SHEET 3.

**ROADWAY CONSTRUCTION NOTES**

- ① CONSTRUCT CEMENT CONC. SIDEWALK. SEE TYPICAL SECTION ON SHEET 4.
- ② CONSTRUCT CEMENT CONCRETE CURB RAMP TYPE PARALLEL. SEE WSDOT STD PLAN F-40.12-03.
- ③ CONSTRUCT CEMENT CONCRETE CURB RAMP TYPE PERPENDICULAR. SEE WSDOT STD PLAN F-40.15-04.
- ④ CONSTRUCT CEMENT CONC. CURB AND GUTTER PER COMI STD DETAIL ST-14.
- ⑤ CONSTRUCT CEMENT CONC. PEDESTRIAN CURB PER WSDOT STD PLAN F-10.12-04.
- ⑥ INSTALL HMA CL 1/2" PG58H-22 FOR NEW PAVEMENT. SEE TYPICAL SECTIONS ON SHEET 4.
- ⑦ INSTALL THERMOPLASTIC CROSSWALK PER DETAIL ON SHEET 4.
- ⑧ INSTALL DETECTABLE WARNING SURFACE PER WSDOT STD PLAN F-45.10-03.
- ⑨ INSTALL TYPE 6 CEMENT EXTRUDED CURB PER WSDOT STD PLAN F-10.42-00 AND DETAILS ON SHEET 4.
- ⑩ INSTALL STAMPED AND COLORED CEMENT CONCRETE FOR CENTER MEDIAN. SEE DETAIL ON SHEET 4.
- ⑪ INSTALL RAISED PAVEMENT MARKER AROUND CENTER MEDIAN ISLAND PER DETAILS ON SHEET 4.
- ⑫ INSTALL W11-2 AND W16-9P ON EXISTING LIGHT POLE ABOUT 80FT NORTH OF CROSSWALK. SEE SIGN DETAIL ON SHEET 7.
- ⑬ INSTALL W11-2 AND W16-9P ON EXISTING LIGHT POLE ABOUT 100FT SOUTH OF CROSSWALK. SEE SIGN DETAIL ON SHEET 7.
- ⑭ INSTALL R4-7 OR R4-8 SIGN AND SIGN POST PER SIGN POST INSTALLATION DETAIL ON SHEET 7
- ⑮ INSTALL CEMENT PEDESTRIAN REFUGE ISLAND. SEE TYPICAL SECTION ON SHEET 4.

**LEGEND**

- CONCRETE SIDEWALK
- NEW ASPHALT PAVEMENT
- DETECTABLE WARNING SURFACE
- STAMPED AND COLORED CEMENT CONCRETE
- SIGN POST WITH SIGN
- SIGN ON EXISTING LIGHT POLE

**BID DOCUMENTS**

NUMBER	REVISION DESCRIPTION	BY	APP.	DATE



SURVEYED: \_\_\_\_\_  
 DRAWN BY: HAS/RAS  
 DESIGN BY: SK  
 CHECK BY: JXL  
 PROJ MGR: RJH  
 FILE: Civil Plans.dwg



**CITY OF MERCER ISLAND**  
 76TH AVENUE SE  
 MID-BLOCK CROSSWALK  
 ROADWAY AND CHANNELIZATION PLAN

SHEET NO. 5 OF 20  
 PROJECT NO. \_\_\_\_\_  
 FED AID NO. \_\_\_\_\_  
 DATE: 3/3/2022

\\dks-seq-001\Company\p\projects\21\21160-000 mercer island 21-40 76th ave se mid-block crosswalk\03 design\04 CAD\RRFB Plans.dwg 3/7/2022 3:21 PM

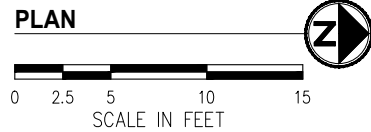
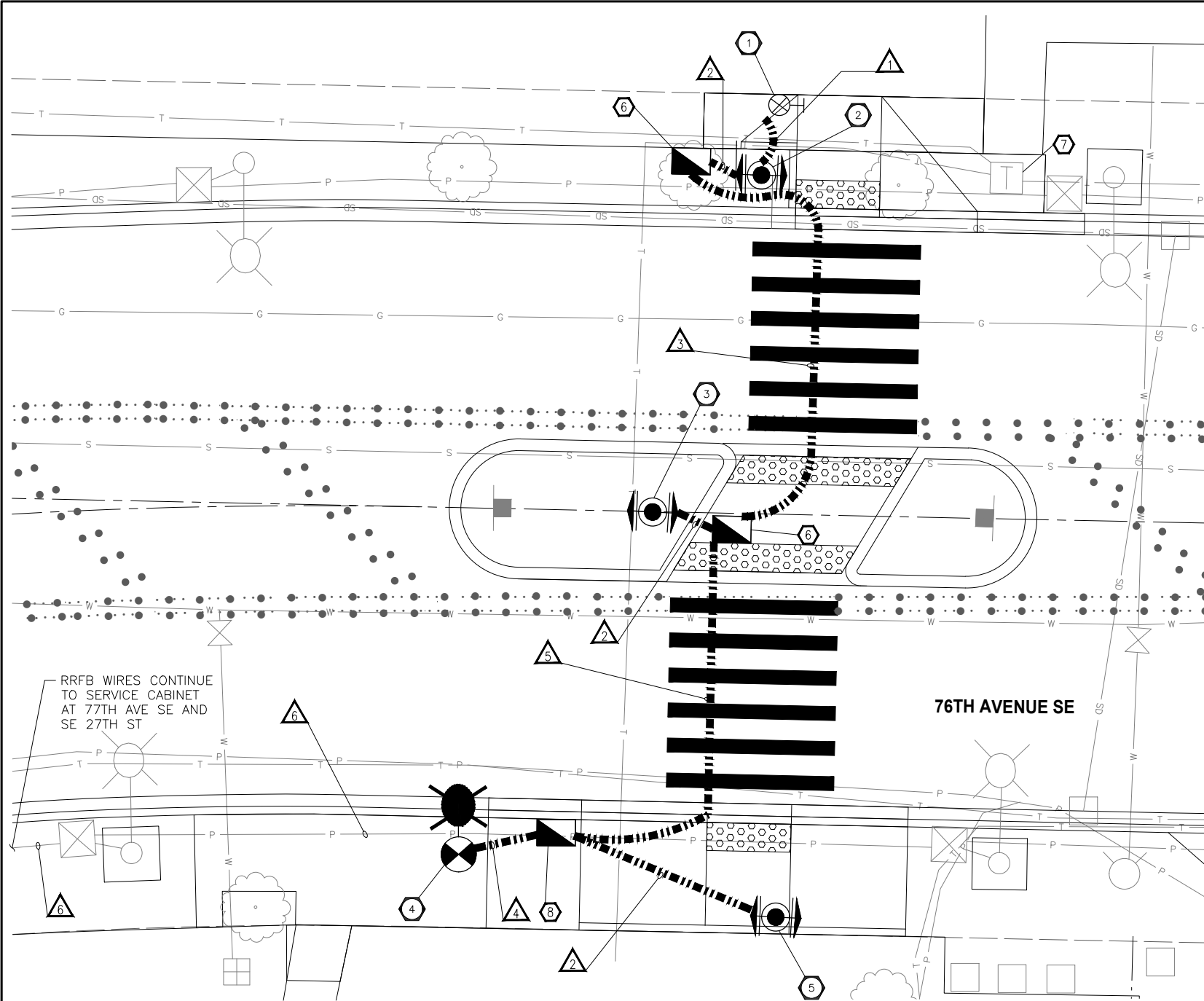

**WIRING SCHEDULE**

RUN NO #	CONDUIT SIZE	CONDUCTORS	PPB (2CS)	RRFB (#8)	POWER	NOTES
1	1"		1			
2	2"			2	2	
3	2"			2	2	
4	2"			4	2	
5	2"			2	2	
6	EX 2"	EX		2		EX ILLUMINATION

**SIGNAL PLAN LEGEND**

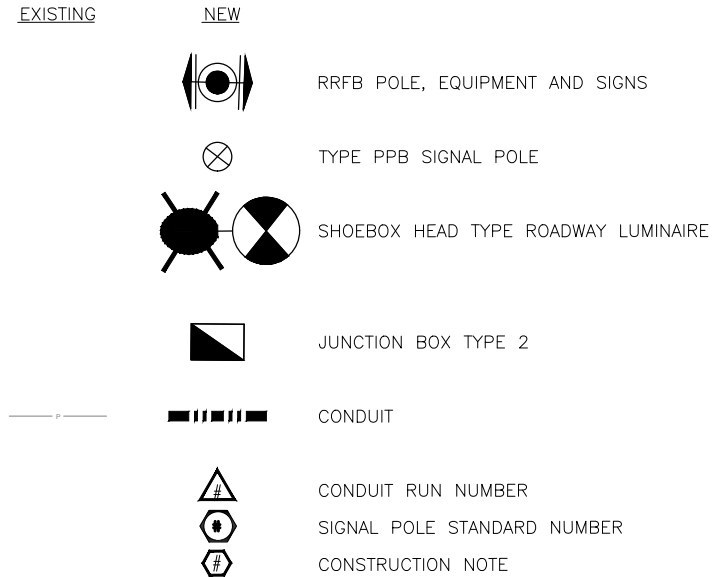

**CONSTRUCTION NOTES:**

- ① CONSTRUCT FOUNDATION AND INSTALL TYPE PPB SIGNAL POLE PER WSDOT STD PLAN J-20.10-04
- ② CONSTRUCT FOUNDATION PER WSDOT STD PLAN J-21.10-04, EXCEPT BOLT SPACING SHALL BE PER BOLT CIRCLE TEMPLE DETAIL. FURNISH AND INSTALL ONE AC POWERED RRFB ASSEMBLY INCLUDING ONE RRFB POLE, ONE CONTROL CABINET, TWO RRFB'S (BI-DIRECTIONAL, WITH SIDE EMITTING PEDESTRIAN CONFIRMATION LIGHTS), AND SIGNS PER RRFB ASSEMBLY DETAIL.
- ③ CONSTRUCT FOUNDATION PER WSDOT STD PLAN J-21.10-04, EXCEPT BOLT SPACING SHALL BE PER BOLT CIRCLE TEMPLE DETAIL. FURNISH AND INSTALL ONE AC POWERED RRFB ASSEMBLY INCLUDING ONE RRFB POLE, ONE CONTROL CABINET, TWO RRFB'S (BI-DIRECTIONAL, WITH SIDE EMITTING PEDESTRIAN CONFIRMATION LIGHTS), AND SIGNS PER RRFB ASSEMBLY DETAIL.
- ④ CONSTRUCT FOUNDATION AND INSTALL CONCRETE POLE PER MERCER ISLAND STANDARD PLAN IL-1B.
- ⑤ CONSTRUCT FOUNDATION PER WSDOT STD PLAN J-21.10-04, EXCEPT BOLT SPACING SHALL BE PER BOLT CIRCLE TEMPLE DETAIL. FURNISH AND INSTALL ONE AC POWERED RRFB ASSEMBLY INCLUDING ONE RRFB POLE, ONE CONTROL CABINET, TWO RRFB'S (BI-DIRECTIONAL, WITH SIDE EMITTING PEDESTRIAN CONFIRMATION LIGHTS), PEDESTRIAN PUSH BUTTON, AND SIGNS PER RRFB ASSEMBLY DETAIL.
- ⑥ INSTALL JUNCTION BOX WITH NON-SKID LID AND FRAME.
- ⑦ ADJUST EXISTING JUNCTION TO MATCH WITH NEW GRADE. PROTECT EXISTING CONDUIT AND WIRING DURING CONSTRUCTION.
- ⑧ FIELD LOCATE AND INTERCEPT EXISTING CONDUIT AND WIRING. INSTALL JUNCTION BOX WITH NON-SKID LID WITH FRAME. SPLICE IN NEW ILLUMINATION WIRES WITH EXISTING ILLUMINATION WIRING CIRCUIT. INSTALL NEW POWER WIRES FOR RRFB SYSTEM. INSTALL CONDUIT ELBOWS PER STANDARD SPECIFICATION. COORDINATE WORK IN THE FIELD WITH THE ENGINEER AND CITY MAINTENANCE REPRESENTATIVE.

**GENERAL NOTES:**

- 1. ALL WORK SHALL BE COMPLETED IN ACCORDANCE WITH WSDOT/APWA STANDARD PLANS, STANDARD SPECIFICATIONS, LATES AMENDMENTS TO THE STANDARD SPECIFICATIONS, CITY STANDARDS, SPECIAL PROVISIONS AND THESE PLANS.
- 2. UTILITIES LOCATION (DIAL-A-DIG) PRIOR TO CONSTRUCTION SHALL BE RESPONSIBILITY OF THE CONTRACTOR. CONFLICTS SHALL BE BROUGHT TO THE ATTENTION OF THE ENGINEER FOR RESOLUTION.
- 3. THE LOCATION OF ALL FEATURES TO BE INSTALLED BY THE CONTRACTOR ARE FOR GRAPHICAL PRESENTATION ONLY. FINAL LOCATIONS SHALL BE VERIFIED BY THE ENGINEER IN THE FIELD PRIOR TO INSTALLATION.
- 4. ALL NEW FOUNDATION LOCATIONS SHALL BE APPROVED BY THE ENGINEER PRIOR TO EXCAVATION.
- 5. ALL NEW JUNCTION BOXES PLACED IN THE SIDEWALKS SHALL HAVE SKID RESISTANT LIDS AND FRAMES.
- 6. ALL NEW CONDUIT SHALL BE INSTALLED IN THE CITY RIGHT-OF-WAY.
- 7. FOR COORDINATION WITH THE CITY MAINTENANCE REPRESENTATIVE, CONTRACTOR SHALL CONTACT BRIAN HARTVIGON 206-275-7809.
- 8. NUMBER OF CONDUIT BENDS BETWEEN PULL POINTS SHALL NOT BE MORE THAN THE EQUIVALENT OF FOUR QUARTER BENDS (360 DEGREES TOTAL). IF NUMBER OF BENDS EXCEEDS LISTED REQUIREMENTS, THE CONTRACTOR SHALL INSTALL ADDITIONAL JUNCTION BOXES, AS DIRECTED BY THE ENGINEER.

**POLE SCHEDULE**

#	NORTHING	EASTING	PPB EXTENSION	FOUNDATION	REMARKS
1	217591.91	1293845.29	90 Degrees	J-21.10	
2	217590.64	1293850.31	N/A	J-21.10	*
3	217582.86	1293874.39	N/A	J-21.10	*
4	217568.99	1293898.86	N/A	IL-1B	
5	217591.66	1293903.35	N/A	J-21.10	*

\* ANCHOR BOLT SPACING SHALL BE PER BOLT CIRCLE TEMPLATE DETAIL SHEET 7

**NOTE:**

- 1. GROUND WIRING IS NOT SHOWN. ALL NEW AND MODIFIED PVC CONDUITS, CONTAINING CONDUCTORS, SHALL CONTAIN GROUND WIRE. WIRE SIZE SHALL MATCH THE LARGEST CONDUCTOR (MIN #8 AWG UNLESSWISE NOTES IN THE WIRE NOTES).
- 2. ALL NEW CONDUITS SHALL BE RIGID PVC SCH 80.
- 3. ALL EXISTING CONDUITS, WIRING AND CIRCUIT VOLTAGE SHALL BE VERIFIED IN THE PRESENCE OF THE ENGINEER IN THE FIELD, PRIOR TO CONSTRUCTION.

**BID DOCUMENTS**

NUMBER	REVISION DESCRIPTION	BY	APP.	DATE



SURVEYED: \_\_\_\_\_  
 DRAWN BY: HAS/RAS  
 DESIGN BY: SK  
 CHECK BY: JXL  
 PROJ MGR: RJH  
 FILE: RRFB Plans.dwg



**CITY OF MERCER ISLAND**  
 76TH AVENUE SE  
 MID-BLOCK CROSSWALK  
 RRFB PLAN

SHEET NO. 6 OF 20  
 PROJECT NO. \_\_\_\_\_  
 FED AID NO. \_\_\_\_\_  
 DATE: 3/3/2022

\\dks-seq-001\Company\p\projects\21\21160-000 mercer island 21-40 76th ave se mid-block crosswalk\03 design\04 CAD\RRFB Plans.dwg 3/7/2022 3:22 PM

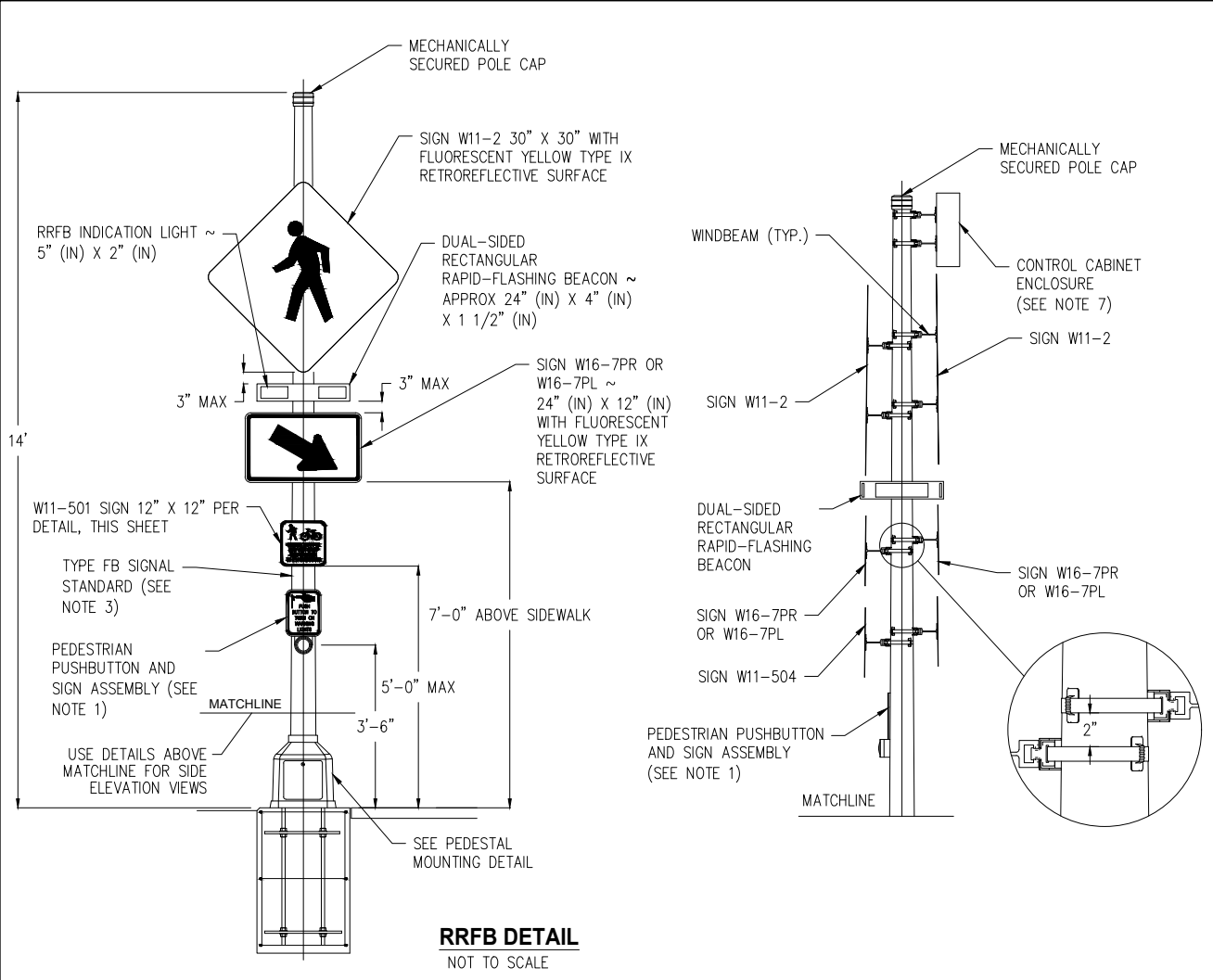

**GENERAL NOTES**

1. PEDESTRIAN PUSHBUTTON AND SIGN ASSEMBLY (IF USED ON THE POLE). SEE SPECIAL PROVISIONS.
2. SEE WSDOT STANDARD PLAN J-21.10 FOR SIGNAL STANDARD FOUNDATION WITH FIXED BASE DETAIL.
3. SEE WSDOT STANDARD PLAN J-21.16 FOR SIGNAL STANDARD DETAILS NOT SHOWN.
4. SEE WSDOT STANDARD PLAN J-21.17, DETAIL C FOR WIRING DETAILS NOT SHOWN.
5. SEE WSDOT STANDARD PLAN G-30.10 FOR SIGN INSTALLATION ON SIGNAL STANDARD DETAILS.
6. TERMINATE RRFB CONNECTIONS PER MANUFACTURER'S RECOMMENDATION.
7. CONTROL CABINET ENCLOSURE SHALL BE SIZED BY THE RRFB MANUFACTURER. THE CONTROL CABINET SHALL BE MANUFACTURED PER TERMINAL CABINET REQUIREMENTS OF STANDARD SPECIFICATION SECTION 9-29.25.

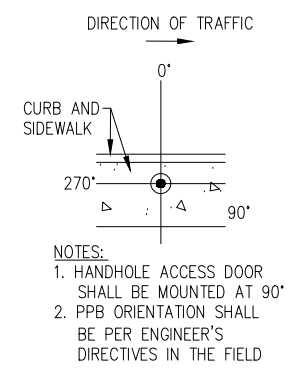

W11-2 (30"x30") SIGNS WITH FLUORESCENT YELLOW TYPE IX RETROREFLECTIVE SURFACE

W16-9P (24"x12") SIGNS WITH FLUORESCENT YELLOW TYPE IX RETROREFLECTIVE SURFACE

**SIGN CONFIGURATION**

LOCATE AHEAD OF CROSSWALK ON THE EXISTING LIGHT POLE PER SHEET 5 NTS

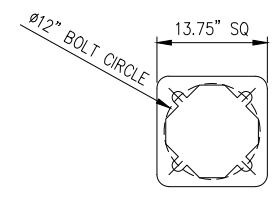

**RRFB POLE BOLT CIRCLE**  
NTS



- NOTES:
1. PEDESTRIAN SYMBOL HEIGHT SHALL BE 4"
  2. BICYCLE SYMBOL HEIGHT SHALL BE 3"
  3. LETTERS SHALL 1" C
  4. LEGEND SHALL BE BLACK
  5. BACKGROUND SHALL BE YELLOW

**W11-501 PEDESTRIAN WARNING SIGN DETAILS**  
NTS

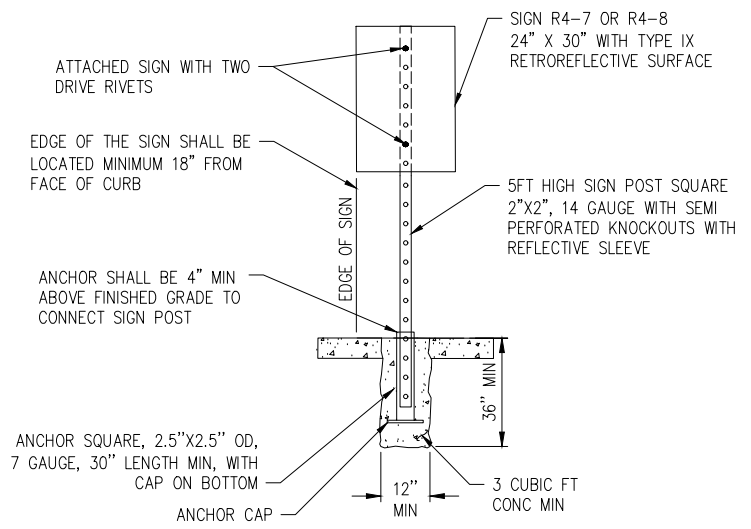

**SIGN POST INSTALLATION DETAIL**  
NTS

**BID DOCUMENTS**

NUMBER	REVISION DESCRIPTION	BY	APP.	DATE

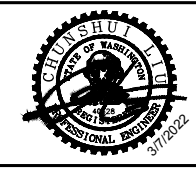

SURVEYED: \_\_\_\_\_  
 DRAWN BY: HAS/RAS  
 DESIGN BY: SK  
 CHECK BY: JXL  
 PROJ MGR: RJH  
 FILE: RRFB Plans.dwg



CITY OF MERCER ISLAND  
 76TH AVENUE SE  
 MID-BLOCK CROSSWALK  
 RRFB DETAILS

SHEET NO. 7 OF 20  
 PROJECT NO. \_\_\_\_\_  
 FED AID NO. \_\_\_\_\_  
 DATE: 3/3/2022

\\dks-seq-001\Company\p\projects\21\21160-000 mercer island 21-40 76th ave se mid-block crosswalk\03 design\04 CAD\Detail Plans.dwg 3/7/2022 3:23 PM

DRAWN BY: FERN LIDDELL

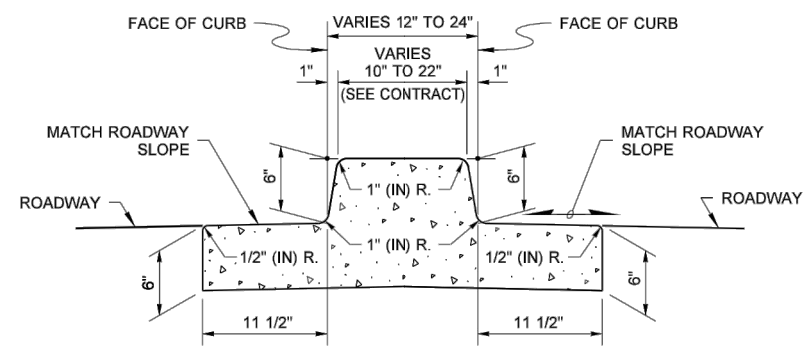

**DUAL-FACED CEMENT CONCRETE TRAFFIC CURB AND GUTTER**

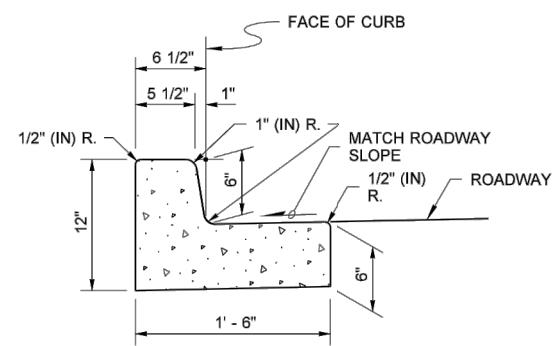

**CEMENT CONCRETE TRAFFIC CURB AND GUTTER**

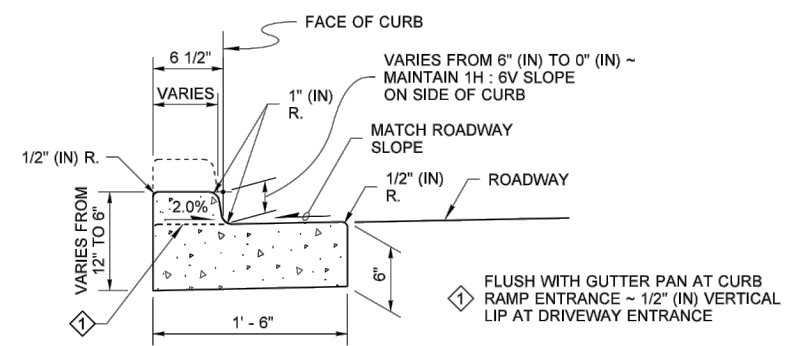

**DEPRESSED CURB AND GUTTER SECTION AT CURB RAMPS AND DRIVEWAY ENTRANCES**

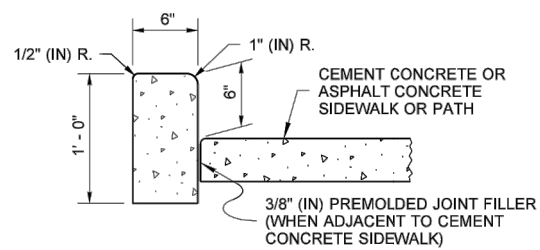

**CEMENT CONCRETE PEDESTRIAN CURB**

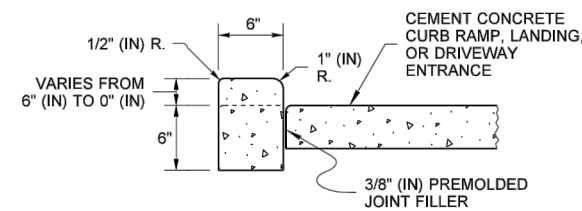

**CEMENT CONCRETE PEDESTRIAN CURB AT CURB RAMPS, LANDINGS, AND DRIVEWAY ENTRANCES**

**NOTE**

1. See **Standard Plan F-30.10** for Curb Expansion and Contraction Joint spacing. See **Standard Specification, Sections 8-04 and 9-04** for additional requirements.

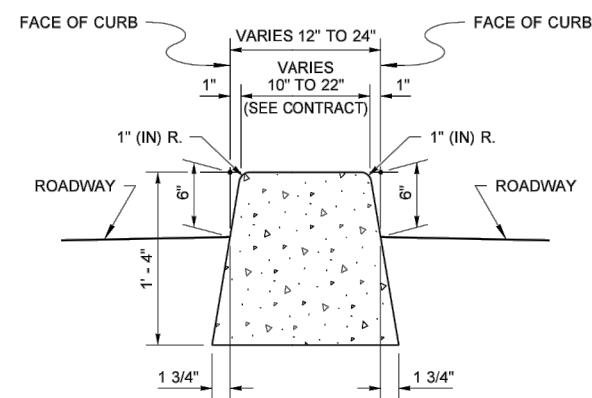

**DUAL-FACED CEMENT CONCRETE TRAFFIC CURB**

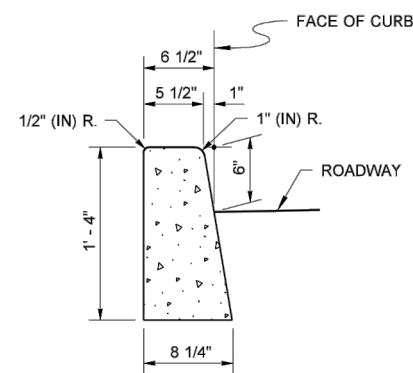

**CEMENT CONCRETE TRAFFIC CURB**

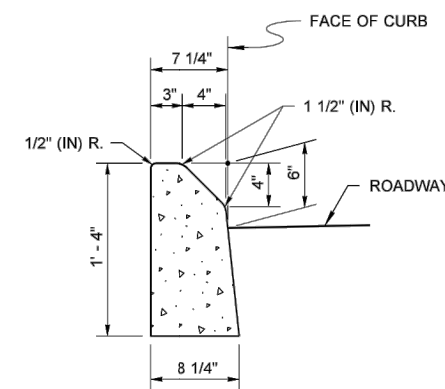

**MOUNTABLE CEMENT CONCRETE TRAFFIC CURB**



Michael S. Fleming  
 Digitally signed by Michael S. Fleming  
 Date: 2020.09.24 07:39:38 -0700  
**CEMENT CONCRETE CURBS**

**STANDARD PLAN F-10.12-04**

SHEET 1 OF 1 SHEET

APPROVED FOR PUBLICATION  
 Date: 2020.09.24  
 07:57:43 -0700  
 STATE DESIGN ENGINEER  
 Washington State Department of Transportation

**BID DOCUMENTS**

NUMBER	REVISION DESCRIPTION	BY	APP.	DATE



SURVEYED: \_\_\_\_\_  
 DRAWN BY: HAS/RAS  
 DESIGN BY: SK  
 CHECK BY: JXL  
 PROJ MGR: RJH  
 FILE: Detail Plans.dwg

**DKS**  
 719 Second Ave, Suite 1250  
 Seattle, WA 98104  
 (206) 382-9800  
 www.dksassociates.com



**CITY OF MERCER ISLAND**  
 76TH AVENUE SE  
 MID-BLOCK CROSSWALK  
 WSDOT STANDARD PLANS

SHEET NO. 8 OF 20  
 PROJECT NO. \_\_\_\_\_  
 FED AID NO. \_\_\_\_\_  
 DATE: 3/3/2022



\\dks-seq-001\Company\p\projects\21\21160-000 mercer island 21-40 76th ave se mid-block crosswalk\03 design\04 CAD\Detail Plans.dwg 3/7/2022 3:23 PM

DRAWN BY: BILL BERENS

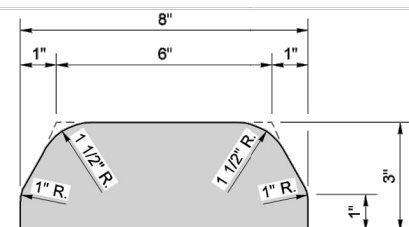

**TYPE 1**  
(HOT MIX ASPHALT)

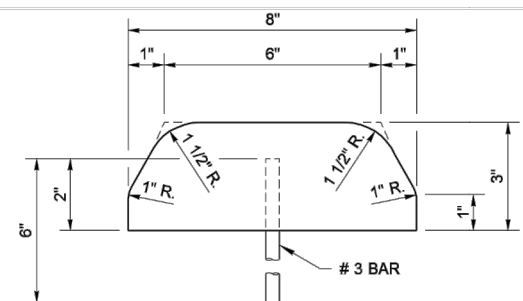

**TYPE 4**  
(CEMENT CONCRETE)

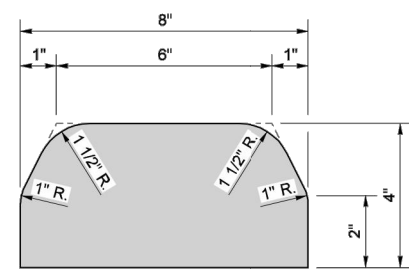

**TYPE 2**  
(HOT MIX ASPHALT)

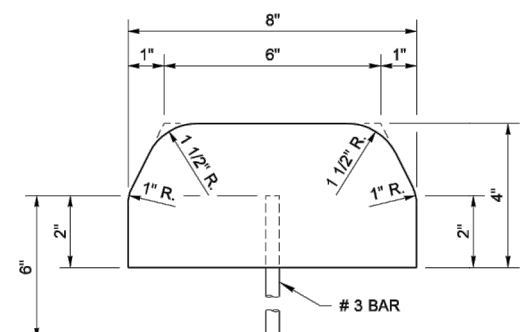

**TYPE 5**  
(CEMENT CONCRETE)

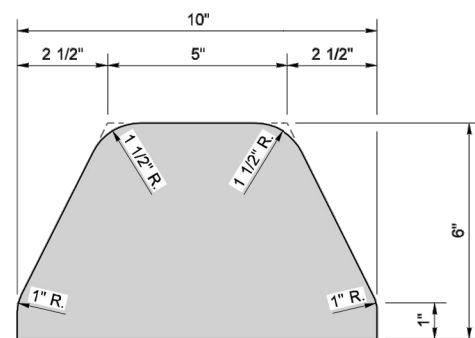

**TYPE 3**  
(HOT MIX ASPHALT)

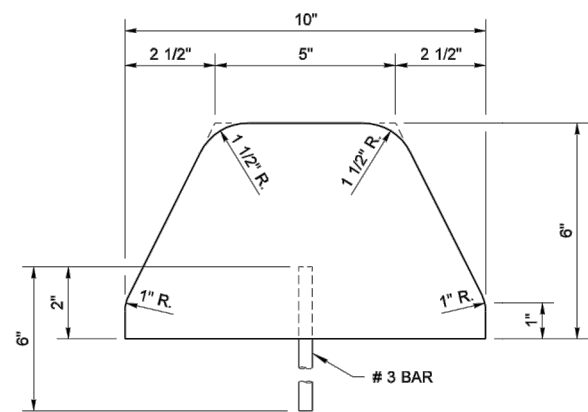

**TYPE 6**  
(CEMENT CONCRETE)

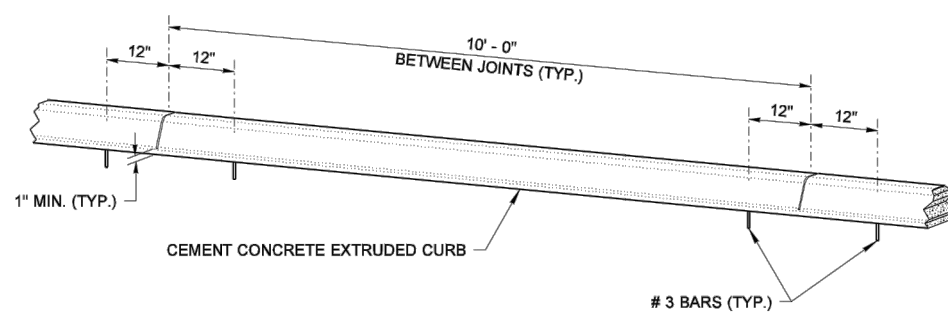

**SPACING OF ANCHOR BARS**  
(FOR TYPES 4, 5, AND 6)

**NOTE**  
JOINTS MAY BE FORMED DURING INSTALLATION USING A RIGID DIVIDER OR SAWCUT AFTER CONCRETE CURES TO MINIMUM STRENGTH.



EXPIRES AUGUST 26, 2007

NOTE: THIS PLAN IS NOT A LEGAL ENGINEERING DOCUMENT UNTIL AN ELECTRONIC DUPLICATE OF THE ORIGINAL, SIGNED BY THE ENGINEER AND APPROVED FOR PUBLICATION, IS KEPT ON FILE. A COPY MAY BE OBTAINED UPON REQUEST.

**EXTRUDED CURB**  
**STANDARD PLAN F-10.42-00**

SHEET 1 OF 1 SHEET

APPROVED FOR PUBLICATION

**Ken L. Smith** 01-23-07  
STATE DESIGN ENGINEER DATE

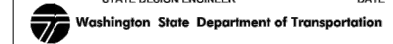

**BID DOCUMENTS**

NUMBER	REVISION DESCRIPTION	BY	APP.	DATE

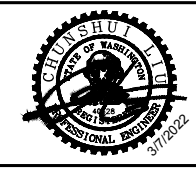

SURVEYED: \_\_\_\_\_  
DRAWN BY: HAS/RAS  
DESIGN BY: SK  
CHECK BY: JXL  
PROJ MGR: RJH  
FILE: Detail Plans.dwg



CITY OF MERCER ISLAND  
76TH AVENUE SE  
MID-BLOCK CROSSWALK  
WSDOT STANDARD PLANS

SHEET NO. 9 OF 20  
PROJECT NO. \_\_\_\_\_  
FED AID NO. \_\_\_\_\_  
DATE: 3/3/2022

\\dks-seq-001\Company\p\projects\21\21160-000 mercer island 21-40 76th ave se mid-block crosswalk\03 design\04 CAD\Detail Plans.dwg 3/7/2022 3:23 PM

DRAWN BY: FERN LIDDELL

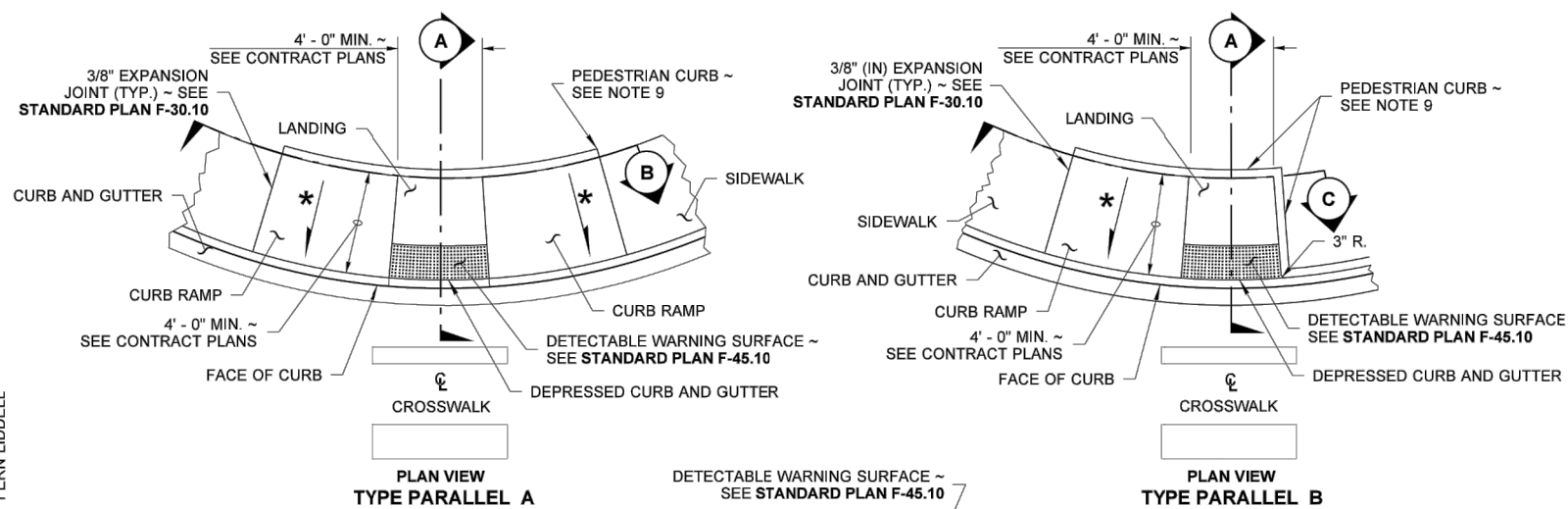

① CONTRACTION JOINT (TYP.) ~ SEE STANDARD PLAN F-30.1 FOR CURB RAMP LENGTHS GREATER THAN 8' - 0" PROVIDE CONTRACTION JOINT EQUALLY SPACED 4' - 0" MIN. OC.

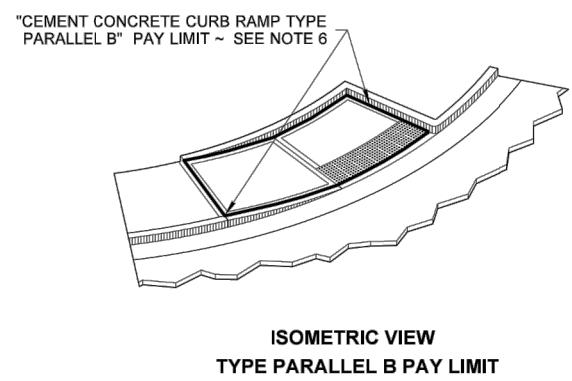
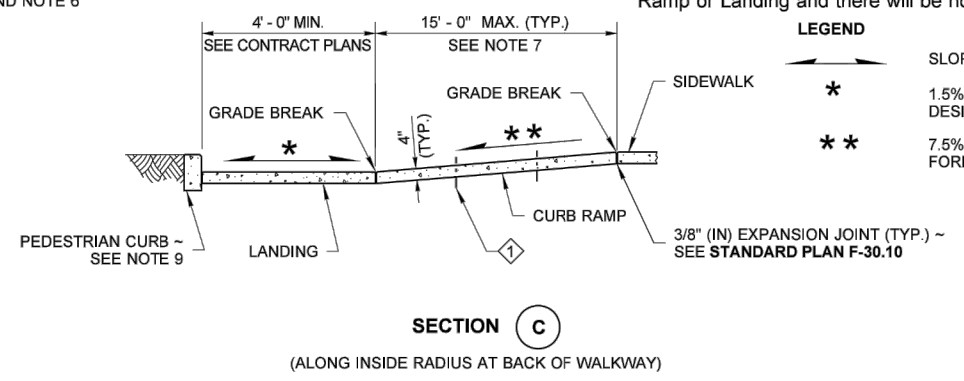
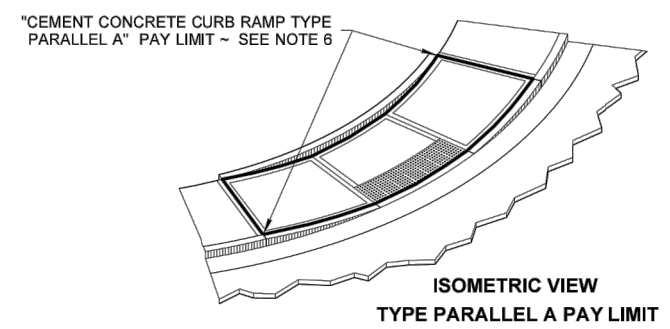
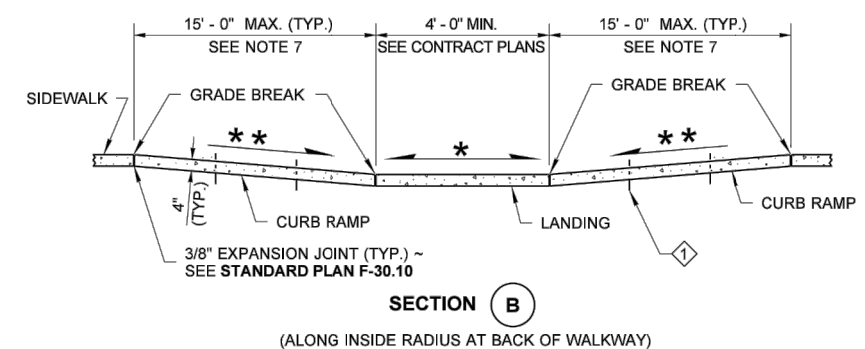
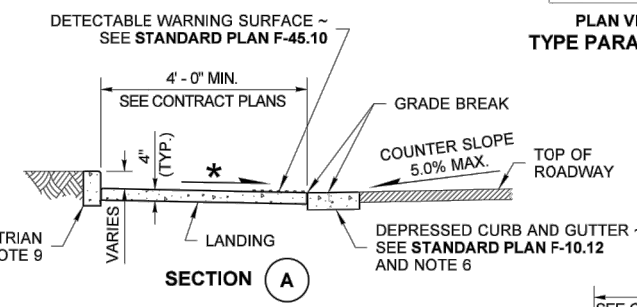

**NOTES**

- At marked crosswalks, the connection between the landing and the roadway must be contained within the width of the crosswalk markings.
- Where "GRADE BREAK" is called out, the entire length of the grade break between the two adjacent surface planes shall be flush.
- Do not place Gratings, Junction Boxes, Access Covers, or other appurtenances on any part of the Curb Ramp or Landing, or in the Depressed Curb and Gutter where the Landing connects to the roadway.
- See Contract Plans for the curb design specified. See **Standard Plan F-10.12** for Curb, Curb and Gutter, Depressed Curb and Gutter, and Pedestrian Curb details.
- See **Standard Plan F-30.10** for Cement Concrete Sidewalk Details. See Contract Plans for width and placement of sidewalk.
- The Bid Item "Cement Concrete Curb Ramp Type \_\_\_" does not include the adjacent Curb, Curb and Gutter, Depressed Curb and Gutter, Pedestrian Curb, or Sidewalks.
- The Curb Ramp length is not required to exceed 15 feet (unless otherwise shown in the Contract Plans). When applying the 15-foot max. length, the running slope of the curb ramp is allowed to exceed 8.3%. Use a single constant slope from bottom of ramp to top of ramp to match into the sidewalk over a horizontal distance of 15 feet. Do not include abutting landing(s) in the 15-foot max. measurement. When a ramp is constructed on a radius, the 15-foot max. length is measured on the inside radius along the back of the walkway.
- Curb Ramps and Landings shall receive a broom finish. See **Standard Specifications 8-14**.
- Pedestrian Curb may be omitted if the ground surface at the back of the Curb Ramp and/or Landing will be at the same elevation as the Curb Ramp or Landing and there will be no material to retain.

**LEGEND**

- SLOPE IN EITHER DIRECTION
- \* 1.5% OR FLATTER RECOMMENDED FOR DESIGN/FORMWORK (2% MAX.)
- \*\* 7.5% OR FLATTER RECOMMENDED FOR DESIGN/FORMWORK (8.3% MAX.) ~ SEE NOTE 7



Zeller, Scott  
Jun 24 2016 7:19 AM

**PARALLEL CURB RAMP**

**STANDARD PLAN F-40.12-03**

SHEET 1 OF 1 SHEET

APPROVED FOR PUBLICATION  
Carpenter, Jeff  
Jun 29 2016 2:27 PM  
STATE DESIGN ENGINEER  
Washington State Department of Transportation

**BID DOCUMENTS**

NUMBER	REVISION DESCRIPTION	BY	APP.	DATE

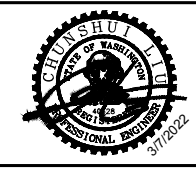

SURVEYED: \_\_\_\_\_  
DRAWN BY: HAS/RAS  
DESIGN BY: SK  
CHECK BY: JXL  
PROJ MGR: RJH  
FILE: Detail Plans.dwg



CITY OF MERCER ISLAND  
76TH AVENUE SE  
MID-BLOCK CROSSWALK  
WSDOT STANDARD PLANS

SHEET NO. 10 OF 20  
PROJECT NO. \_\_\_\_\_  
FED AID NO. \_\_\_\_\_  
DATE: 3/3/2022

\\dks-seq-001\Company\p\projects\21\21160-000 mercer island 21-40 76th ave se mid-block crosswalk\03 design\04 CAD\Detail Plans.dwg 3/7/2022 3:23 PM

DRAWN BY: FERN LIDDELL

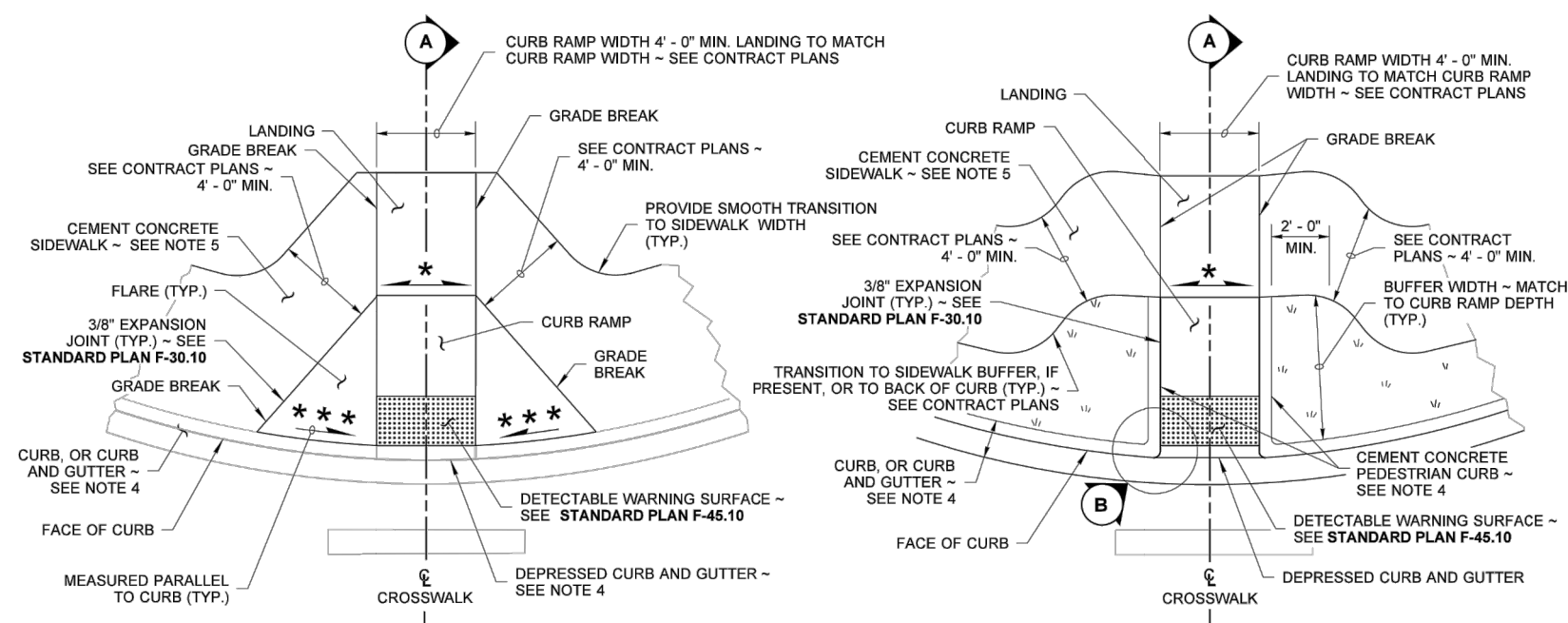

**PLAN VIEW**  
**TYPE PERPENDICULAR A**

**PLAN VIEW**  
**TYPE PERPENDICULAR B**  
(SHOWN WITH BUFFER)

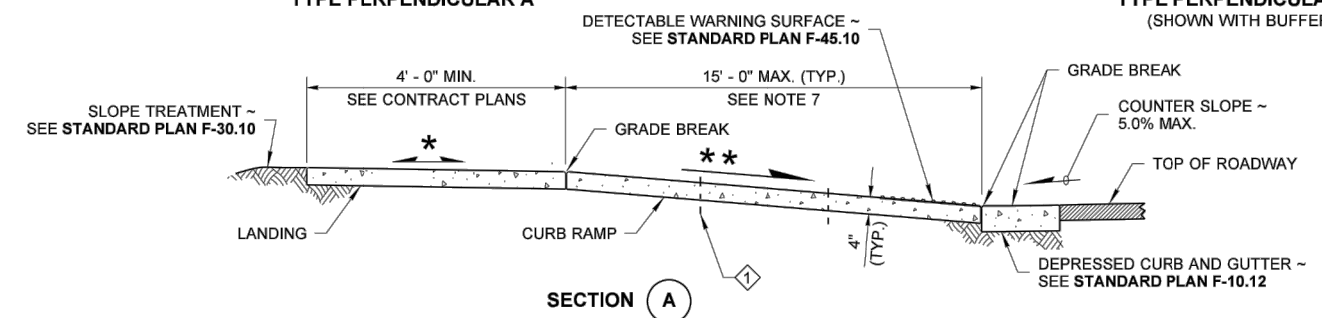

**SECTION A**

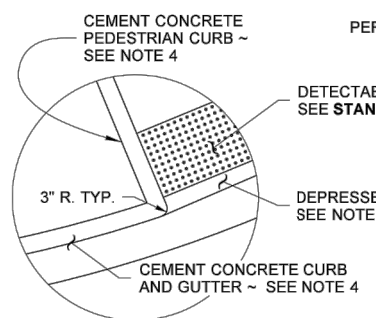

**CURB RADIUS DETAIL B**

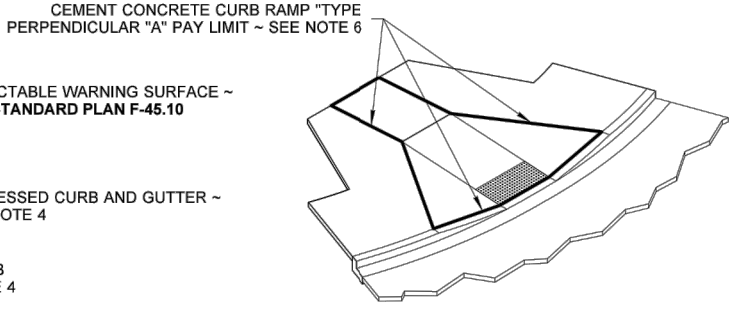

**ISOMETRIC VIEW**  
**TYPE PERPENDICULAR A PAY LIMIT**

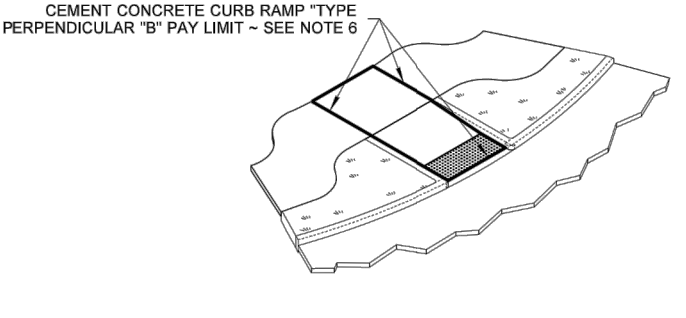

**ISOMETRIC VIEW**  
**TYPE PERPENDICULAR B PAY LIMIT**

**NOTES**

1. At marked crosswalks, the connection between the curb ramp and the roadway must be contained within the width of the crosswalk markings.
2. Where "GRADE BREAK" is called out, the entire length of the grade break between the two adjacent surface planes shall be flush.
3. Do not place Gratings, Junction Boxes, Access Covers, or other appurtenances on any part of the Curb Ramp or Landing, or in front of the Curb Ramp where it connects to the roadway.
4. See Contract Plans for the curb design specified. See **Standard Plan F-10.12** for Curb, Curb and Gutter, Depressed Curb and Gutter, and Pedestrian Curb details.
5. See **Standard Plan F-30.10** for Cement Concrete Sidewalk Details. See Contract Plans for width and placement of sidewalk.
6. The Bid Item "Cement Concrete Curb Ramp Type \_\_\_" does not include the adjacent Curb, Curb and Gutter, Depressed Curb and Gutter, Pedestrian Curb, or Sidewalks.
7. The Curb Ramp length is not required to exceed 15 feet (unless shown otherwise in the Contract Plans). When applying the 15-foot max. length, the running slope of the Curb Ramp is allowed to exceed 8.3%. Use a single constant slope from bottom of ramp to top of ramp to match into the landing over a horizontal distance of 15 feet. Do not include the abutting landing in the 15-foot max. measurement.
8. Curb Ramps and Landings shall receive a broom finish. See **Standard Specifications 8-14**.
9. Pedestrian Curb may be omitted if the ground surface at the back of the Curb Ramp and/or Landing will be at the same elevation as the Curb Ramp or Landing and there will not be material to retain.

**LEGEND**

- SLOPE IN EITHER DIRECTION
- \* 1.5% OR FLATTER RECOMMENDED FOR DESIGN/FORMWORK (2% MAX.)
- \*\* 7.5% OR FLATTER RECOMMENDED FOR DESIGN/FORMWORK (8.3% MAX.)
- \*\*\* 9.5% OR FLATTER RECOMMENDED FOR DESIGN/FORMWORK (10% MAX.)



Digitally signed by R. Scott Zeller  
Date: 2020.09.22 13:23:53 -0700'

**PERPENDICULAR CURB RAMP**  
**STANDARD PLAN F-40.15-04**

SHEET 1 OF 1 SHEET

APPROVED FOR PUBLICATION  
Date: 2020.09.25  
14:44:37 -0700'  
STATE DESIGN ENGINEER  
Washington State Department of Transportation

**BID DOCUMENTS**

NUMBER	REVISION DESCRIPTION	BY	APP.	DATE

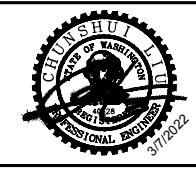

SURVEYED: \_\_\_\_\_  
DRAWN BY: HAS/RAS  
DESIGN BY: SK  
CHECK BY: JXL  
PROJ MGR: RJH  
FILE: Detail Plans.dwg



**CITY OF MERCER ISLAND**  
76TH AVENUE SE  
MID-BLOCK CROSSWALK  
  
WSDOT STANDARD PLANS

SHEET NO. 11 OF 20  
PROJECT NO. \_\_\_\_\_  
FED AID NO. \_\_\_\_\_  
DATE: 3/3/2022

\\dks-seq-001\Company\p\projects\21\21160-000 mercer island 21-40 76th ave se mid-block crosswalk\03 design\04 CAD\Detail Plans.dwg 3/7/2022 3:23 PM

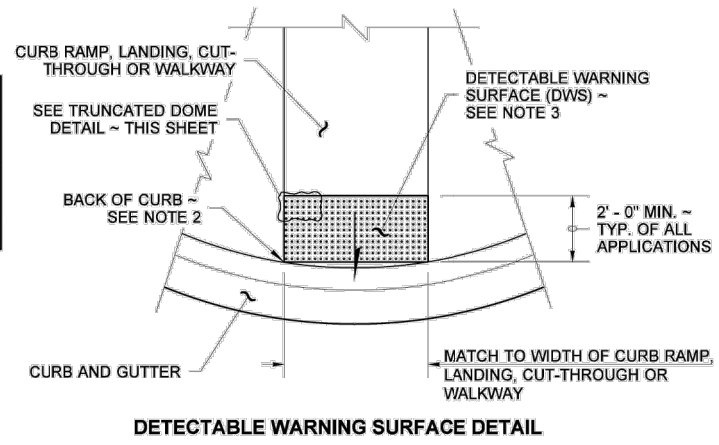
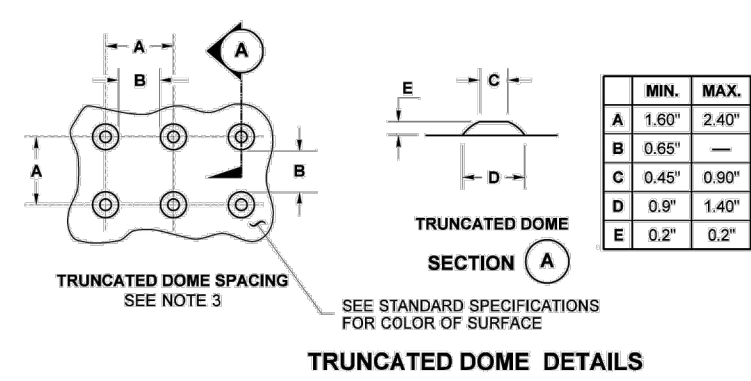

- NOTES**
- Permanent Detectable Warning Surfaces (DWS) shall extend the full width of the curb ramp, landing, or other roadway entrance as applicable. Exception: If the Manufacturer of the DWS requires a concrete border around the DWS, a variance of up to 2" (in) on each side of the DWS is permitted.
  - Permanent Detectable Warning Surfaces (DWS) shall be placed on a minimum 4" (in) thick concrete pad. The DWS panel shall be placed adjacent to the back of the curb and with no more than a 2" (in) gap between the DWS and the back of the curb measured at the center of the DWS panel. Exception: If the Manufacturer of the selected DWS requires a concrete border around the DWS, a variance of up to 2" (in) from the back of the curb is permitted (measured at the leading corners of the DWS panel).
  - The rows of truncated domes shall be aligned to be parallel to the direction of travel, and perpendicular to the grade break at the back of curb.
  - If curb and gutter are not present, such as a shared-use path connection, the Detectable Warning Surface shall be placed at the pavement edge.
  - See **Standard Plans** for sidewalk and curb ramp details.
  - If a curb ramp is required, the location of the Detectable Warning Surface must be at the bottom of the ramp and within the required distance from the rail crossing.
  - When the grade break between the curb ramp and the landing is less than or equal to 5 ft. from the back of curb at all points, place the Detectable Warning Surface on the bottom of the curb ramp directly above the grade break.
  - Glued or stick down Detectable Warning Surfaces are allowed only for temporary work zone applications.

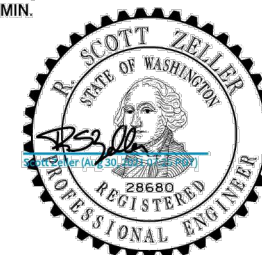
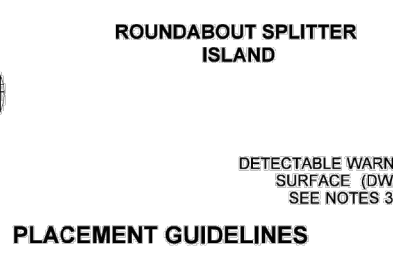
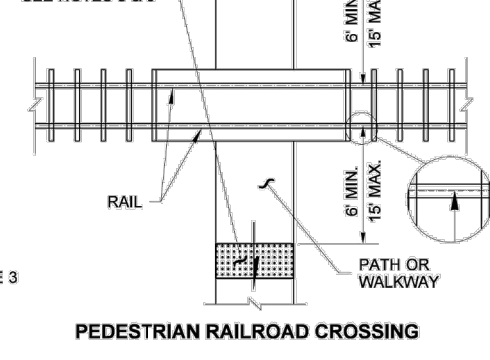
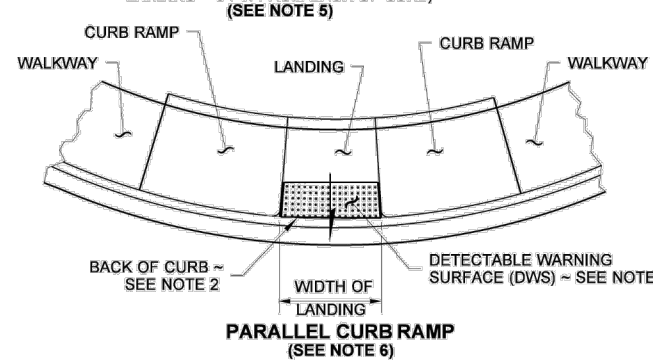
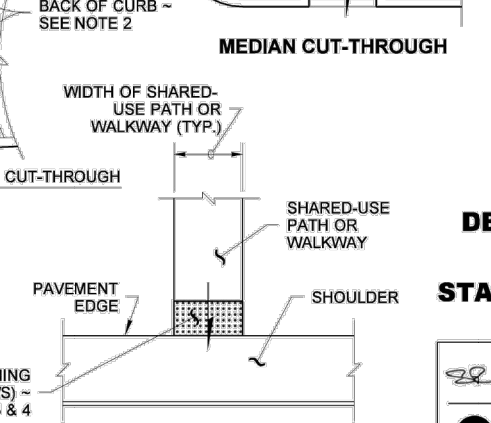
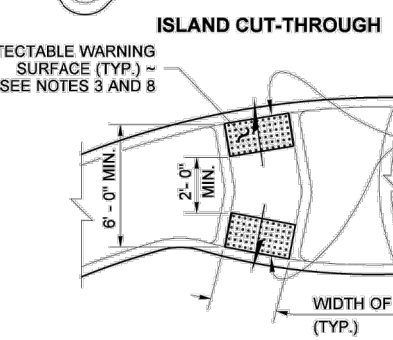
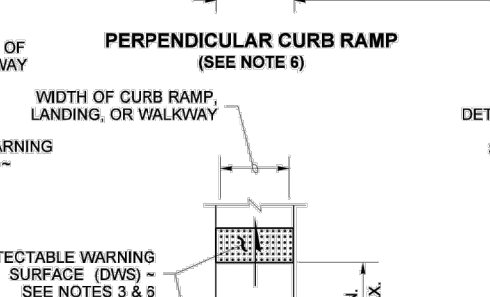
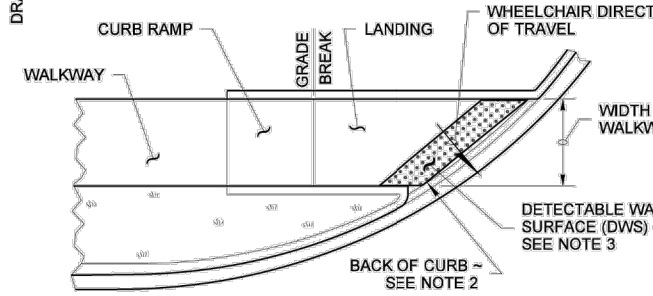
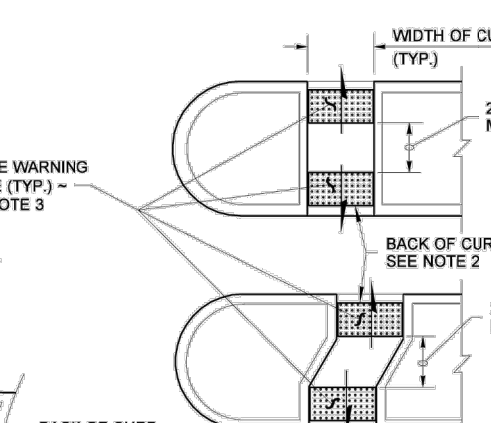
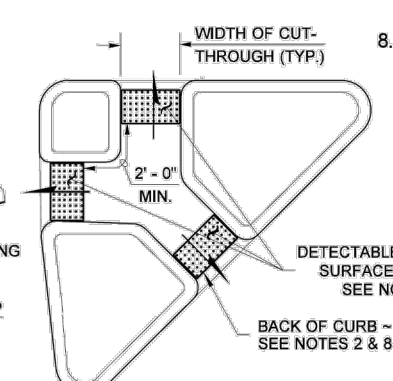
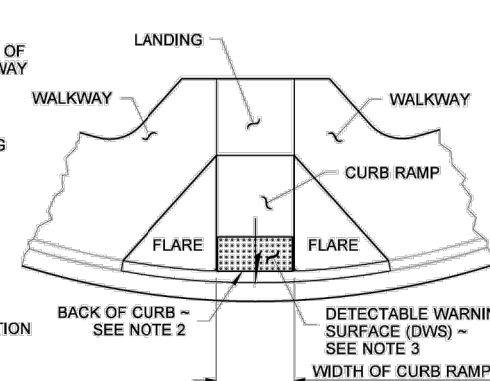
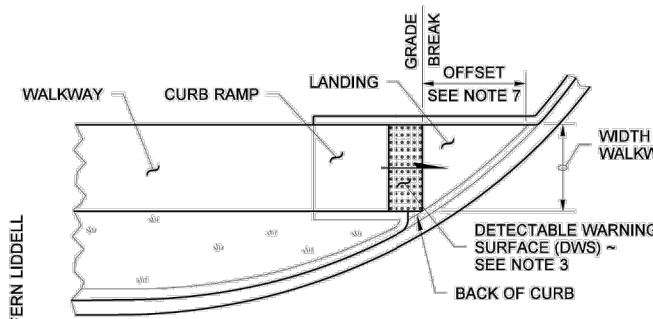

Aug 30, 2021

**DETECTABLE WARNING SURFACE**  
**STANDARD PLAN F-45.10-03**  
 SHEET 1 OF 1 SHEET

APPROVED FOR PUBLICATION  
 Aug 31, 2021  
 STATE DESIGN ENGINEER  
 Washington State Department of Transportation

**BID DOCUMENTS**

NUMBER	REVISION DESCRIPTION	BY	APP.	DATE

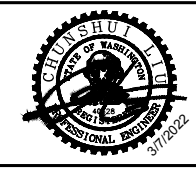

SURVEYED: \_\_\_\_\_  
 DRAWN BY: HAS/RAS  
 DESIGN BY: SK  
 CHECK BY: JXL  
 PROJ MGR: RJH  
 FILE: Detail Plans.dwg



CITY OF MERCER ISLAND  
 76TH AVENUE SE  
 MID-BLOCK CROSSWALK  
 WSDOT STANDARD PLANS

SHEET NO. 12 OF 20  
 PROJECT NO. \_\_\_\_\_  
 FED AID NO. \_\_\_\_\_  
 DATE: 3/3/2022

\\dks-seq-001\Company\p\projects\21\21160-000 mercer island 21-40 76th ave se mid-block crosswalk\03 design\04 CAD\Detail Plans.dwg 3/7/2022 3:23 PM

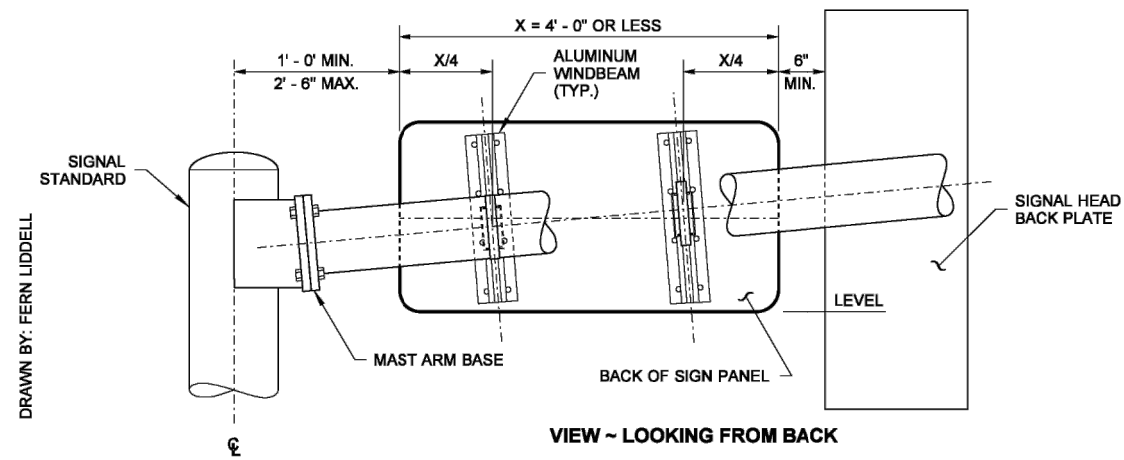

VIEW ~ LOOKING FROM BACK

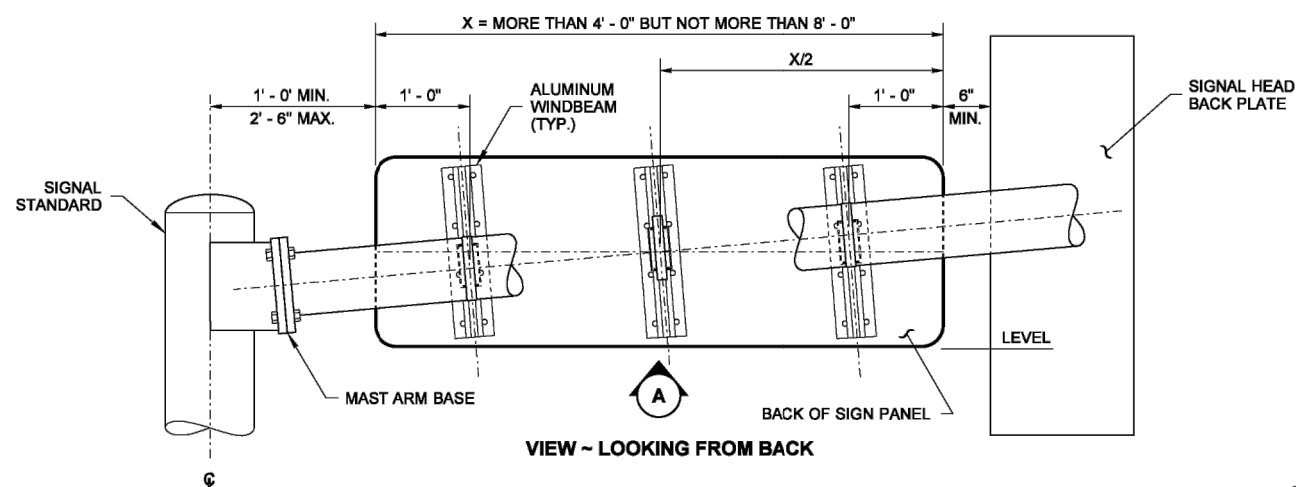

VIEW ~ LOOKING FROM BACK

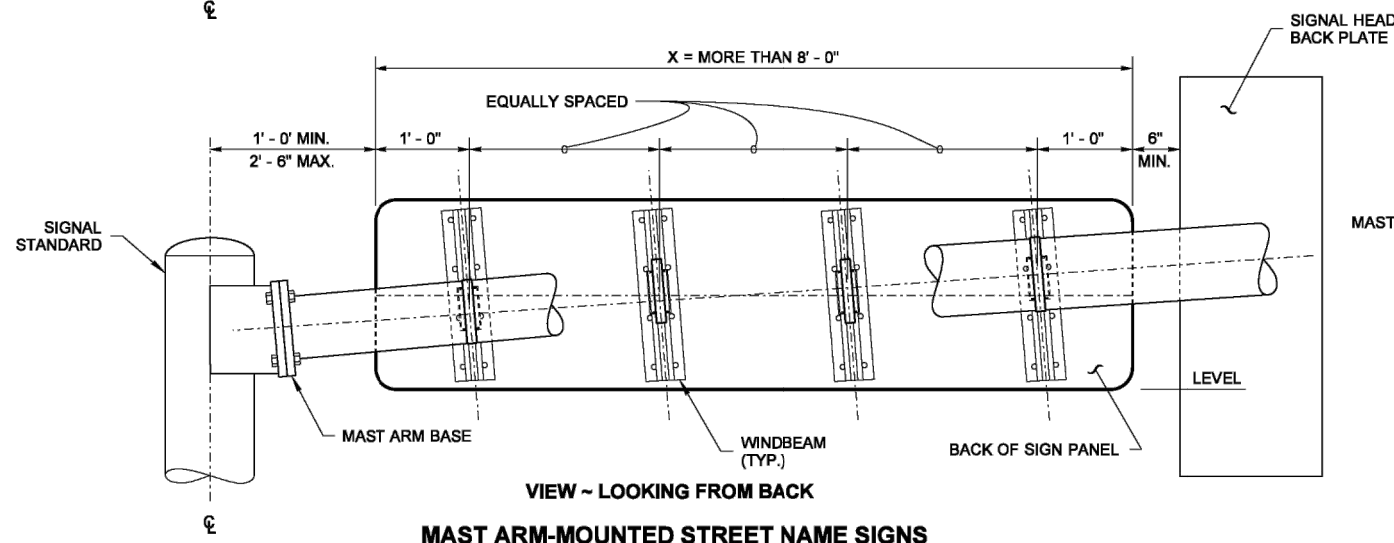

VIEW ~ LOOKING FROM BACK  
MAST ARM-MOUNTED STREET NAME SIGNS

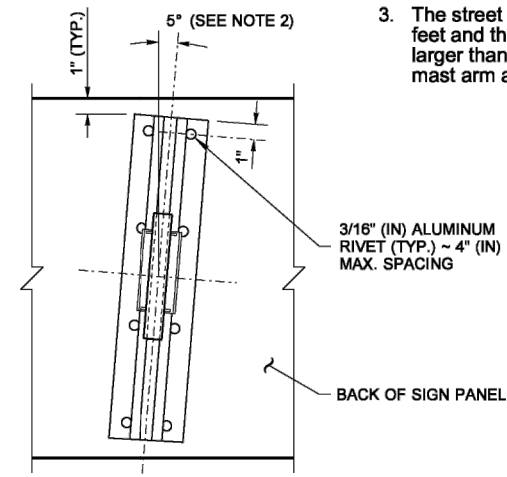

DETAIL A  
TYPICAL FOR EACH CONNECTION

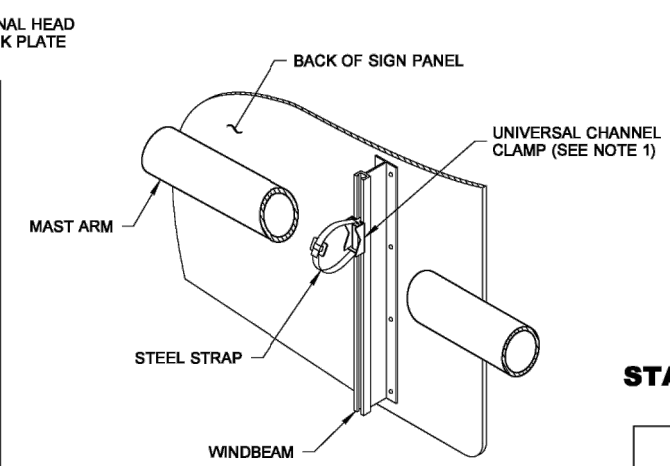

TYPICAL MAST ARM INSTALLATION

**NOTES**

1. Mounting brackets with steel straps shall be a stainless steel band and buckle system product or an approved equal. Mounting brackets shall be universal channel clamps; steel straps shall be 3/4" (in) wide and 0.030" (in) thick.
2. All signs installed on mast arms or standards (poles) require windbeams. All signs shall be installed with horizontal edges level. A skewed windbeam is required only when the sign is mounted within 12" (in) of the mast arm base (see Detail "A").
3. The street name sign shall be a maximum of 36 square feet and the sign height is a maximum of 3' (ft); signs larger than 36 square feet require a special design mast arm and signal pole.

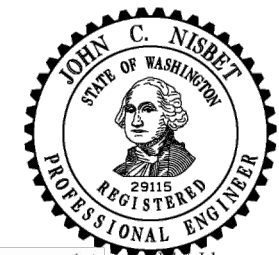

Nisbet, John  
Jun 22 2015 9:49 AM

**SIGN INSTALLATION  
ON SIGNAL AND  
LIGHT STANDARDS  
STANDARD PLAN G-30.10-04**

SHEET 1 OF 2 SHEETS

APPROVED FOR PUBLICATION  
Carpenter, Jeff  
Jun 23 2015 7:31 AM



**BID DOCUMENTS**

NUMBER	REVISION DESCRIPTION	BY	APP.	DATE



SURVEYED: \_\_\_\_\_  
DRAWN BY: HAS/RAS  
DESIGN BY: SK  
CHECK BY: JXL  
PROJ MGR: RJH  
FILE: Detail Plans.dwg



CITY OF MERCER ISLAND  
76TH AVENUE SE  
MID-BLOCK CROSSWALK  
  
WSDOT STANDARD PLANS

SHEET NO. 13 OF 20  
PROJECT NO. \_\_\_\_\_  
FED AID NO. \_\_\_\_\_  
DATE: 3/3/2022

DRAWN BY: FERN LIDDELL

DIMENSIONS	
A	B
3' - 0"	9"
4' - 0"	1' - 0"

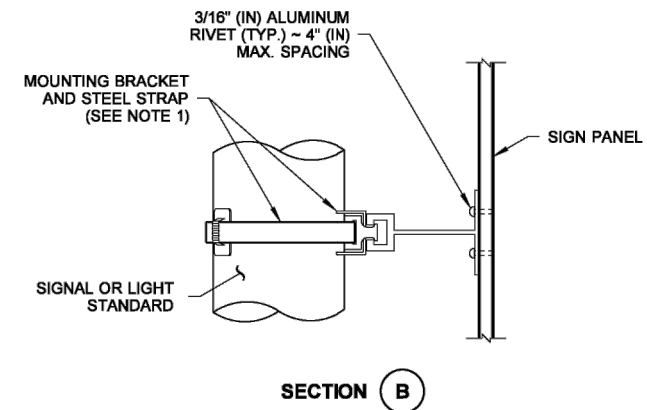
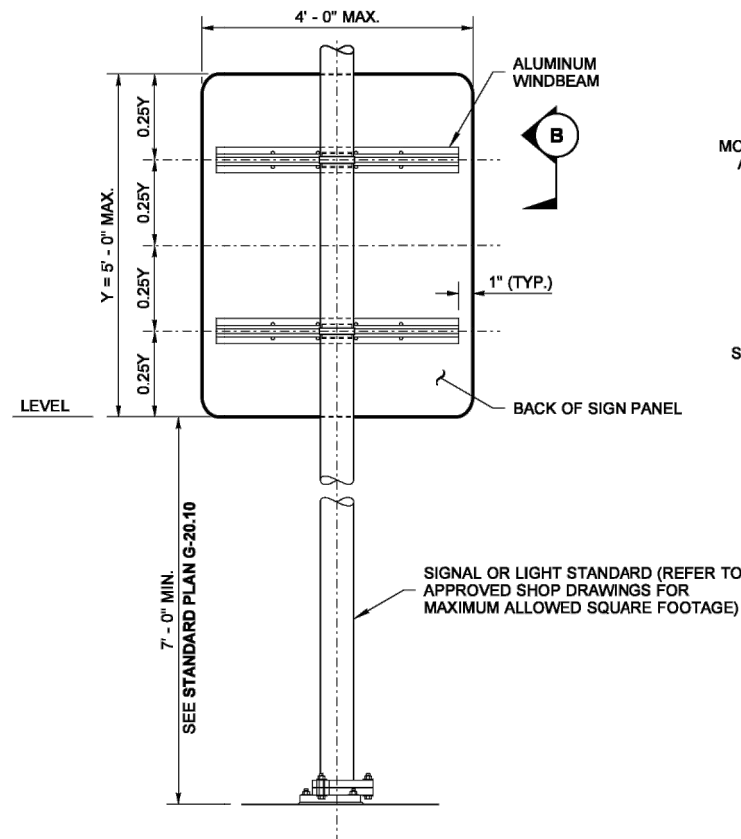
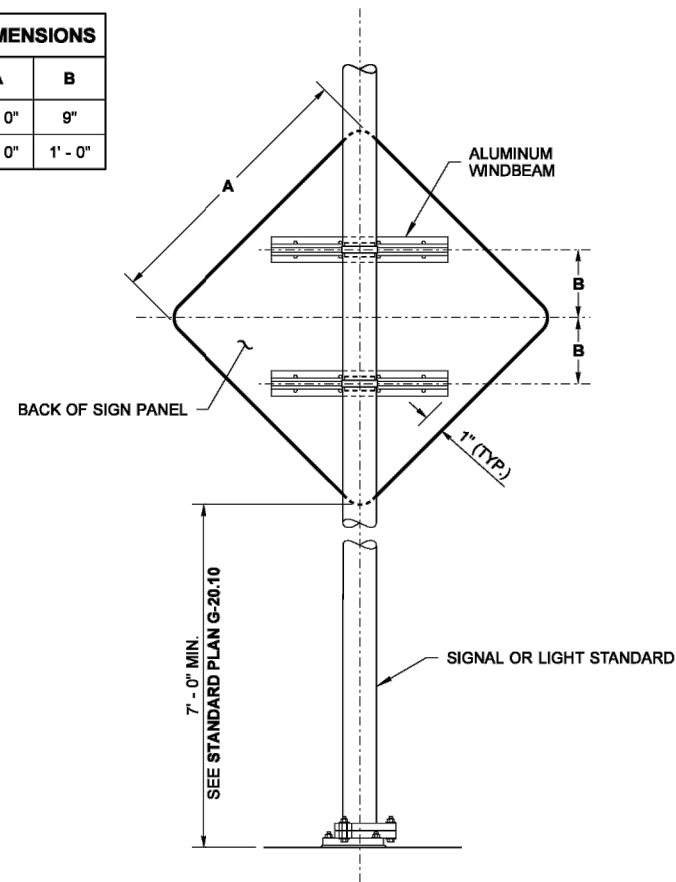

SIGN INSTALLATION ON SIGNAL OR LIGHT STANDARD

DIMENSIONS			
X	Y	C	D
3' - 0"	2' - 6"	1' - 0"	6"
3' - 0"	3' - 0"	1' - 0"	6"
3' - 0"	4' - 0"	1' - 3"	9"
4' - 0"	2' - 6"	1' - 3"	9"

**NOTE:**  
Any Lane Use Sign greater than 7.5 sq ft. requires a Special Design Mast Arm and Signal Pole.

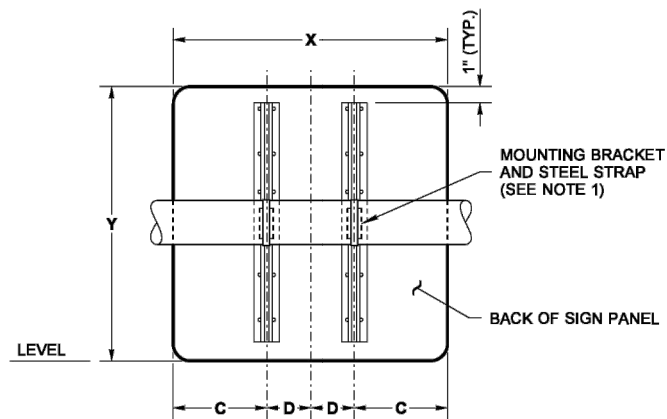

MAST ARM-MOUNTED LANE USE SIGNS



John C. Nisbet, John  
Jun 22 2015 9:50 AM  
**SIGN INSTALLATION  
ON SIGNAL AND  
LIGHT STANDARDS  
STANDARD PLAN G-30.10-04**

SHEET 2 OF 2 SHEETS

APPROVED FOR PUBLICATION  
Carpenter, Jeff  
Jun 23 2015 7:31 AM  
STATE DESIGN ENGINEER  
Washington State Department of Transportation

BID DOCUMENTS

NUMBER	REVISION DESCRIPTION	BY	APP.	DATE



SURVEYED: \_\_\_\_\_  
DRAWN BY: HAS/RAS  
DESIGN BY: SK  
CHECK BY: JXL  
PROJ MGR: RJH  
FILE: Detail Plans.dwg

**DKS**  
719 Second Ave, Suite 1250  
Seattle, WA 98104  
(206) 382-9800  
www.dksassociates.com



CITY OF MERCER ISLAND  
76TH AVENUE SE  
MID-BLOCK CROSSWALK  
WSDOT STANDARD PLANS

SHEET NO. 14 OF 20  
PROJECT NO. \_\_\_\_\_  
FED AID NO. \_\_\_\_\_  
DATE: 3/3/2022

\\dks-seq-001\Company\p\projects\21\21160-000 mercer island 21-40 76th ave se mid-block crosswalk\03 design\04 CAD\Detail Plans.dwg 3/7/2022 3:23 PM

DRAWN BY: LISA CYFORD

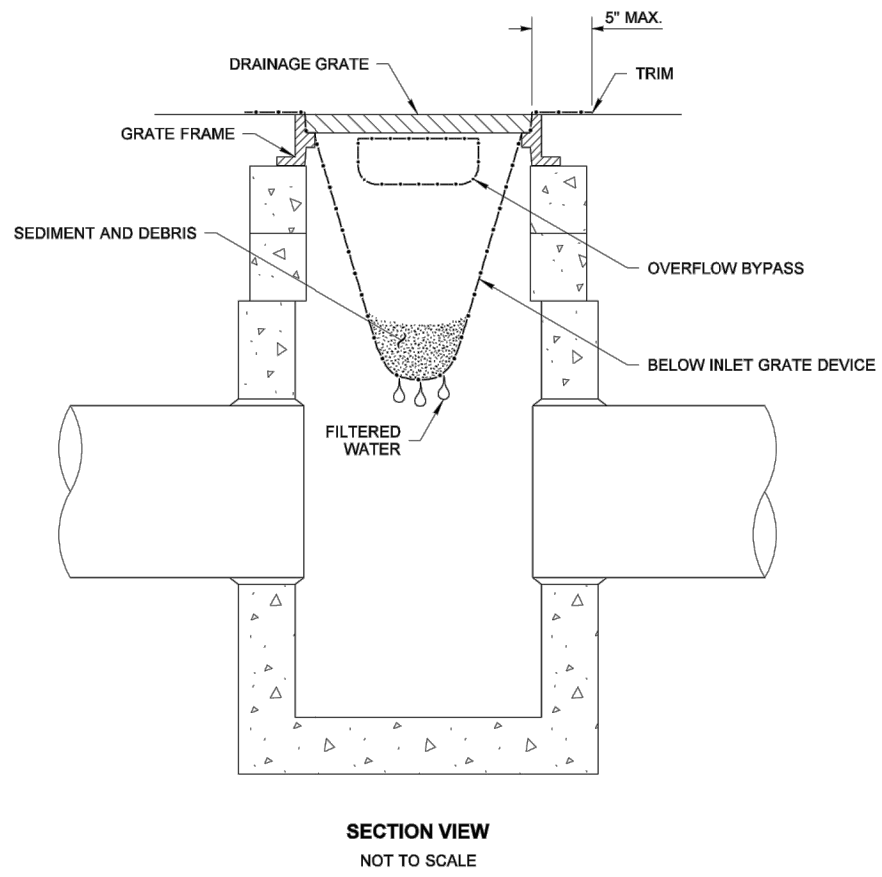

- NOTES**
1. Size the Below Inlet Grate Device (BIGD) for the storm water structure it will service.
  2. The BIGD shall have a built-in high-flow relief system (overflow bypass).
  3. The retrieval system must allow removal of the BIGD without spilling the collected material.
  4. Perform maintenance in accordance with Standard Specification 8-01.3(15).

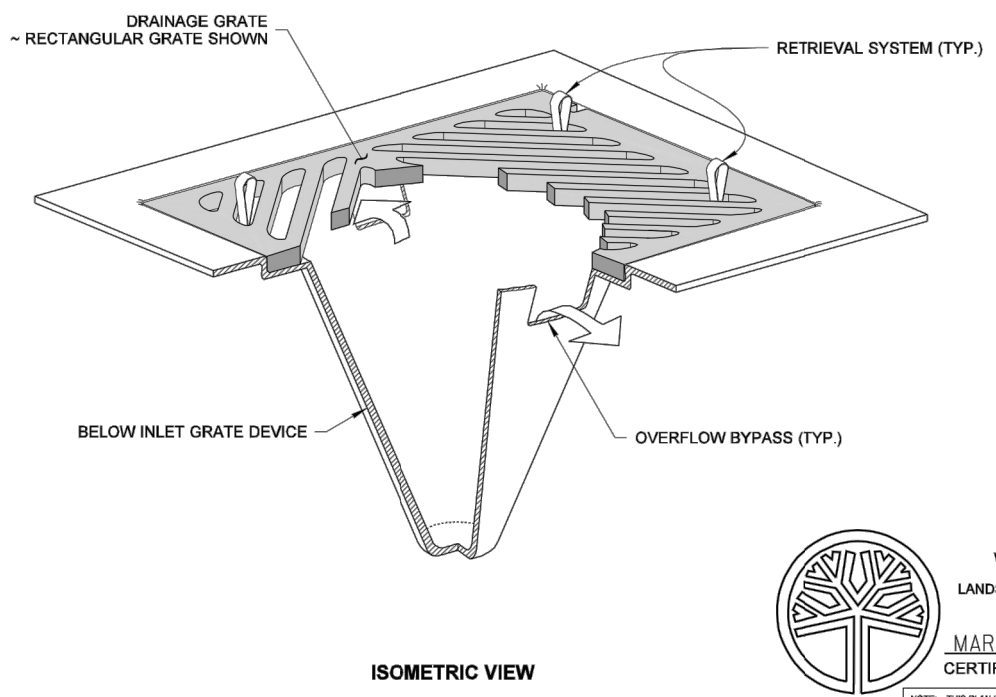

STATE OF WASHINGTON  
REGISTERED  
LANDSCAPE ARCHITECT

**MARK W. MAURER**  
CERTIFICATE NO. 000598

NOTE: THIS PLAN IS NOT A LEGAL ENGINEERING DOCUMENT BUT AN ELECTRONIC DUPLICATE. THE ORIGINAL, SIGNED BY THE ENGINEER AND APPROVED FOR PUBLICATION, IS KEPT ON FILE AT THE WASHINGTON STATE DEPARTMENT OF TRANSPORTATION. A COPY MAY BE OBTAINED UPON REQUEST.

**STORM DRAIN  
INLET PROTECTION  
STANDARD PLAN I-40.20-00**

SHEET 1 OF 1 SHEET

APPROVED FOR PUBLICATION

**Pasco Bakotich III** 09-20-07  
STATE DESIGN ENGINEER DATE

Washington State Department of Transportation

**BID DOCUMENTS**

NUMBER	REVISION DESCRIPTION	BY	APP.	DATE

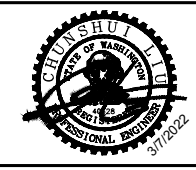

SURVEYED: \_\_\_\_\_  
DRAWN BY: HAS/RAS  
DESIGN BY: SK  
CHECK BY: JXL  
PROJ MGR: RJH  
FILE: Detail Plans.dwg



CITY OF MERCER ISLAND  
76TH AVENUE SE  
MID-BLOCK CROSSWALK

WSDOT STANDARD PLANS

SHEET NO. 15 OF 20  
PROJECT NO. \_\_\_\_\_  
FED AID NO. \_\_\_\_\_  
DATE: 3/3/2022

\\dks-seq-001\Company\p\projects\21\21160-000 mercer island 21-40 76th ave se mid-block crosswalk\03 design\04 CAD\Detail Plans.dwg 3/7/2022 3:23 PM

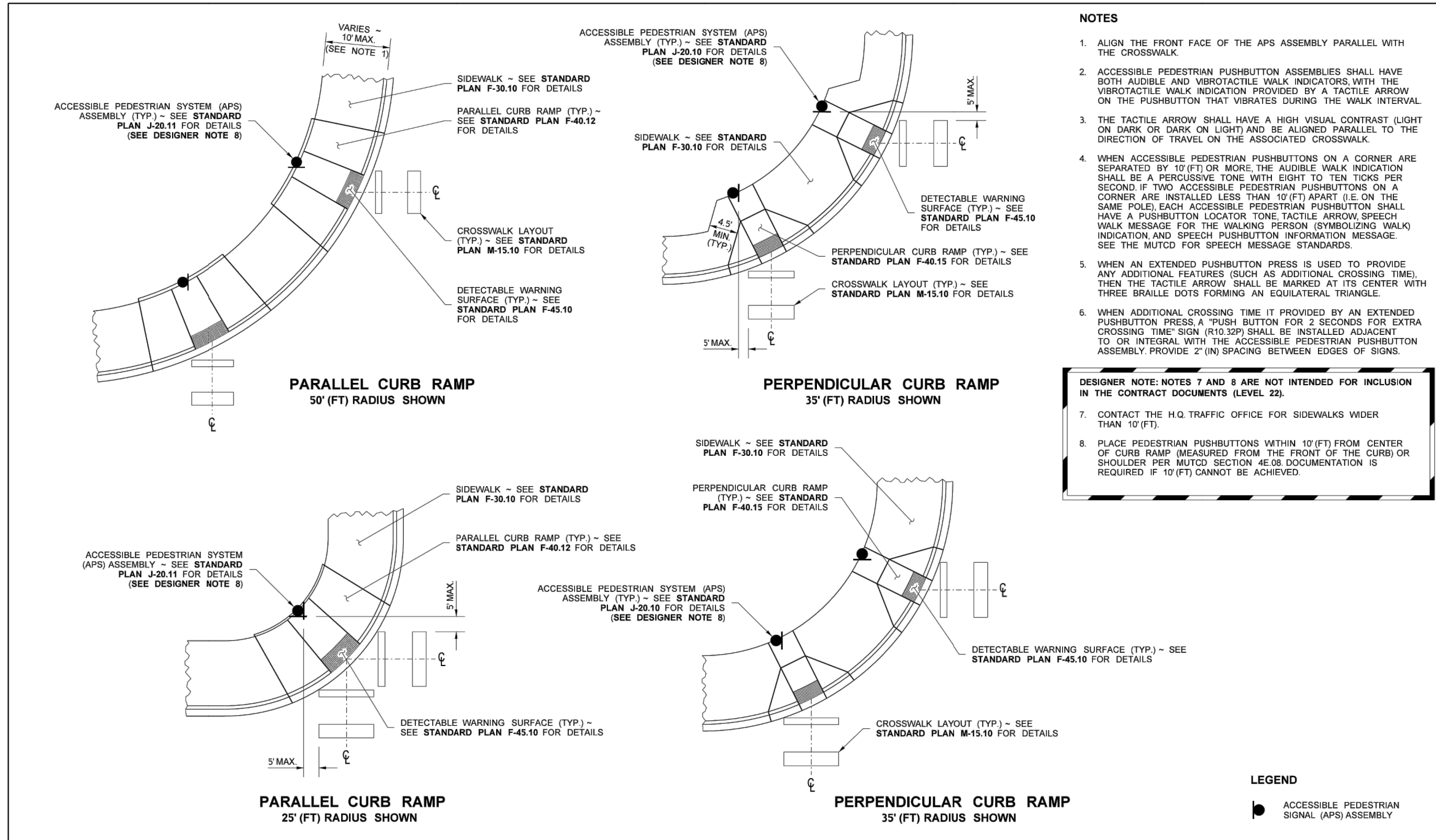

FILE NAME	S:\Design R P & S\4-Standards\2-Plan Sheet Library\01-Published PSL\IS-12 Accessible Pedestrian Push Button Post Placement\IS-12.dgn									
TIME	1:37:46 PM									
DATE	10/6/2014									
PLOTTED BY	FletCo									
DESIGNED BY										
ENTERED BY										
CHECKED BY										
PROJ. ENGR.										
REGIONAL ADM.										
REVISION										
DATE										
BY										
REGION	WASH		FED.AID PROJ.NO.				Washington State Department of Transportation		Plot 1	
STATE									PLAN REF ID	
CONTRACT NO.			LOCATION NO.						IS-12	
DATE			DATE						SHEET	
									1	
									OF	
									1	
									SHEETS	
									TYPICAL PEDESTRIAN PUSHBUTTON POST PLACEMENT	

**BID DOCUMENTS**

NUMBER	REVISION DESCRIPTION	BY	APP.	DATE

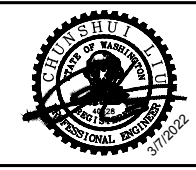

SURVEYED: \_\_\_\_\_  
 DRAWN BY: HAS/RAS  
 DESIGN BY: SK  
 CHECK BY: JXL  
 PROJ MGR: RJH  
 FILE: Detail Plans.dwg



**CITY OF MERCER ISLAND**  
 76TH AVENUE SE  
 MID-BLOCK CROSSWALK  
 WSDOT STANDARD PLANS

SHEET NO. 16 OF 20  
 PROJECT NO. \_\_\_\_\_  
 FED AID NO. \_\_\_\_\_  
 DATE: 3/3/2022



\\dks-seq-001\Company\p\projects\21\21160-000 mercer island 21-40 76th ave se mid-block crosswalk\03 design\04 CAD\Detail Plans.dwg 3/7/2022 3:23 PM

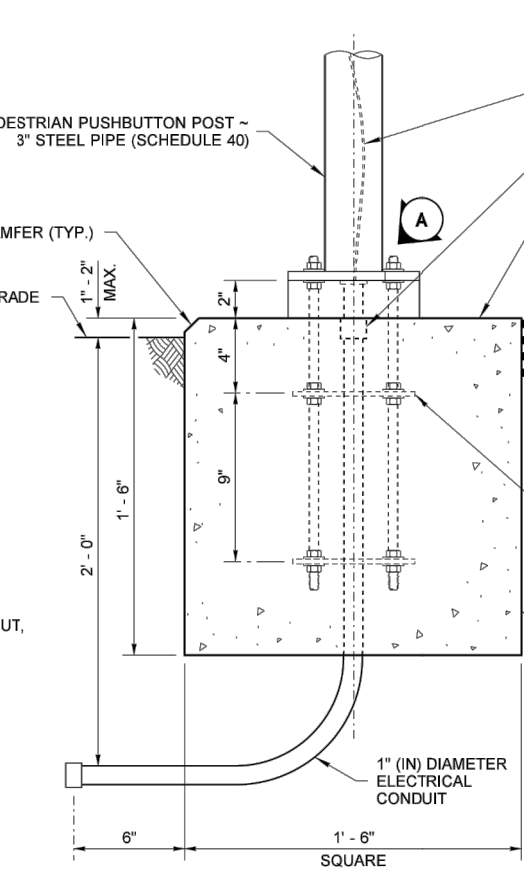
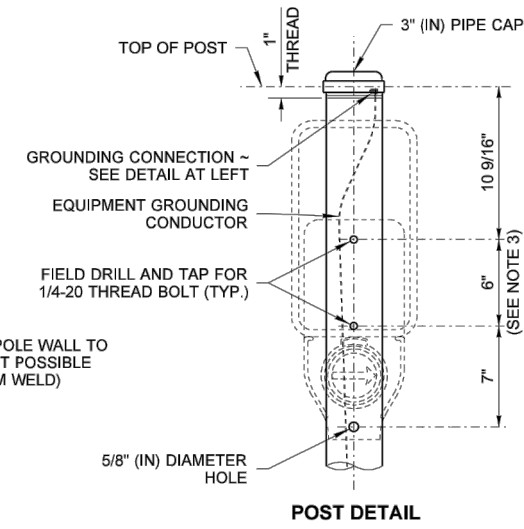
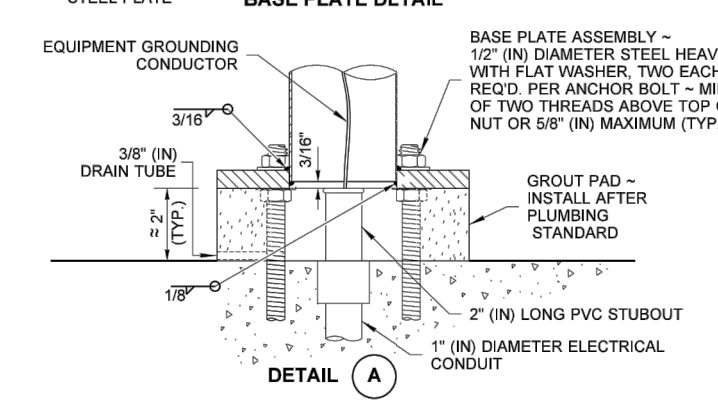
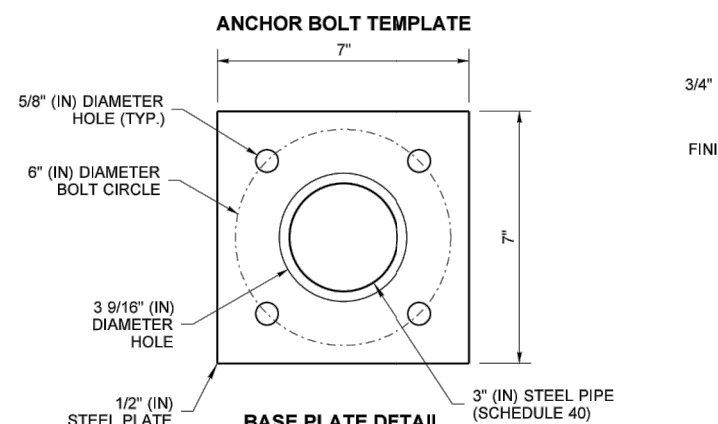
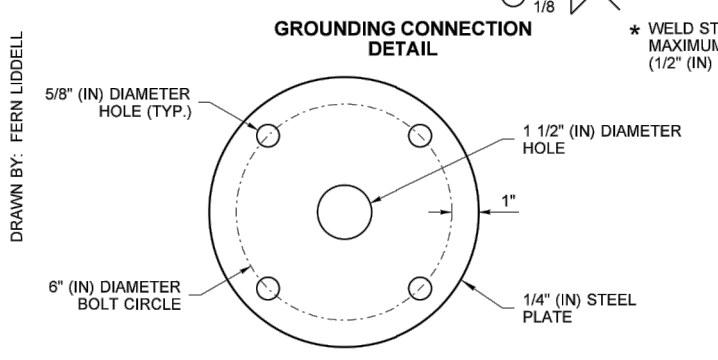
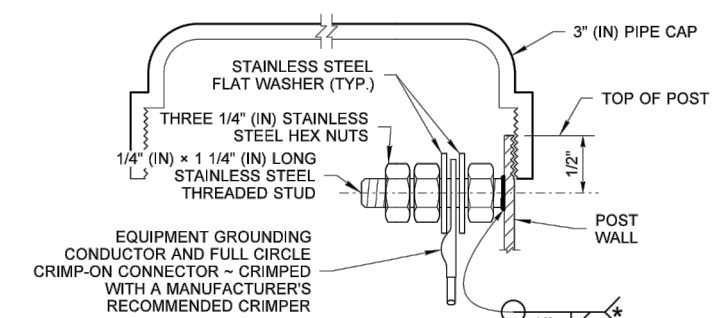

**NOTES**

1. See **Standard Plan J-20.26** for Accessible Pedestrian Pushbutton details.
2. Where shown in the plans, install plaque (R10-32P) "PUSH BUTTON FOR 2 SECONDS FOR EXTRA CROSSING TIME" above the Accessible Pedestrian Signal (APS) assembly. Add 14" (in) to post height to accommodate plaque and leave a 2" (in) space between signs.
3. Mounting distances vary between manufacturers. See manufacturers recommendations for mounting information.
4. Junction Box serving the Standard shall preferably be located 5' - 0" (10' - 0" Max.) from the Standard.
5. Two button installation may require adaptor(s).

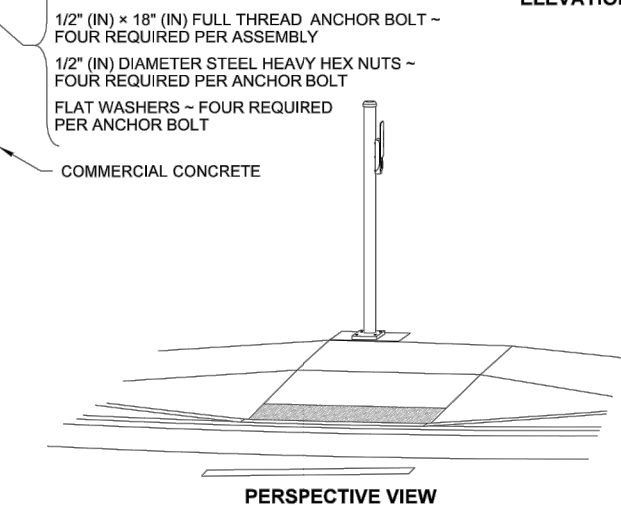
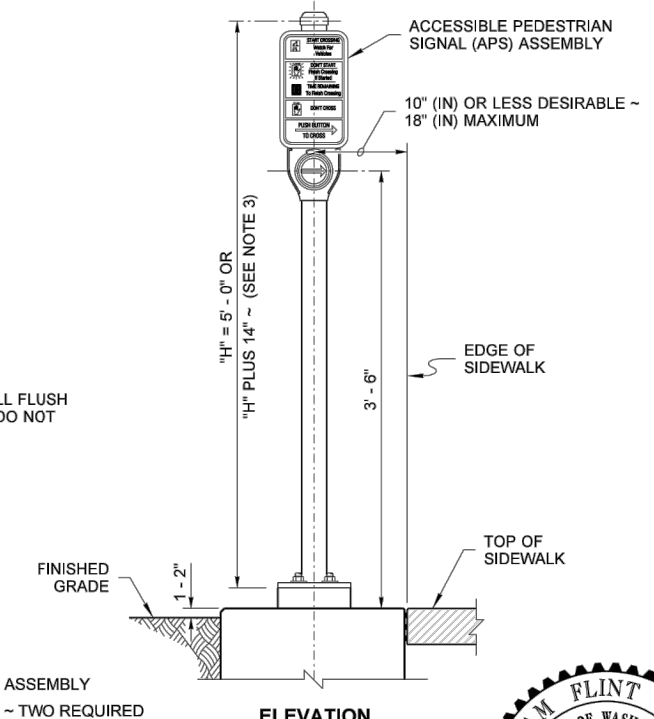

Jackson, Flint  
Jul 29 2019 2:53 PM

**ACCESSIBLE PEDESTRIAN  
PUSHBUTTON POST (PPB)  
AND FOUNDATION**

**STANDARD PLAN J-20.10-04**

SHEET 1 OF 1 SHEET

APPROVED FOR PUBLICATION  
Roark, Steve  
Jul 31 2019 12:13 PM

STATE DESIGN ENGINEER

Washington State Department of Transportation

**BID DOCUMENTS**

NUMBER	REVISION DESCRIPTION	BY	APP.	DATE

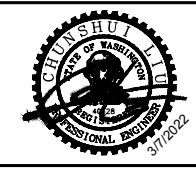

SURVEYED: \_\_\_\_\_  
DRAWN BY: HAS/RAS  
DESIGN BY: SK  
CHECK BY: JXL  
PROJ MGR: RJH  
FILE: Detail Plans.dwg

**DKS**  
719 Second Ave, Suite 1250  
Seattle, WA 98104  
(206) 382-9800  
www.dksassociates.com



**CITY OF MERCER ISLAND**  
76TH AVENUE SE  
MID-BLOCK CROSSWALK

WSDOT STANDARD PLANS

SHEET NO. 17 OF 20  
PROJECT NO. \_\_\_\_\_  
FED AID NO. \_\_\_\_\_  
DATE: 3/3/2022

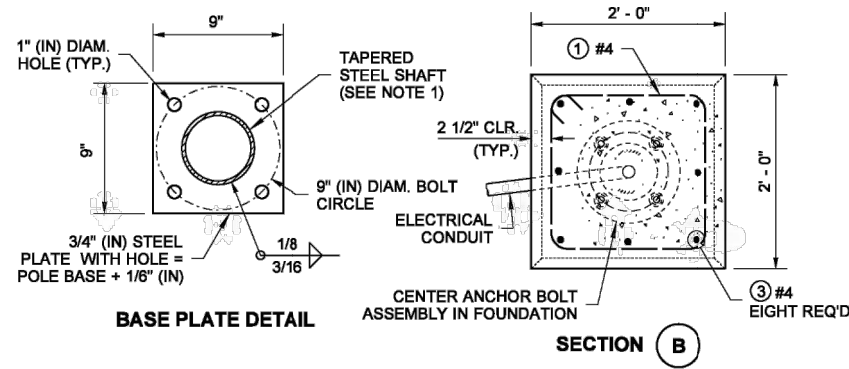
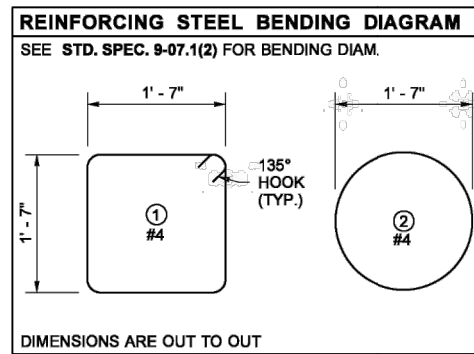

**NOTES**

1. Clamping bolts shall be tightened to 50 ft-lbs max. torque. After state inspection, burr threads to prevent nut rotation. DO NOT OVERTIGHTEN.
2. The final height of the Anchor Bolts shall be below the top of the slip plate assembly to ensure proper function of the slip base.
3. Supplemental grounding conductor shall be non-insulated #4 AWG stranded copper and shall be clamped to vertical rebar with a connector suitable for use embedded in concrete. Provide 3' - 0" min. slack. Attach to pole grounding stud with a full circle crimp-on connector (crimped with a manufacturer recommended crimper).
4. Junction box serving the Standard shall preferably be located 5' - 0" (10' - 0" Max.) from the Standard.
5. Provide cable tie at wiring entering the junction box (for slip base installations only) ~ See **Detail A**, **Standard Plan J-28.70**.
6. Keeper Plate shall not extend beyond the edges of the pole base plate.

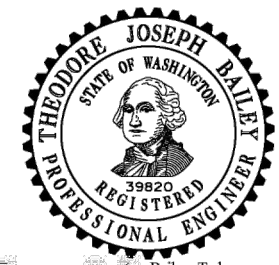
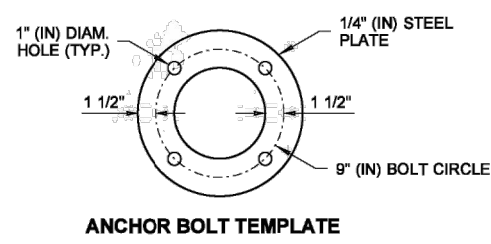
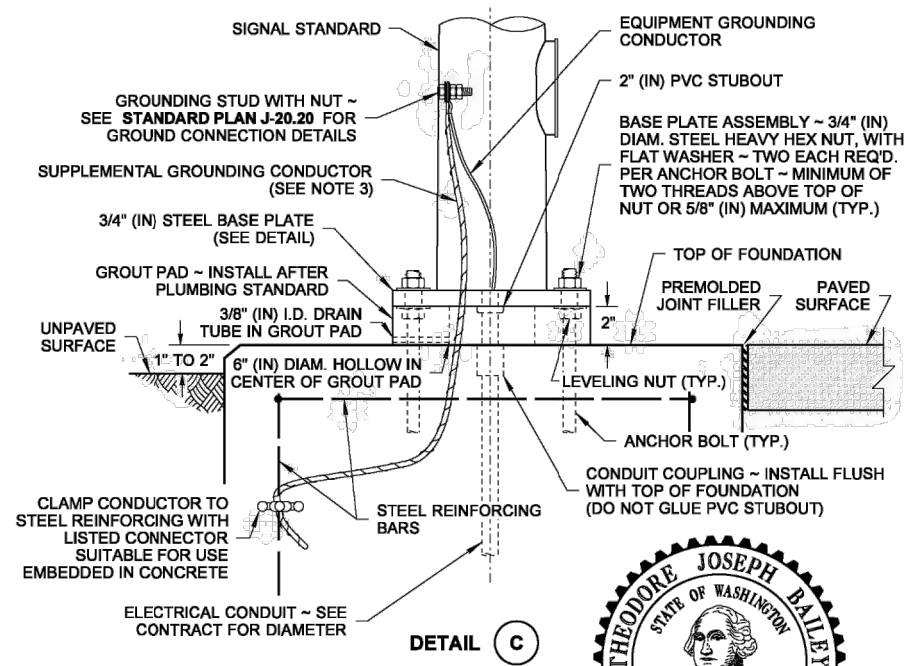
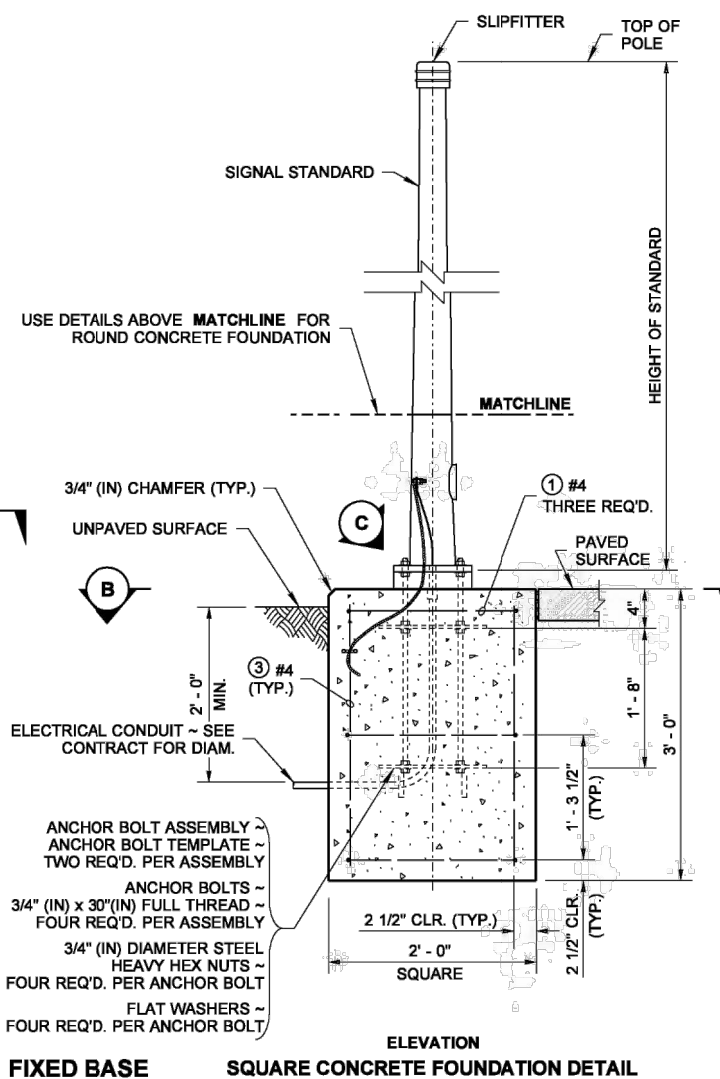
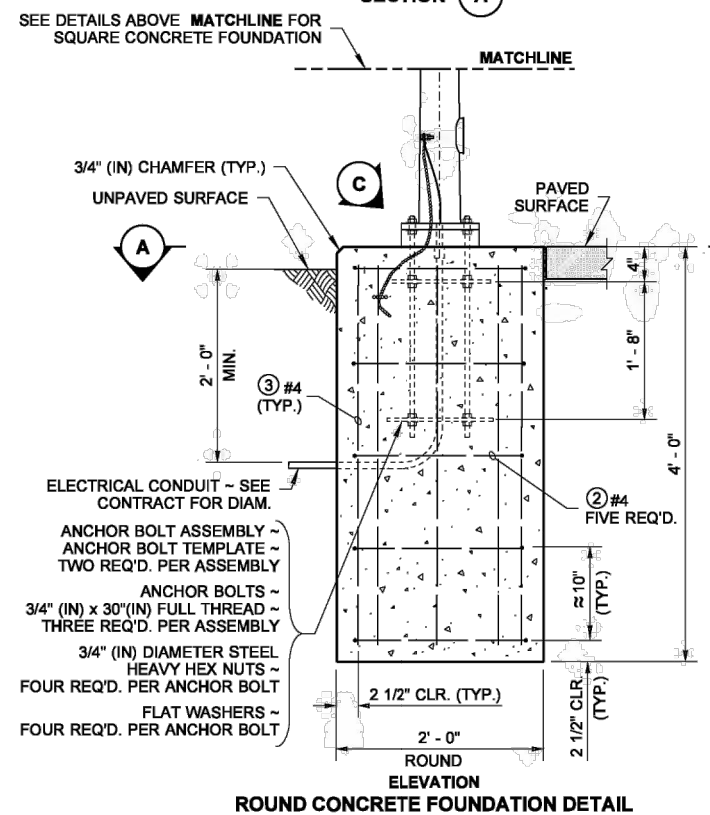
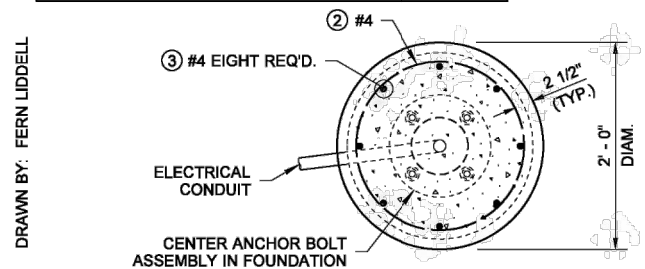

THEODORE JOSEPH BAILEY  
STATE OF WASHINGTON  
REGISTERED PROFESSIONAL ENGINEER  
39820

Bailey, Ted  
Jun 26 2014 4:29 PM

**TYPE PS, TYPE 1, RM & FB SIGNAL STANDARD FOUNDATION DETAILS**  
**STANDARD PLAN J-21.10-04**

SHEET 1 OF 2 SHEETS

APPROVED FOR PUBLICATION  
Bakotich, Pasco  
Jun 30 2014 3:12 PM

STATE DESIGN ENGINEER  
Washington State Department of Transportation

**BID DOCUMENTS**

NUMBER	REVISION DESCRIPTION	BY	APP.	DATE

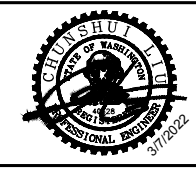

SURVEYED: \_\_\_\_\_  
DRAWN BY: HAS/RAS  
DESIGN BY: SK  
CHECK BY: JXL  
PROJ MGR: RJH  
FILE: Detail Plans.dwg



CITY OF MERCER ISLAND  
76TH AVENUE SE  
MID-BLOCK CROSSWALK  
WSDOT STANDARD PLANS

SHEET NO. 18 OF 20  
PROJECT NO. \_\_\_\_\_  
FED AID NO. \_\_\_\_\_  
DATE: 3/3/2022

\\dks-seq-001\Company\p\projects\21\21160-000 mercer island 21-40 76th ave se mid-block crosswalk\03 design\04 CAD\Detail Plans.dwg 3/7/2022 3:23 PM

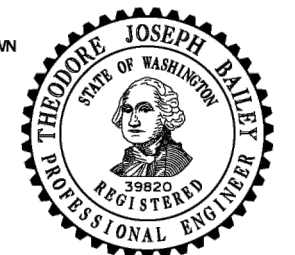
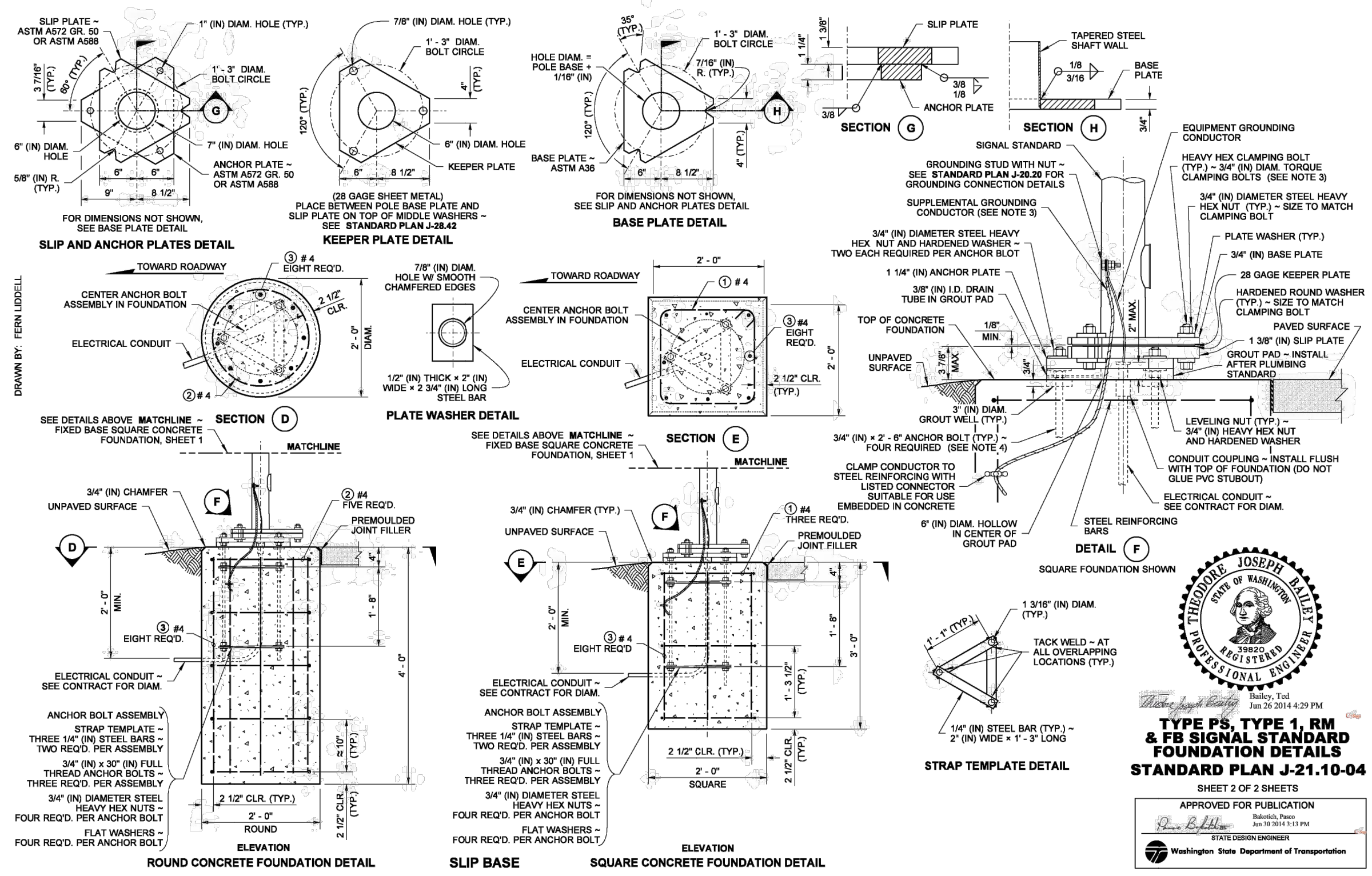

Bailey, Ted  
 Jun 26 2014 4:29 PM  
**TYPE PS, TYPE 1, RM & FB SIGNAL STANDARD FOUNDATION DETAILS**  
**STANDARD PLAN J-21.10-04**  
 SHEET 2 OF 2 SHEETS  
 APPROVED FOR PUBLICATION  
 Bakotich, Pasco  
 Jun 30 2014 3:13 PM  
 STATE DESIGN ENGINEER  
 Washington State Department of Transportation

BID DOCUMENTS

NUMBER	REVISION DESCRIPTION	BY	APP.	DATE

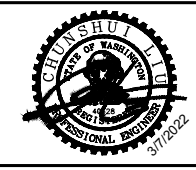

SURVEYED: \_\_\_\_\_  
 DRAWN BY: HAS/RAS  
 DESIGN BY: SK  
 CHECK BY: JXL  
 PROJ MGR: RJH  
 FILE: Detail Plans.dwg



CITY OF MERCER ISLAND  
 76TH AVENUE SE  
 MID-BLOCK CROSSWALK  
 WSDOT STANDARD PLANS

SHEET NO. 19 OF 20  
 PROJECT NO. \_\_\_\_\_  
 FED AID NO. \_\_\_\_\_  
 DATE: 3/3/2022

\\dks-seq-001\Company\p\projects\21\21160-000 mercer island 21-40 76th ave se mid-block crosswalk\03 design\04 CAD\Detail Plans.dwg 3/7/2022 3:23 PM

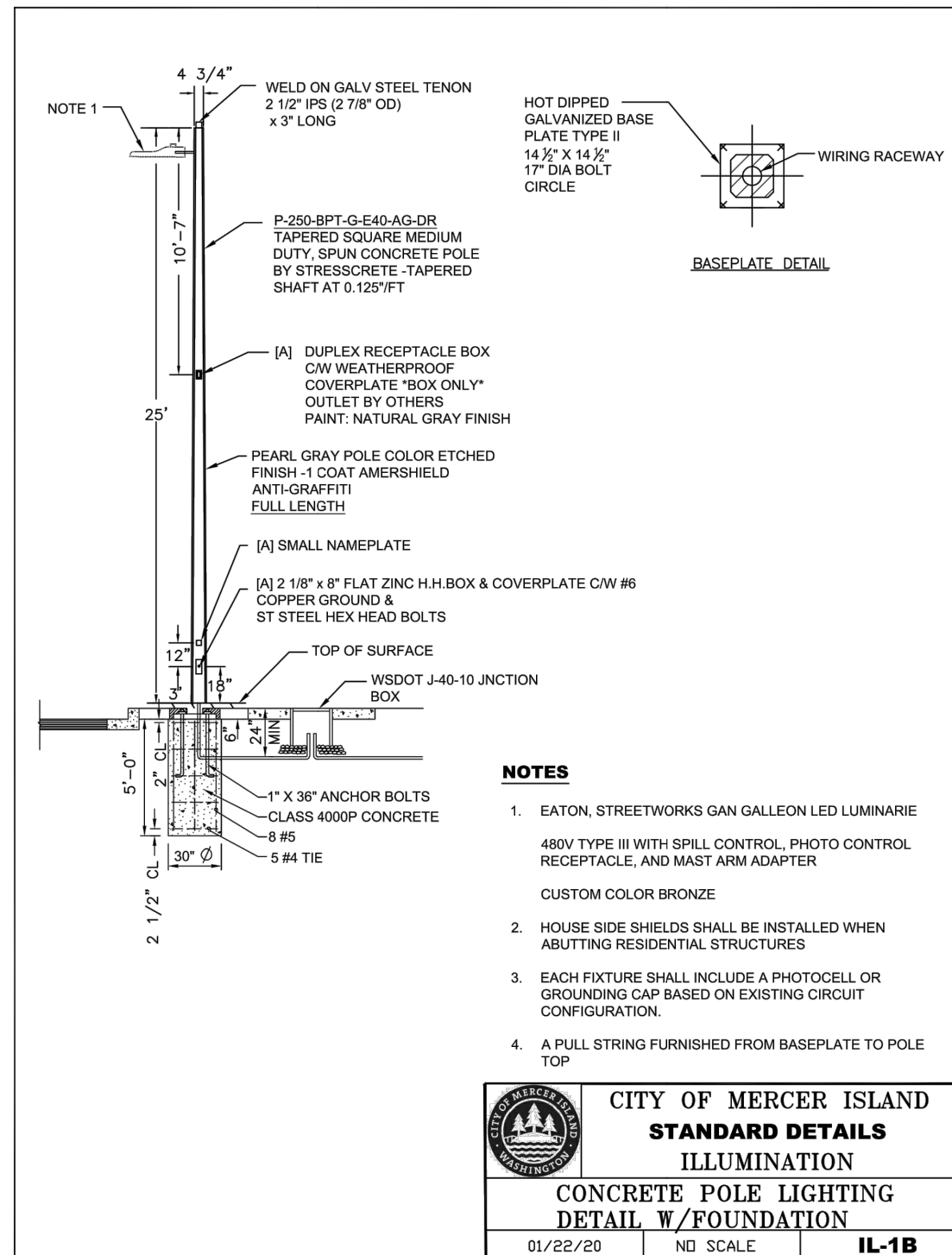

	<b>CITY OF MERCER ISLAND</b> <b>STANDARD DETAILS</b> <b>ILLUMINATION</b>
	<b>CONCRETE POLE LIGHTING</b> <b>DETAIL W/FOUNDATION</b>
01/22/20	NO SCALE
IL-1B	

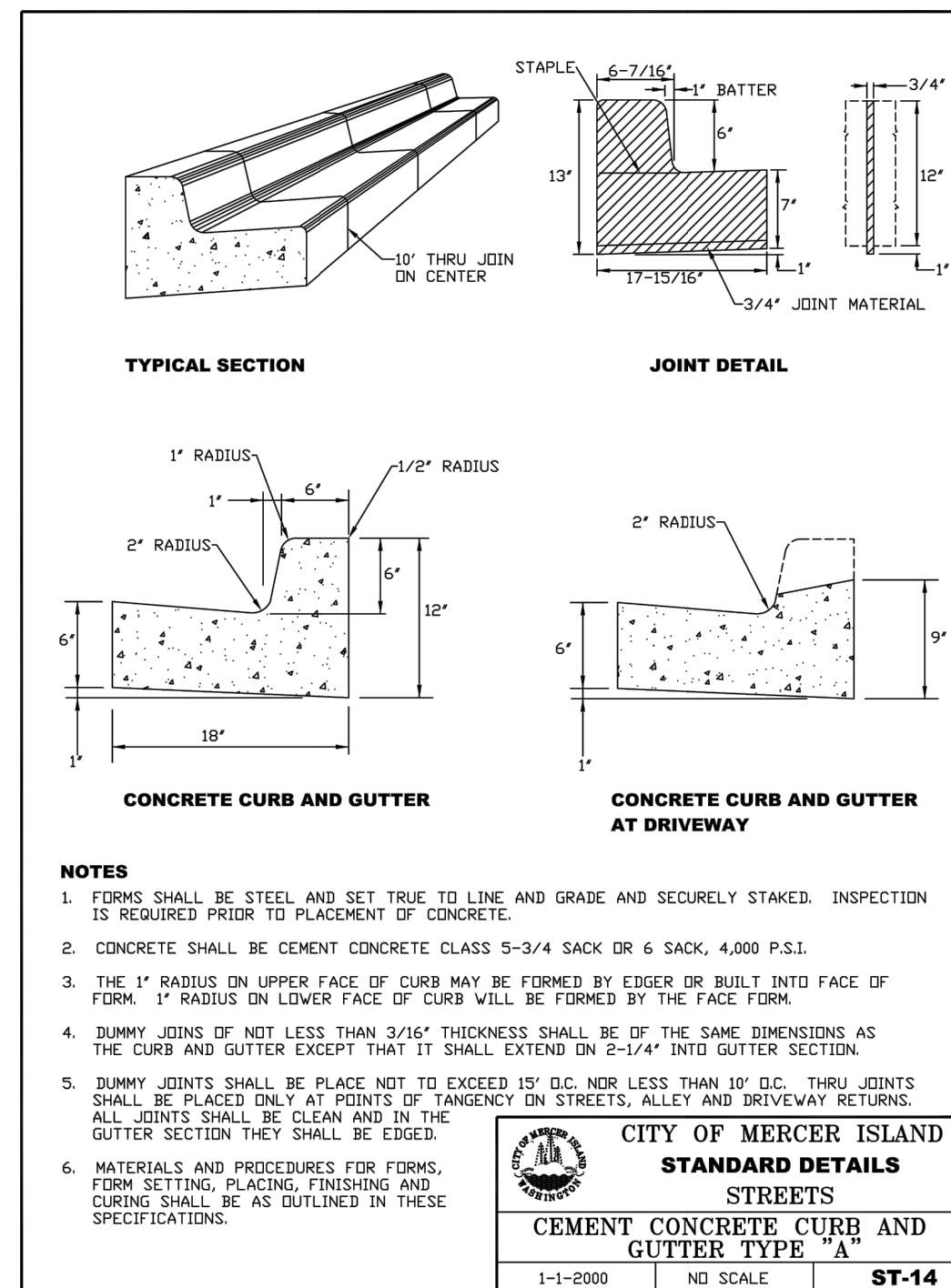

	<b>CITY OF MERCER ISLAND</b> <b>STANDARD DETAILS</b> <b>STREETS</b>
	<b>CEMENT CONCRETE CURB AND</b> <b>GUTTER TYPE "A"</b>
1-1-2000	NO SCALE
ST-14	

5-45

**BID DOCUMENTS**

NUMBER	REVISION DESCRIPTION	BY	APP.	DATE

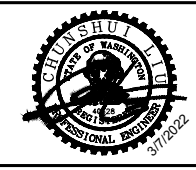

SURVEYED: \_\_\_\_\_  
 DRAWN BY: HAS/RAS  
 DESIGN BY: SK  
 CHECK BY: JXL  
 PROJ MGR: RJH  
 FILE: Detail Plans.dwg



**CITY OF MERCER ISLAND**  
 76TH AVENUE SE  
 MID-BLOCK CROSSWALK  
 CITY OF MERCER ISLAND  
 STANDARD DETAILS

SHEET NO. 20 OF 20  
 PROJECT NO. \_\_\_\_\_  
 FED AID NO. \_\_\_\_\_  
 DATE: 3/3/2022