



CITY OF MERCER ISLAND KING COUNTY WASHINGTON



2023 RESIDENTIAL STREET OVERLAYS

- SCHEDULE A - MADRONA CREST WEST RESIDENTIAL OVERLAY
- SCHEDULE B - MADRONA CREST EAST RESIDENTIAL OVERLAY
- SCHEDULE C - PAVEMENT REPAIRS (VARIOUS LOCATIONS)

PROJECT NO. 23-16

MAY 2023

BID DOCUMENT

SHEET INDEX

1	COVER
2	NOTES, LEGEND, AND QUANTITIES
3	TYPICAL SECTIONS
4-7	SCHEDULE A - MADRONA CREST WEST RESIDENTIAL OVERLAY
8-14	SCHEDULE B - MADRONA CREST EAST RESIDENTIAL OVERLAY
15	SCHEDULE C - PAVEMENT REPAIRS (VARIOUS LOCATIONS)
16-18	DETAILS

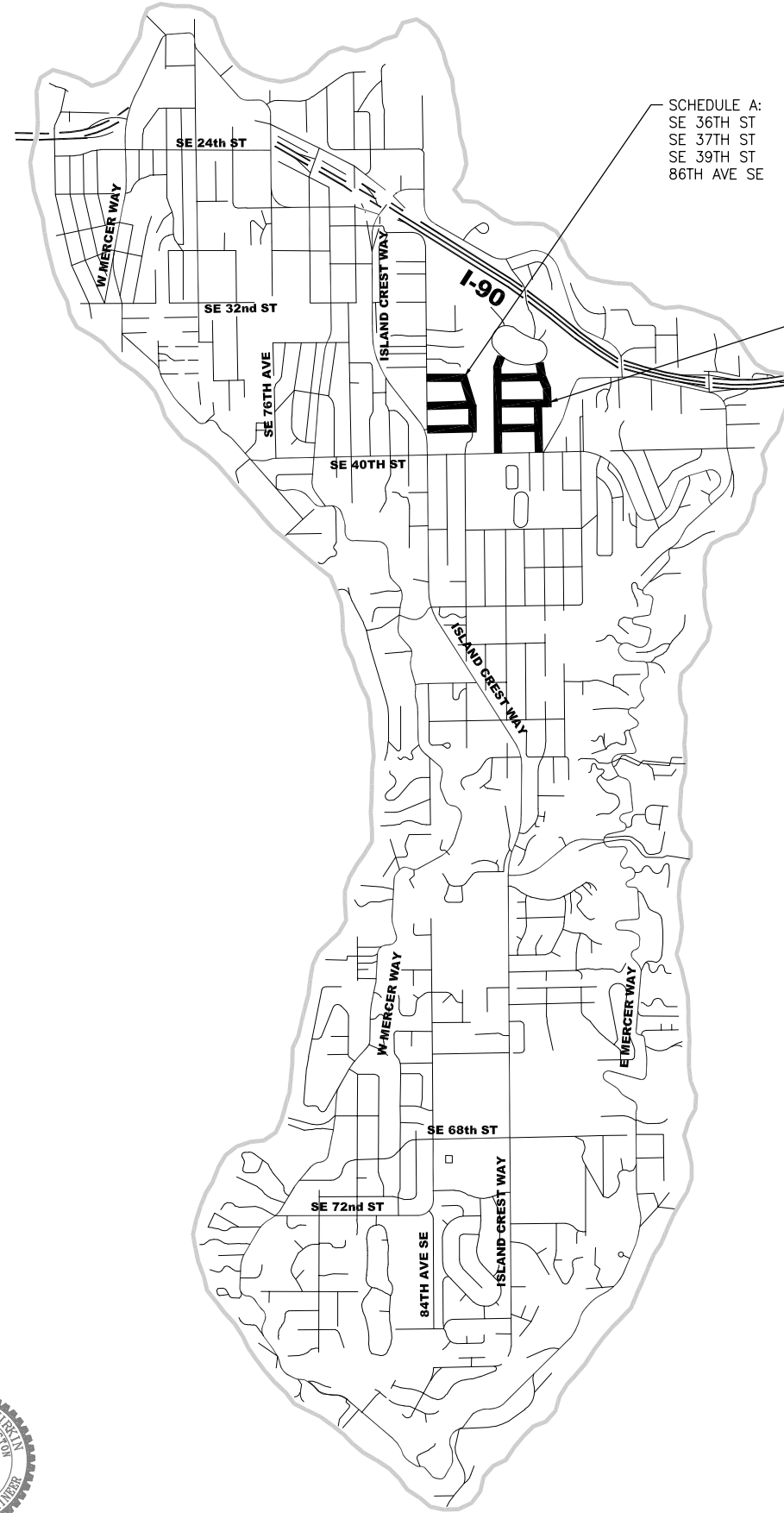

ABBREVIATIONS

AL ALUMINUM	MIC MONUMENT IN CASE
ACP ASPHALT CONCRETE PAVEMENT	MIN MINIMUM
AP ANGLE POINT	MON MONUMENT
ASPH ASPHALT	NB NORTHBOUND
AV AIR & VACUUM VALVE	NE NORTHEAST
AVE AVENUE	NO NUMBER
BC BEGIN CURB	NW NORTHWEST
BCR BEGIN CURB RETURN	P POWER
BV BUTTERFLY VALVE	PA POWER AERIAL
BM BENCH MARK	PC POINT OF CURVATURE
BO BLOW OFF	PCC PORTLAND CEMENT CONCRETE
CAP CORRUGATED ALUMINUM PIPE	PE PERFORATED PIPE
CATV CABLE TELEVISION	PED PEDESTAL
CB CATCH BASIN	PI POINT OF INTERSECTION
CEM CEMENT	PL PLASTIC PIPE
CI CAST IRON	PP POWER POLE
CL CENTER LINE, CLASS	PRV PRESSURE REDUCING VALVE
COMPT COMPACTED	PS PRESSURE SEWER
CONC CONCRETE	PT POINT OF TANGENCY
CMP CORRUGATED METAL PIPE	PV POWER VAULT
CSP CORRUGATED STEEL PIPE	PVC POINT OF VERTICAL CURVATURE
CSBC CRUSHED SURFACING BASE COURSE	PVI POINT OF VERTICAL INTERSECTION
CSTC CRUSHED SURFACING TOP COURSE	PVT PRIVATE
CU YD CUBIC YARD DRAIN	PVMT PAVEMENT
C&G CURB AND GUTTER	PVRS PAVERS
DI DUCTILE IRON PIPE	R RADIUS
DIA DIAMETER	RES RESTRAINED JOINT PIPE
DR DRIVE	RPM RAISED PAVEMENT MARKER
DTL DETAIL	RT RIGHT
DWS DETECTABLE WARNING SURFACE	R/W RIGHT-OF-WAY
DWY DRIVEWAY	SB SOUTHBOUND
ELEC ELECTRICAL	SD STORM DRAIN
ELEV ELEVATION	SDMH STORM DRAIN MANHOLE
EB EASTBOUND	SE SOUTHEAST
EC END CURB	SP SIGNAL POLE
EOP EDGE OF PAVEMENT	SQFT SQUARE FEET
EOS EDGE OF SHOULDER	SR STORM RETENTION
EXCVTN EXCAVATION	SS SANITARY SEWER
EX EXISTING	SSMH SANITARY SEWER MANHOLE
FB FIELD BOOK	ST STREET
FH FIRE HYDRANT	STA STATION
FL FLUME	SW SIDEWALK, SOUTHWEST
FSV FIRE SERVICE VAULT	TAN TANGENT
FT FEET	TBM TEMPORARY BENCH MARK
G GAS MAIN, GUTTER, GRADE	TE THICKENED EDGE
GAV GAS VALVE	TEL TELEPHONE
GV GATE VALVE	TA TELEPHONE AERIAL
GVL GRAVEL	TR TELEPHONE RISER
HMA HOT MIX ASPHALT	TELV TELEPHONE VAULT
IE INVERT ELEVATION	TYP TYPICAL
IN INCH	UP UTILITY POLE
JB JUNCTION BOX	W WATER MAIN
LAND LANDSCAPING	WB WESTBOUND
LF LINEAR FEET	WC WATERCOURSE
LT LEFT	WM WATER METER
MAX MAXIMUM	WV WATER VALVE
MB MAILBOX	WS WATER SERVICE LINE
MH MANHOLE	

LEGEND

-----	SAWCUT OR PLANING LIMIT
////	BUTT JOINT
XXXXXX	EDGE GRIND
=====	HMA BERM OR NEW CONC CURB
=====	HMA THICKENED EDGE
[Pattern]	REMOVE ACP
[Pattern]	PLANING BITUMINOUS PAVEMENT, DEPTH PER PLAN
[Pattern]	HMA FOR PAVEMENT REPAIR, PER PLAN AND TYPICAL SECTION
[Pattern]	HMA FOR PRELEVEL PER PLAN AND TYPICAL SECTION (PAID AS HMA FOR PAVING)
[Pattern]	HMA FOR PAVING PER PLAN AND TYPICAL SECTION
[Pattern]	CEM CONC SIDEWALK
[Pattern]	REMOVE WASHED ROCK
-----	REMOVE CURB

GENERAL NOTES

- ADJUST ALL SURFACE UTILITIES WITHIN PAVING LIMITS TO GRADE UNLESS NOTED OTHERWISE OR DIRECTED BY ENGINEER.
- REMOVAL LIMITS ARE APPROXIMATE. LIMITS SHALL BE STAKED BY THE CONTRACTOR AND APPROVED BY THE ENGINEER.
- STATIONS SHOWN ARE APPROXIMATE.
- DIMENSIONS SHOWN IN OVERLAY PLANS ARE PAVING WIDTHS.
- DRIVEWAY ACCESS/EGRESS MUST BE MAINTAINED AT ALL TIMES UNLESS OTHERWISE AGREED TO BY THE PROPERTY OWNER.
- CALL ONE CALL 48 HOURS BEFORE YOU DIG FOR UTILITY LOCATES: 811 OR 1-800-424-5555
- REMOVE ALL PAVEMENT MARKINGS WITHIN PAVING LIMITS PRIOR TO PAVING.
- CITY OF MERCER ISLAND SHALL PROVIDE NEW SEWER MANHOLE RINGS AND COVERS, NEW WATER VALVE BOXES, AND NEW WATER METER BOXES.
- CONTRACTOR SHALL PROVIDE NEW CATCH BASIN FRAMES, GRATES, AND SOLID LIDS.
- PRESERVE AND PROTECT ALL PLANT MATERIAL OUTSIDE OF SURFACE REMOVAL LIMITS.
- PRESERVE AND PROTECT ALL EXISTING IRRIGATION SYSTEMS OUTSIDE OF SURFACE REMOVAL LIMITS.
- CONTRACTOR SHALL INSTALL INLET PROTECTION, PER DTL 1/16, AT ALL EXISTING AND NEW CATCH BASINS WITHIN THE PROJECT LIMITS AS WELL AS DOWNSTREAM OF THE WORK AREA AS DIRECTED BY THE ENGINEER.

GENERAL CHANNELIZATION AND SIGNAGE NOTES

- REMOVE ALL CONFLICTING CHANNELIZATION.
- ALL PAVEMENT MARKING MATERIAL SHALL CONFORM TO THE "STATE OF WASHINGTON STANDARD SPECIFICATIONS FOR ROAD, BRIDGE, AND MUNICIPAL CONSTRUCTION," 2023 EDITION, UNLESS OTHERWISE SPECIFIED BY THE SPECIAL PROVISIONS.
- PLACE ONE BLUE TYPE 2 RPM AT EACH FIRE HYDRANT.

ESTIMATED PROJECT QUANTITIES

SCHEDULE	STREET NAME	FROM	TO	SHEET NO.	LENGTH (LF)	AVG WIDTH (FT)	PLANING (SY)	PAVEMENT REPAIR EXCAVATION INCL HAUL (SY)	HMA FOR PAVEMENT REPAIR (TON)	HMA FOR PAVING (TON)
SCHEDULE A - MADRONA CREST WEST RESIDENTIAL OVERLAY										
	SE 36TH ST	84TH AVE SE	86TH AVE SE	4	648	21	221	0	0	360
	SE 37TH ST	84TH AVE SE	86TH AVE SE	5	750	21	263	275	38	361
	SE 39TH ST	84TH AVE SE	86TH AVE SE	6	705	20	286	243	34	347
	86TH AVE SE	SE 36TH ST	SE 39TH ST	7	853	20	305	192	28	437
SCHEDULE B - MADRONA CREST EAST RESIDENTIAL OVERLAY										
	88TH AVE SE	SE 40TH ST	SE 36TH ST	8-9	1277	21	341	0	0	457
	90TH AVE SE	SE 40TH SE	SE 37TH ST	10-11	819	35	4079	0	0	970
	90TH AVE SE	SE 37TH ST	SE 36TH ST	11	400	20	637	371	42	311
	SE 39TH ST	88TH AVE SE	90TH AVE SE	12	675	20	853	0	0	489
	SE 37TH ST	88TH AVE SE	90TH AVE SE	13	875	20	850	0	0	584
	SE 36TH ST	88TH AVE SE	90TH AVE SE	14	750	19	240	119	23	389
TOTAL					7752 FT (1.5 MI)	-	8075	1200	165	4705

File: Z:\2023 Projects\Bona\2012_2023_Mr_Overlay\Bona\2012_P-NOTE.dwg ID: bennett Date: 05-10-23 2:28:47pm



REV. NO.	DATE	DESCRIPTION

BID DOCUMENT



DATE	5/3/2023
DESIGN	CFG
DRAFT	CFG
CHECK	CEM

CITY OF MERCER ISLAND
2023 RESIDENTIAL STREET OVERLAYS
 NOTES, LEGEND & QUANTITIES

PROJECT	23-16
SCALE	1"=20'
SHEET	2 OF 18

SECTION LEGEND

- 1 REPAIR PAVEMENT, AS FIELD MARKED, W/ HMA FOR PAVEMENT REPAIR CL B PER DTL 7/16
- 2 PRELEVEL, AS FIELD MARKED, W/ HMA FOR PAVING CL B
- 3 PAVE RESIDENTIAL ROAD W/ HMA FOR PAVING CL B PER DTL 6/16
- 4 PLANE BITUMINOUS PAVEMENT, AS FIELD MARKED, AND PAVE W/ HMA FOR PAVING CL B, 2" DEPTH (TYP)
- 5 OVERLAY ROAD W/ HMA FOR PAVING CL B, 2" DEPTH (TYP)
- 6 WIDEN ROADWAY, AS FIELD MARKED, PER HMA RESIDENTIAL ROAD DTL 6/16
- 7 PAVE HMA THICKENED EDGE W/ HMA FOR PAVING CL B PER DTL 9/16
- 8 RESTORE SHOULDER WITH CSTC, TOPSOIL AND GRASS SEED, OR BARK MULCH TO MATCH EX AS DIRECTED BY ENGINEER PER DTL 10/16
- 9 PLANE BITUMINOUS PAVEMENT, AS FIELD MARKED, AND PAVE W/ HMA FOR PAVING CL B, 3" DEPTH (TYP)
- 10 REMOVE ASPH CONC PAVEMENT, FULL DEPTH, AS FIELD MARKED

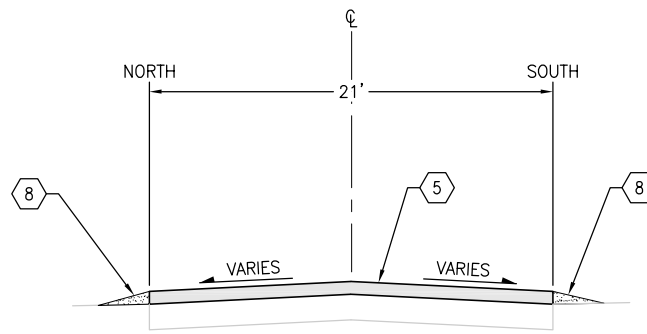

NOTE:
EX ROAD SECTION: VARIES 2"-4", 2" TYPICAL

**SCH A - SE 36TH ST
TYPICAL SECTION**

A
4 STA 40+27 TO STA 46+41
NTS

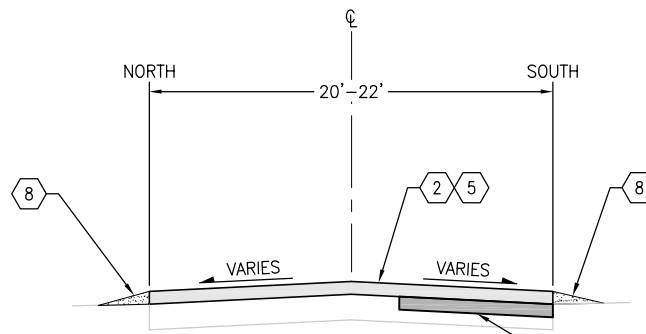

NOTE:
EX ROAD SECTION: VARIES 2"-4", 2" TYPICAL

**SCH A - SE 37TH ST
TYPICAL SECTION**

B
VAR STA 60+25 TO STA 67+50
NTS

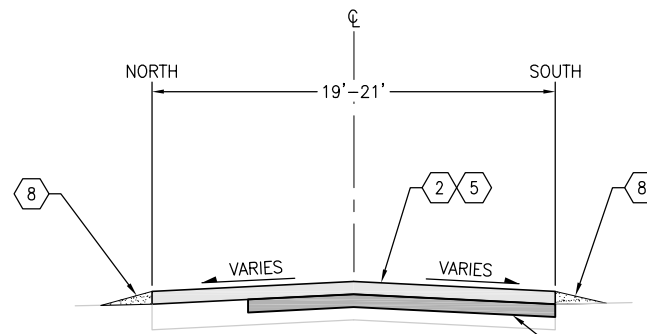

NOTE:
EX ROAD SECTION: VARIES 2"-4", 2" TYPICAL

**SCH A - SE 39TH ST
TYPICAL SECTION**

C
VAR STA 70+08 TO STA 77+13
NTS

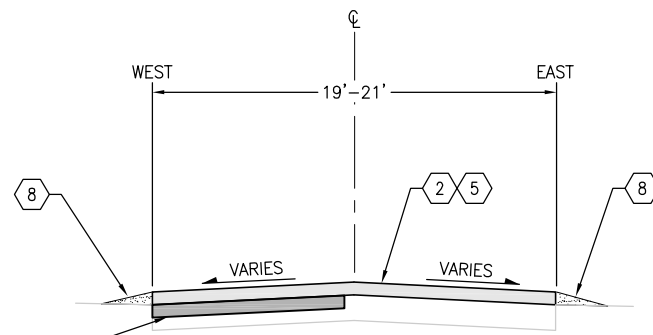

NOTE:
EX ROAD SECTION: VARIES 2"-4", 2" TYPICAL

**SCH A - 86TH AVE SE
TYPICAL SECTION**

D
VAR STA 47+25 TO STA 55+28
NTS

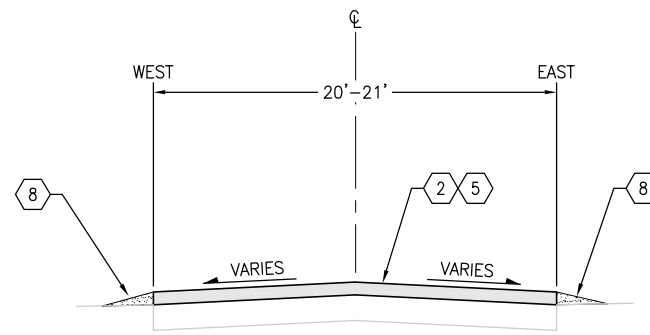

NOTE:
EX ROAD SECTION: VARIES 2"-4", 2" TYPICAL

**SCH B - 88TH AVE SE
TYPICAL SECTION**

E
VAR STA 80+55 TO STA 92+75
NTS

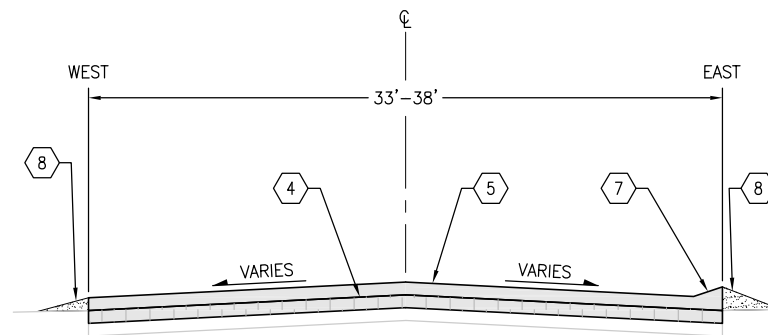

NOTE:
EX ROAD SECTION: VARIES 2"-4", 2" TYPICAL

**SCH B - 90TH AVE SE
TYPICAL SECTION**

F
VAR STA 130+56 TO STA 136+86
NTS

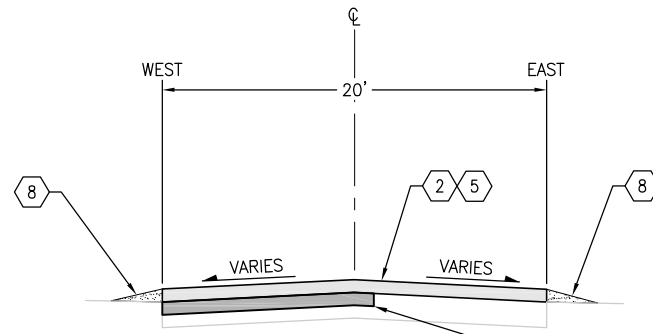

NOTE:
EX ROAD SECTION: VARIES 2"-4", 2" TYPICAL

**SCH B - 90TH AVE SE
TYPICAL SECTION**

G
VAR STA 119+25 TO STA 122+60
NTS

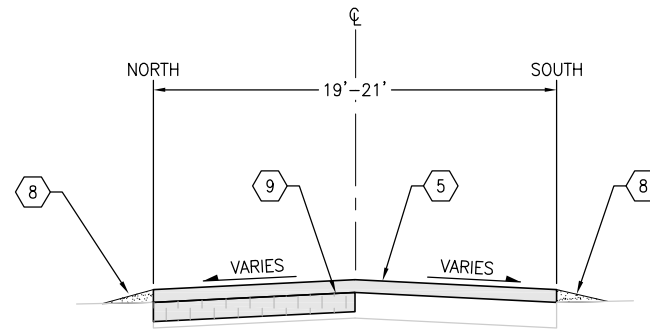

NOTE:
EX ROAD SECTION: VARIES 2"-4", 2" TYPICAL

**SCH B - SE 39TH ST AND SE 37TH ST
TYPICAL SECTION**

H
VAR STA 140+50 TO STA 146+96 & STA 110+36 TO STA 116+90
NTS

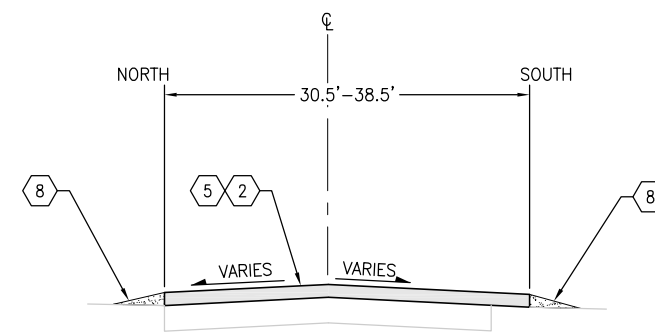

NOTE:
EX ROAD SECTION: VARIES 2"-4", 2" TYPICAL

**SCH B - SE 36TH ST
TYPICAL SECTION**

I
VAR STA 100+32 STA 101+36
NTS

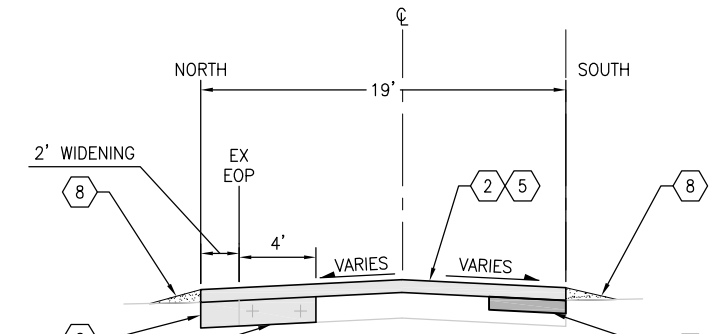

NOTE:
EX ROAD SECTION: VARIES 2"-4", 2" TYPICAL

**SCH B - SE 36TH ST
TYPICAL SECTION**

J
VAR STA 102+50 STA 107+81
NTS



REV. NO.	DATE	DESCRIPTION

BID DOCUMENT



DATE	5/3/2023
DESIGN	CFG
DRAFT	CFG
CHECK	CEM

**CITY OF MERCER ISLAND
2023 RESIDENTIAL STREET OVERLAYS**

TYPICAL SECTIONS

PROJECT	23-16
SCALE	1"=20'
SHEET	3 OF 18

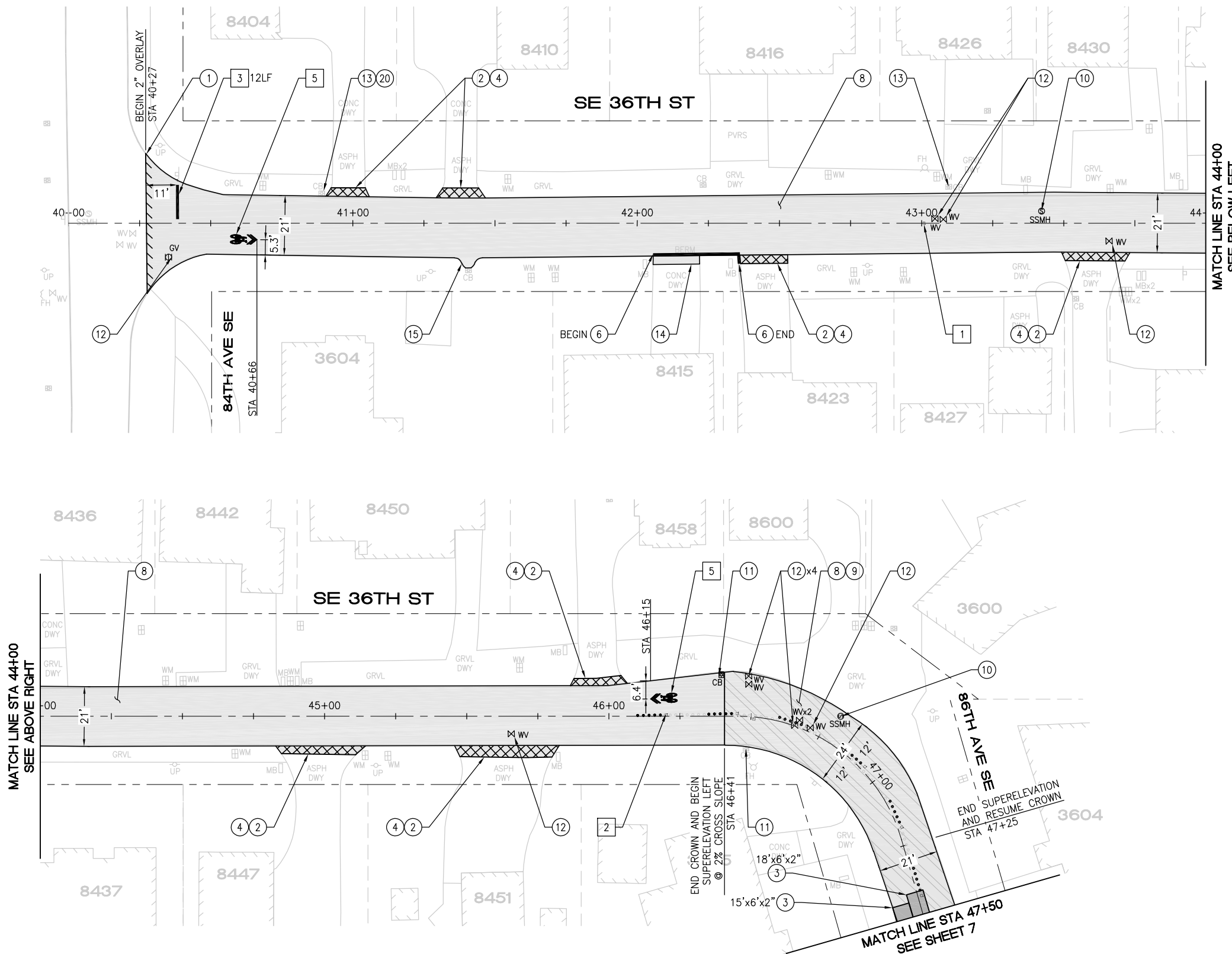

CONSTRUCTION NOTES - MADRONA CREST WEST

- ① BUTT GRIND PAVEMENT PER DTL 2/16
- ② EDGE GRIND DRIVEWAY APPROACH PER DTL 3/16
- ③ REPAIR PAVEMENT PER DTL 7/16, AS FIELD MARKED, W/ HMA FOR PAVEMENT REPAIR CL B
- ④ PAVE DRIVEWAY APPROACH W/ HMA FOR PAVING CL B PER DTL 4/16
- ⑤ PAVE HMA THICKENED EDGE W/ HMA FOR PAVING CL B PER DTL 9/16
- ⑥ PAVE HMA BERM W/ HMA FOR PAVING CL B PER DTL 8/16
- ⑦ PLANE BITUMINOUS PAVEMENT, 2" DEPTH, AS FIELD MARKED, AND PAVE W/ HMA FOR PAVING CL B, 2" DEPTH (TYP)
- ⑧ OVERLAY, 2" DEPTH (TYP), W/ HMA FOR PAVING CL B
- ⑨ PRELEVEL, AS FIELD MARKED, WITH HMA FOR PAVING CL B
- ⑩ INSTALL NEW SEWER MANHOLE RING AND COVER (SUPPLIED BY CITY) AND ADJUST TO GRADE PER DTL 1/17
- ⑪ FURNISH AND INSTALL NEW 18"x24" CATCH BASIN FRAME AND VANED GRATE AND ADJUST TO GRADE PER DTL 1/17
- ⑫ ADJUST VALVE BOX TO GRADE PER DTL 1/17
- ⑬ ADJUST CATCH BASIN TO GRADE PER DTL 1/17
- ⑭ FEATHER DRIVEWAY WITH HMA FOR PAVING CL B
- ⑮ PAVE HMA SPILLWAY TO CB WITH HMA FOR PAVING CL B
- ⑯ PAVE HMA SPEED BUMP W/ HMA FOR PAVING CL B PER DTL 2/18
- ⑰ ADJUST WATER METER BOX TO GRADE PER DTL 1/17
- ⑱ PROFILE GRIND PAVEMENT, AS FIELD MARKED
- ⑲ ADJUST MONUMENT CASE AND COVER PER DTL 1/17
- ⑳ FLIP EXISTING FRAME TO MATCH STANDARD PLAN ORIENTATION

CHANNELIZATION NOTES

- ① PLACE ONE BLUE TYPE 2 RPM AT FIRE HYDRANT (TYP)
- ② APPLY BROKEN CENTER LINE PER DTL 4/17
- ③ APPLY PLASTIC STOP BAR, 12" WHITE, PER DTL 3/17
- ④ APPLY SPEED BUMP SYMBOL, 12" WHITE, PER DTL 2/18
- ⑤ APPLY SHARROW SYMBOL PER DTL MI TRAFFIC STD DTL TR-16

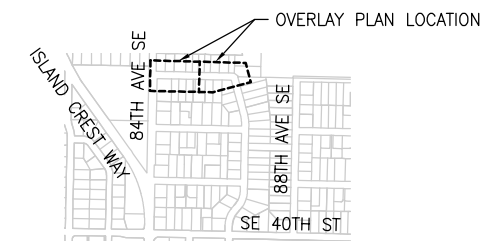

KEY MAP
SCALE: 1" = 800'

SCALE: 1" = 20'



CM DESIGN GROUP
 1318 EAST PIKE ST
 SEATTLE, WA 98122
 (206) 659-0612

REV. NO.	DATE	DESCRIPTION

BID DOCUMENT



DATE	5/3/2023
DESIGN	CFG
DRAFT	CFG
CHECK	CEM

CITY OF MERCER ISLAND
2023 RESIDENTIAL STREET OVERLAYS

SCHEDULE A
MADRONA CREST WEST
SE 36TH ST

PROJECT	23-16
SCALE	1"=20'
SHEET	4 OF 18

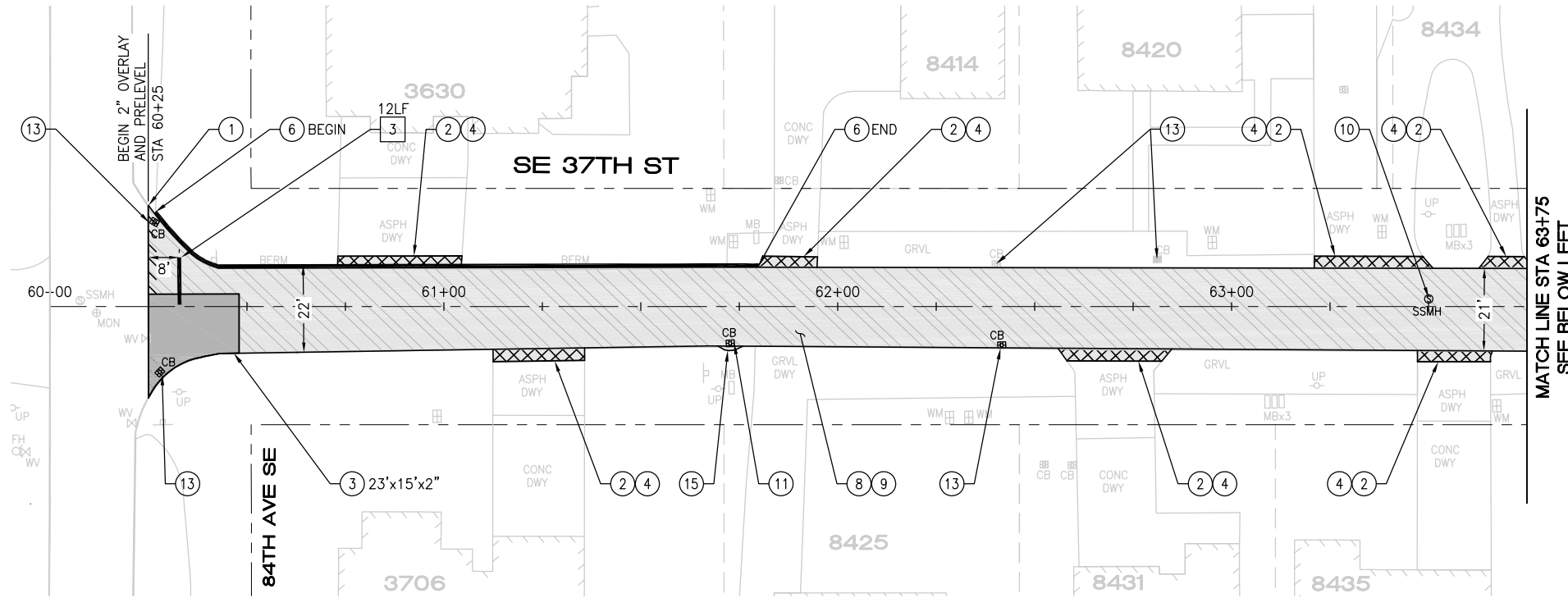

MATCH LINE STA 63+75
SEE BELOW LEFT

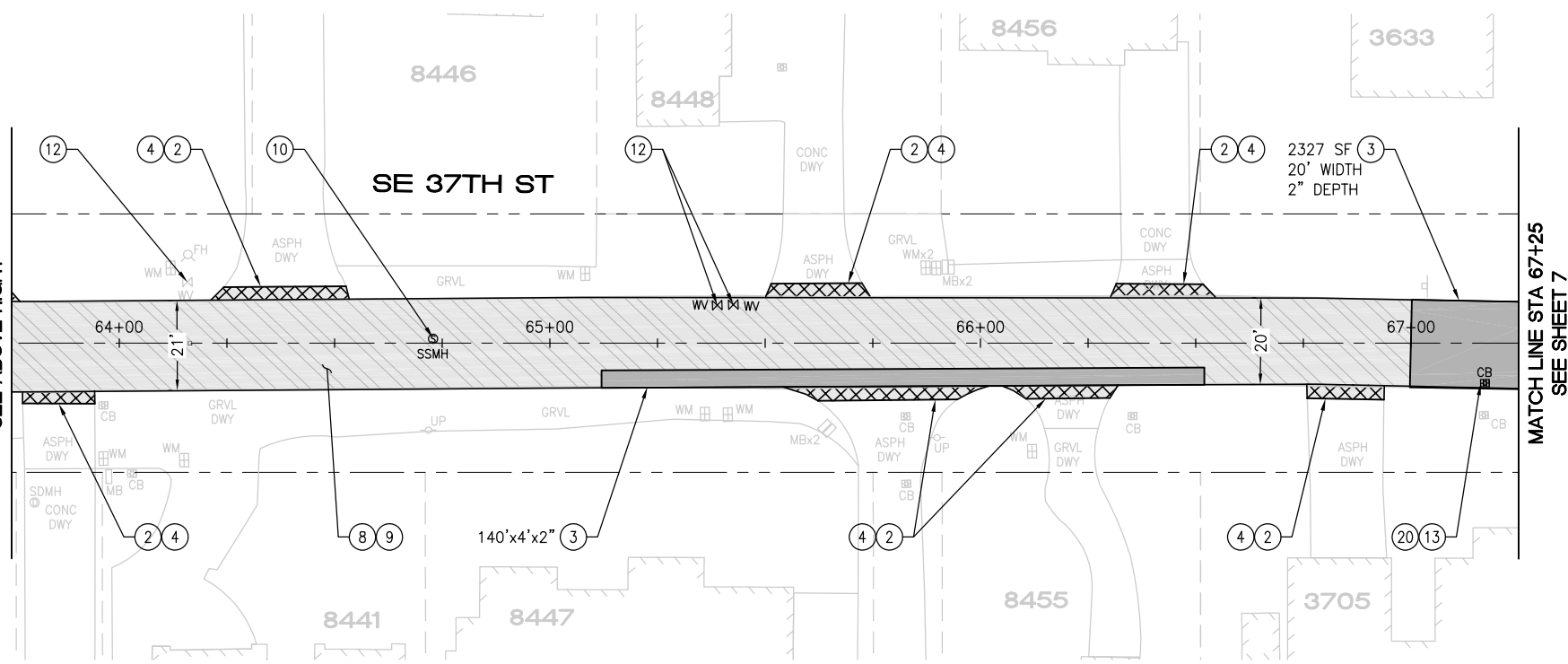

MATCH LINE STA 63+75
SEE ABOVE RIGHT

MATCH LINE STA 67+25
SEE SHEET 7

CONSTRUCTION NOTES - MADRONA CREST WEST

- ① BUTT GRIND PAVEMENT PER DTL 2/16
- ② EDGE GRIND DRIVEWAY APPROACH PER DTL 3/16
- ③ REPAIR PAVEMENT PER DTL 7/16, AS FIELD MARKED, W/ HMA FOR PAVEMENT REPAIR CL B
- ④ PAVE DRIVEWAY APPROACH W/ HMA FOR PAVING CL B PER DTL 4/16
- ⑤ PAVE HMA THICKENED EDGE W/ HMA FOR PAVING CL B PER DTL 9/16
- ⑥ PAVE HMA BERM W/ HMA FOR PAVING CL B PER DTL 8/16
- ⑦ PLANE BITUMINOUS PAVEMENT, 2" DEPTH, AS FIELD MARKED, AND PAVE W/ HMA FOR PAVING CL B, 2" DEPTH (TYP)
- ⑧ OVERLAY, 2" DEPTH (TYP), W/ HMA FOR PAVING CL B
- ⑨ PRELEVEL, AS FIELD MARKED, WITH HMA FOR PAVING CL B
- ⑩ INSTALL NEW SEWER MANHOLE RING AND COVER (SUPPLIED BY CITY) AND ADJUST TO GRADE PER DTL 1/17
- ⑪ FURNISH AND INSTALL NEW 18"x24" CATCH BASIN FRAME AND VANED GRATE AND ADJUST TO GRADE PER DTL 1/17
- ⑫ ADJUST VALVE BOX TO GRADE PER DTL 1/17
- ⑬ ADJUST CATCH BASIN TO GRADE PER DTL 1/17
- ⑭ FEATHER DRIVEWAY WITH HMA FOR PAVING CL B
- ⑮ PAVE HMA SPILLWAY TO CB WITH HMA FOR PAVING CL B
- ⑯ PAVE HMA SPEED BUMP W/ HMA FOR PAVING CL B PER DTL 2/18
- ⑰ ADJUST WATER METER BOX TO GRADE PER DTL 1/17
- ⑱ PROFILE GRIND PAVEMENT, AS FIELD MARKED
- ⑲ ADJUST MONUMENT CASE AND COVER PER DTL 1/17
- ⑳ FLIP EXISTING FRAME TO MATCH STANDARD PLAN ORIENTATION

CHANNELIZATION NOTES

- 1 PLACE ONE BLUE TYPE 2 RPM AT FIRE HYDRANT (TYP)
- 2 APPLY BROKEN CENTER LINE PER DTL 4/17
- 3 APPLY PLASTIC STOP BAR, 12" WHITE, PER DTL 3/17
- 4 APPLY SPEED BUMP SYMBOL, 12" WHITE, PER DTL 2/18
- 5 APPLY SHARROW SYMBOL PER DTL MI TRAFFIC STD DTL TR-16

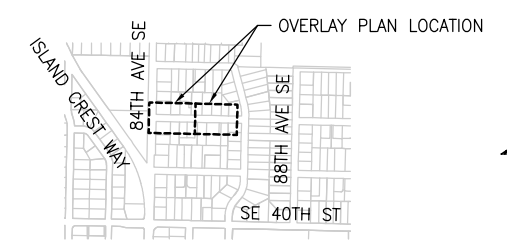

KEY MAP
SCALE: 1" = 800'

SCALE: 1" = 20'



CM DESIGN GROUP
1318 EAST PIKE ST
SEATTLE, WA 98122
(206) 659-0612

REV. NO.	DATE	DESCRIPTION

BID DOCUMENT

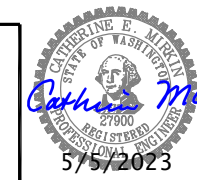

DATE	5/3/2023
DESIGN	CFG
DRAFT	CFG
CHECK	CEM

CITY OF MERCER ISLAND
2023 RESIDENTIAL STREET OVERLAYS

SCHEDULE A
MADRONA CREST WEST
SE 37TH ST

PROJECT	23-16
SCALE	1"=20'
SHEET	5 OF 18

File: Z:\2022 Projects\2023 MI Overlay\Bona\2023 MI Overlay\37TH_39TH_WEST.dwg ID: bennard Date: 05-10-23 2:28:11pm

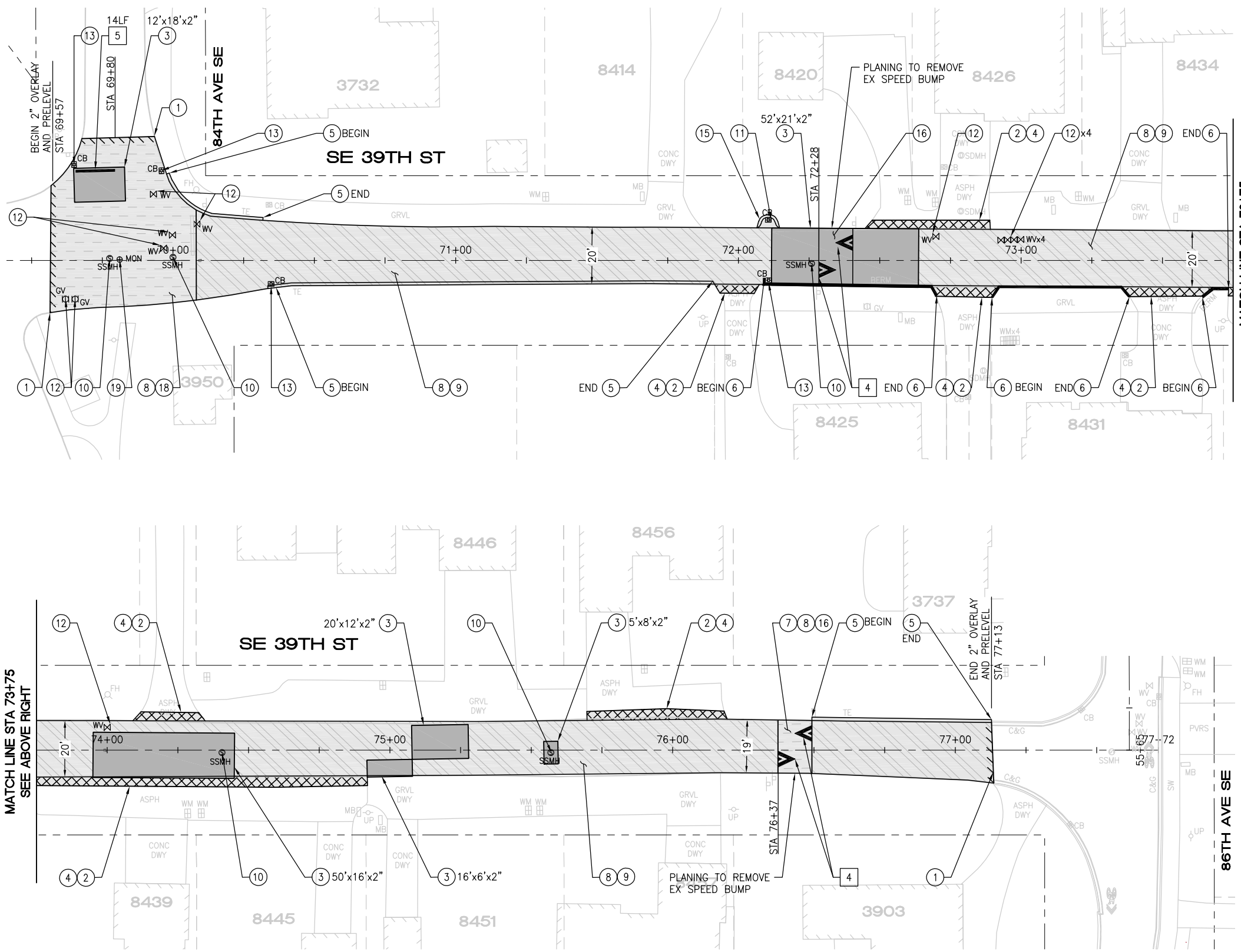

CONSTRUCTION NOTES - MADRONA CREST WEST

- 1 BUTT GRIND PAVEMENT PER DTL 2/16
- 2 EDGE GRIND DRIVEWAY APPROACH PER DTL 3/16
- 3 REPAIR PAVEMENT PER DTL 7/16, AS FIELD MARKED, W/ HMA FOR PAVEMENT REPAIR CL B
- 4 PAVE DRIVEWAY APPROACH W/ HMA FOR PAVING CL B PER DTL 4/16
- 5 PAVE HMA THICKENED EDGE W/ HMA FOR PAVING CL B PER DTL 9/16
- 6 PAVE HMA BERM W/ HMA FOR PAVING CL B PER DTL 8/16
- 7 PLANE BITUMINOUS PAVEMENT, 2" DEPTH, AS FIELD MARKED, AND PAVE W/ HMA FOR PAVING CL B, 2" DEPTH (TYP)
- 8 OVERLAY, 2" DEPTH (TYP), W/ HMA FOR PAVING CL B
- 9 PRELEVEL, AS FIELD MARKED, WITH HMA FOR PAVING CL B
- 10 INSTALL NEW SEWER MANHOLE RING AND COVER (SUPPLIED BY CITY) AND ADJUST TO GRADE PER DTL 1/17
- 11 FURNISH AND INSTALL NEW 18"x24" CATCH BASIN FRAME AND VANED GRATE AND ADJUST TO GRADE PER DTL 1/17
- 12 ADJUST VALVE BOX TO GRADE PER DTL 1/17
- 13 ADJUST CATCH BASIN TO GRADE PER DTL 1/17
- 14 FEATHER DRIVEWAY WITH HMA FOR PAVING CL B
- 15 PAVE HMA SPILLWAY TO CB WITH HMA FOR PAVING CL B
- 16 PAVE HMA SPEED BUMP W/ HMA FOR PAVING CL B PER DTL 2/18
- 17 ADJUST WATER METER BOX TO GRADE PER DTL 1/17
- 18 PROFILE GRIND PAVEMENT, AS FIELD MARKED
- 19 ADJUST MONUMENT CASE AND COVER PER DTL 1/17
- 20 FLIP EXISTING FRAME TO MATCH STANDARD PLAN ORIENTATION

CHANNELIZATION NOTES

- 1 PLACE ONE BLUE TYPE 2 RPM AT FIRE HYDRANT (TYP)
- 2 APPLY BROKEN CENTER LINE PER DTL 4/17
- 3 APPLY PLASTIC STOP BAR, 12" WHITE, PER DTL 3/17
- 4 APPLY SPEED BUMP SYMBOL, 12" WHITE, PER DTL 2/18
- 5 APPLY SHARROW SYMBOL PER DTL MI TRAFFIC STD DTL TR-16



CM DESIGN GROUP
 1318 EAST PIKE ST
 SEATTLE, WA 98122
 (206) 659-0612

REV. NO.	DATE	DESCRIPTION

BID DOCUMENT



DATE	5/3/2023
DESIGN	CFG
DRAFT	CFG
CHECK	CEM

CITY OF MERCER ISLAND
2023 RESIDENTIAL STREET OVERLAYS

SCHEDULE A
 MADRONA CREST WEST
 SE 39TH ST

PROJECT	23-16
SCALE	1"=20'
SHEET	6 OF 18

File: Z:\2022 Projects\2023 MI Overlay\Bona\2023 MI Overlay\39TH_39TH_WEST.dwg ID: benard Date: 05-10-23 2:28:18pm

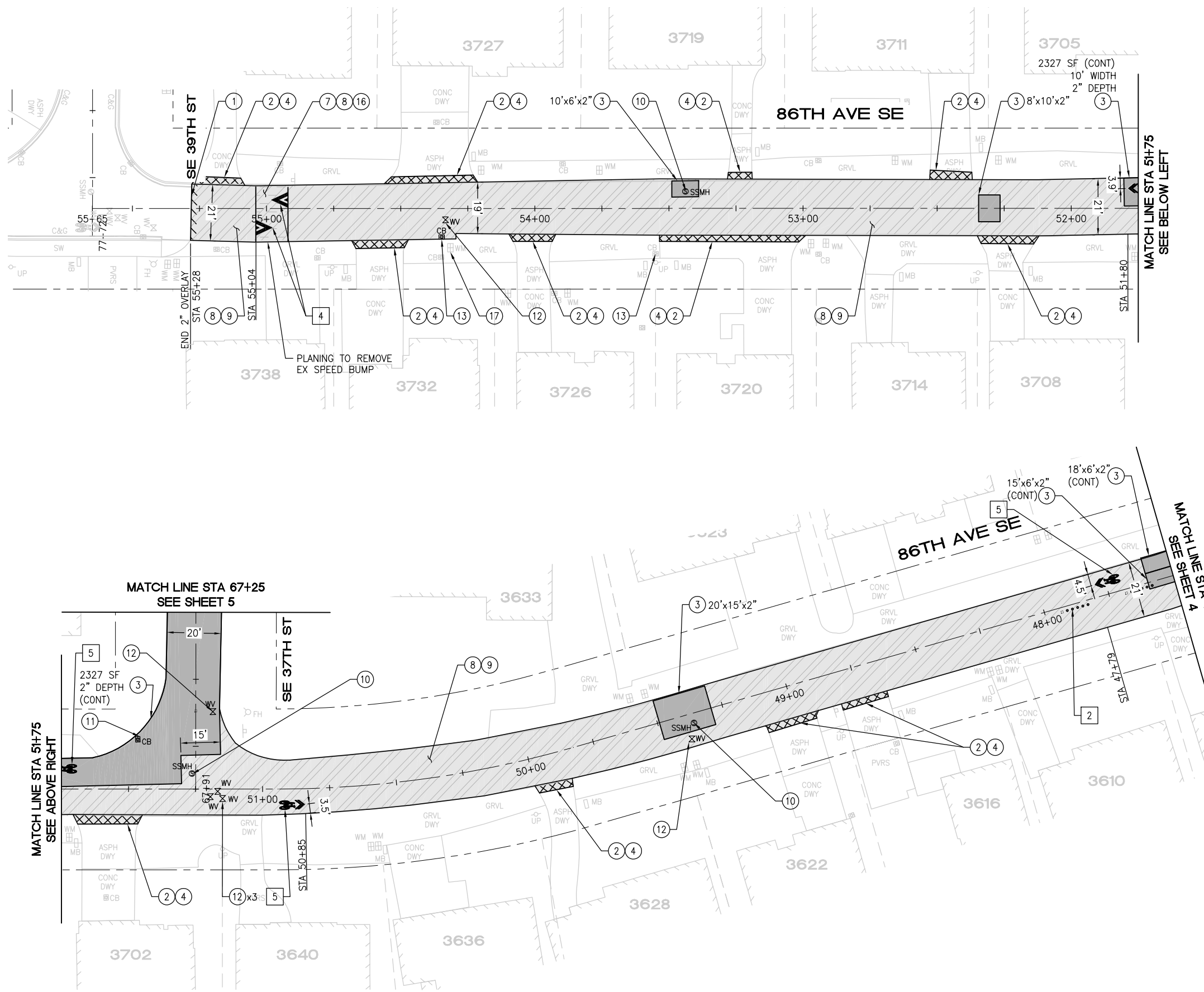

CONSTRUCTION NOTES - MADRONA CREST WEST

- ① BUTT GRIND PAVEMENT PER DTL 2/16
- ② EDGE GRIND DRIVEWAY APPROACH PER DTL 3/16
- ③ REPAIR PAVEMENT PER DTL 7/16, AS FIELD MARKED, W/ HMA FOR PAVEMENT REPAIR CL B
- ④ PAVE DRIVEWAY APPROACH W/ HMA FOR PAVING CL B PER DTL 4/16
- ⑤ PAVE HMA THICKENED EDGE W/ HMA FOR PAVING CL B PER DTL 9/16
- ⑥ PAVE HMA BERM W/ HMA FOR PAVING CL B PER DTL 8/16
- ⑦ PLANE BITUMINOUS PAVEMENT, 2" DEPTH, AS FIELD MARKED, AND PAVE W/ HMA FOR PAVING CL B, 2" DEPTH (TYP)
- ⑧ OVERLAY, 2" DEPTH (TYP), W/ HMA FOR PAVING CL B
- ⑨ PRELEVEL, AS FIELD MARKED, WITH HMA FOR PAVING CL B
- ⑩ INSTALL NEW SEWER MANHOLE RING AND COVER (SUPPLIED BY CITY) AND ADJUST TO GRADE PER DTL 1/17
- ⑪ FURNISH AND INSTALL NEW 18"x24" CATCH BASIN FRAME AND VANED GRATE AND ADJUST TO GRADE PER DTL 1/17
- ⑫ ADJUST VALVE BOX TO GRADE PER DTL 1/17
- ⑬ ADJUST CATCH BASIN TO GRADE PER DTL 1/17
- ⑭ FEATHER DRIVEWAY WITH HMA FOR PAVING CL B
- ⑮ PAVE HMA SPILLWAY TO CB WITH HMA FOR PAVING CL B
- ⑯ PAVE HMA SPEED BUMP W/ HMA FOR PAVING CL B PER DTL 2/18
- ⑰ ADJUST WATER METER BOX TO GRADE PER DTL 1/17
- ⑱ PROFILE GRIND PAVEMENT, AS FIELD MARKED
- ⑲ ADJUST MONUMENT CASE AND COVER PER DTL 1/17
- ⑳ FLIP EXISTING FRAME TO MATCH STANDARD PLAN ORIENTATION

CHANNELIZATION NOTES

- ① PLACE ONE BLUE TYPE 2 RPM AT FIRE HYDRANT (TYP)
- ② APPLY BROKEN CENTER LINE PER DTL 4/17
- ③ APPLY PLASTIC STOP BAR, 12" WHITE, PER DTL 3/17
- ④ APPLY SPEED BUMP SYMBOL, 12" WHITE, PER DTL 2/18
- ⑤ APPLY SHARROW SYMBOL PER DTL MI TRAFFIC STD DTL TR-16



KEY MAP
SCALE: 1" = 800'

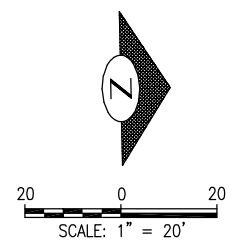

File: Z:\2022 Projects\86th Ave SE Overlay\86th Ave SE Overlay.dwg Date: 05-10-23 2:29:26pm



CM DESIGN GROUP
1318 EAST PIKE ST
SEATTLE, WA 98122
(206) 659-0612

REV. NO.	DATE	DESCRIPTION

BID DOCUMENT



DATE	5/3/2023
DESIGN	CFG
DRAFT	CFG
CHECK	CEM

CITY OF MERCER ISLAND
2023 RESIDENTIAL STREET OVERLAYS

SCHEDULE A
MADRONA CREST WEST
86TH AVE SE

PROJECT	23-16
SCALE	1"=20'
SHEET	7 OF 18

CONSTRUCTION NOTES - MADRONA CREST EAST

- 1 BUTT GRIND PAVEMENT PER DTL 2/16
- 2 EDGE GRIND DRIVEWAY PER DTL 3/16
- 3 REPAIR PAVEMENT PER DTL 7/16, AS FIELD MARKED, W/ HMA FOR PAVEMENT REPAIR CL B
- 4 PAVE DRIVEWAY W/ HMA FOR PAVING CL B PER DTL 4/16
- 5 PAVE HMA THICKENED EDGE W/ HMA FOR PAVING CL B PER DTL 9/16
- 6 PAVE HMA BERM W/ HMA FOR PAVING CL B PER DTL 8/16
- 7 PLANE BITUMINOUS PAVEMENT, AS FIELD MARKED, AND PAVE W/ HMA FOR PAVING CL B, 2" DEPTH (TYP)
- 8 OVERLAY, 2" DEPTH (TYP), W/ HMA FOR PAVING CL B
- 9 PRELEVEL, AS FIELD MARKED, WITH HMA FOR PAVING CL B
- 10 INSTALL NEW SEWER MANHOLE RING AND COVER (SUPPLIED BY CITY) AND ADJUST TO GRADE PER DTL 1/17
- 11 FURNISH AND INSTALL NEW 18"x24" CATCH BASIN FRAME AND VANED GRATE AND ADJUST TO GRADE PER DTL 1/17
- 12 ADJUST VALVE BOX TO GRADE PER DTL 1/17
- 13 ADJUST CATCH BASIN TO GRADE PER DTL 1/17
- 14 ADJUST MONUMENT CASE AND COVER TO GRADE PER DTL 1/17
- 15 ADJUST WATER METER BOX TO GRADE PER DTL 1/17
- 16 PLANE BITUMINOUS PAVEMENT, 3" DEPTH, AS FIELD MARKED, AND PAVE W/ HMA FOR PAVING CL B, 3" DEPTH (TYP)
- 17 WIDEN ROADWAY AS FIELD MARKED W/ HMA FOR PAVING CL B PER HMA RESIDENTIAL ROAD WIDENING DTL 6/16, THEN OVERLAY ROAD W/ HMA FOR PAVING CL B, 2" DEPTH (TYP)
- 18 CONSTRUCT 4" CEM CONC SIDEWALK PER WSDOT STD PLAN F-4-30.10-03 OVER CSTC AS NECESSARY TO PREPARE SUBGRADE
- 19 GRADE AND PAVE HMA TRANSITION FROM SIDEWALK TO ROADWAY W/ 8.3% MAX RUNNING SLOPE AND 2.0% MAX CROSS SLOPE
- 20 FEATHER DRIVEWAY W/ HMA FOR PAVING CL B
- 21 SAWCUT, FULL DEPTH
- 22 INSTALL DWS
- 23 LOWER UTILITY FOR PROFILE GRINDING
- 24 FLIP EXISTING FRAME TO MATCH STANDARD PLAN ORIENTATION
- 25 FURNISH AND INSTALL RECTANGULAR SOLID METAL COVER PER WSDOT STD PLAN B-30.20-04

CHANNELIZATION NOTES

- 1 PLACE ONE BLUE TYPE 2 RPM AT FIRE HYDRANT (TYP)
- 2 APPLY EDGE LINE, 4" PAINT, TWO COATS
- 3 APPLY PLASTIC STOP BAR, 12" WHITE, PER DTL 3/17
- 4 APPLY PLASTIC LEFT ARROW PER DTL 1/18
- 5 APPLY 25 MPH LEGEND PER MI TRAFFIC STD DTL TR-12

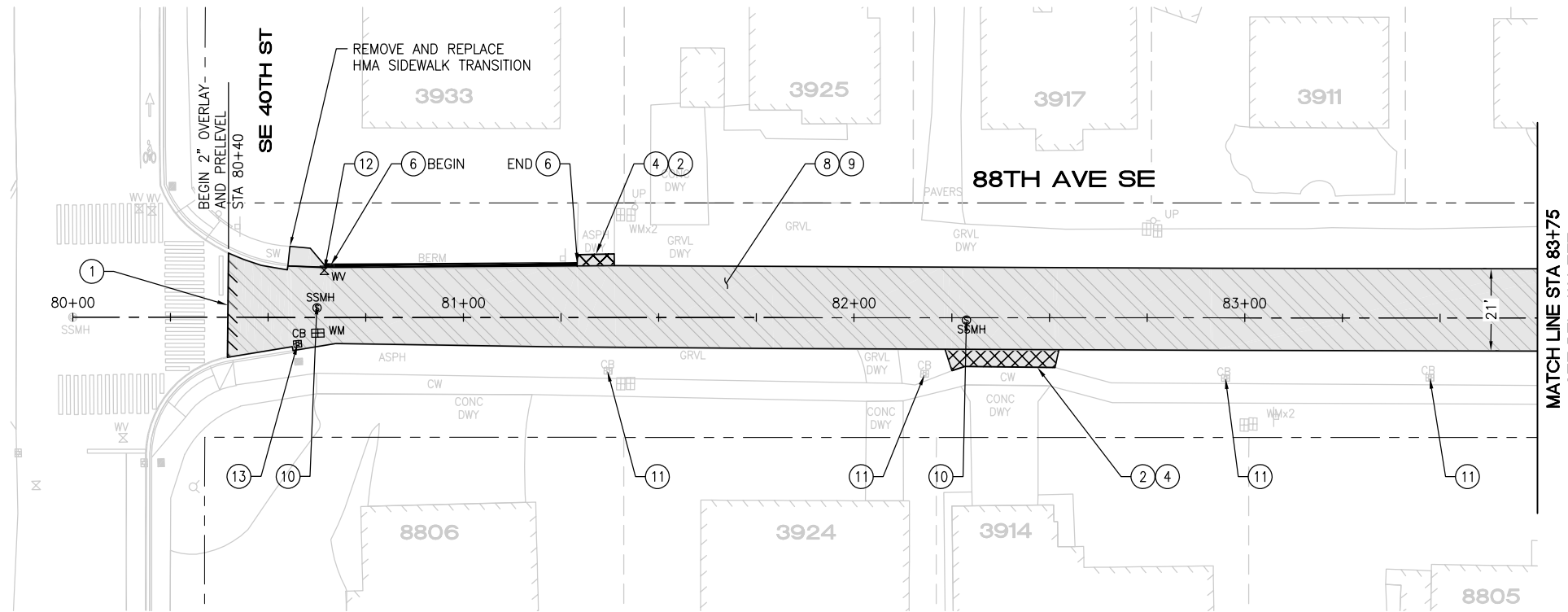

MATCH LINE STA 83+75
SEE BELOW LEFT

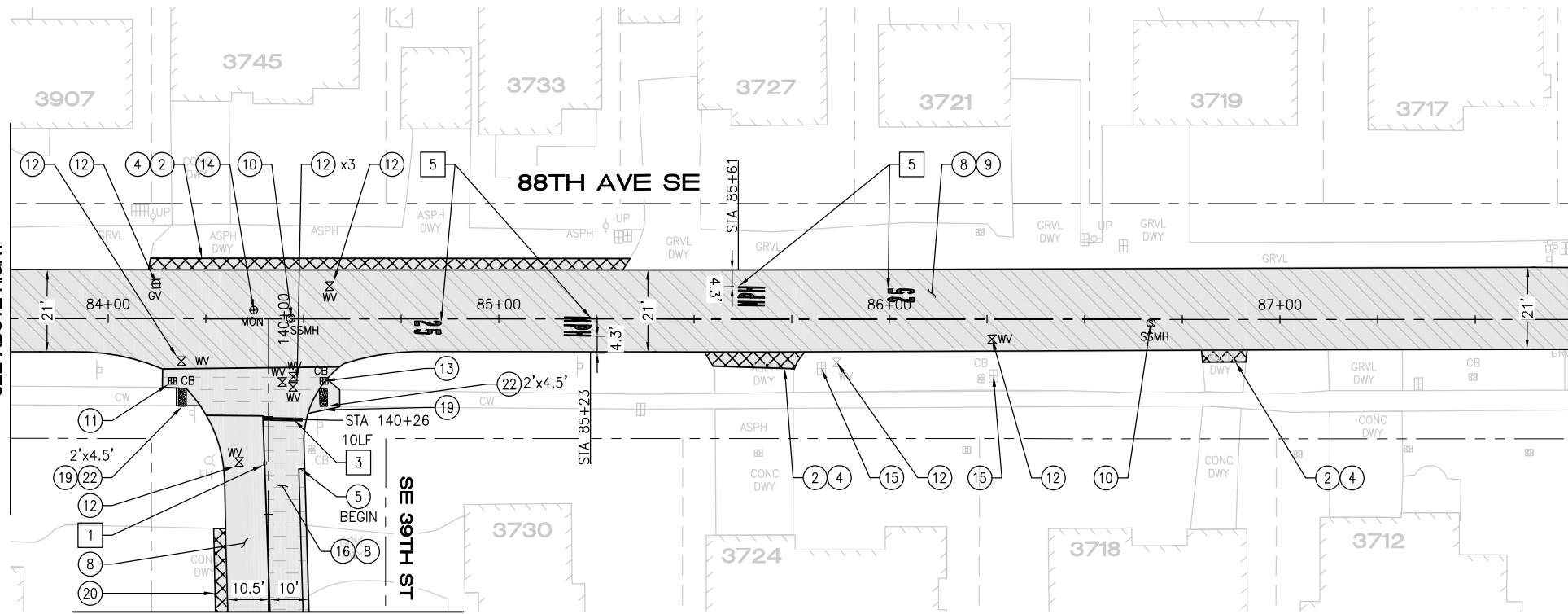

MATCH LINE STA 83+75
SEE ABOVE RIGHT

MATCH LINE STA 87+75
SEE SHEET 9

MATCH LINE STA 140+75
SEE SHEET 12

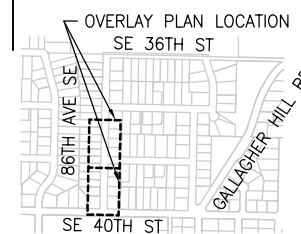

KEY MAP

SCALE: 1" = 800'

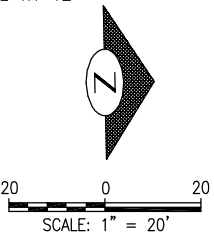

REV. NO. DATE DESCRIPTION

BID DOCUMENT



DATE	5/3/2023
DESIGN	CFG
DRAFT	BDO
CHECK	CEM

CITY OF MERCER ISLAND
2023 RESIDENTIAL STREET OVERLAYS

SCHEDULE B
MADRONA CREST EAST
88TH AVE SE

PROJECT	23-16
SCALE	1"=20'
SHEET	8 OF 18

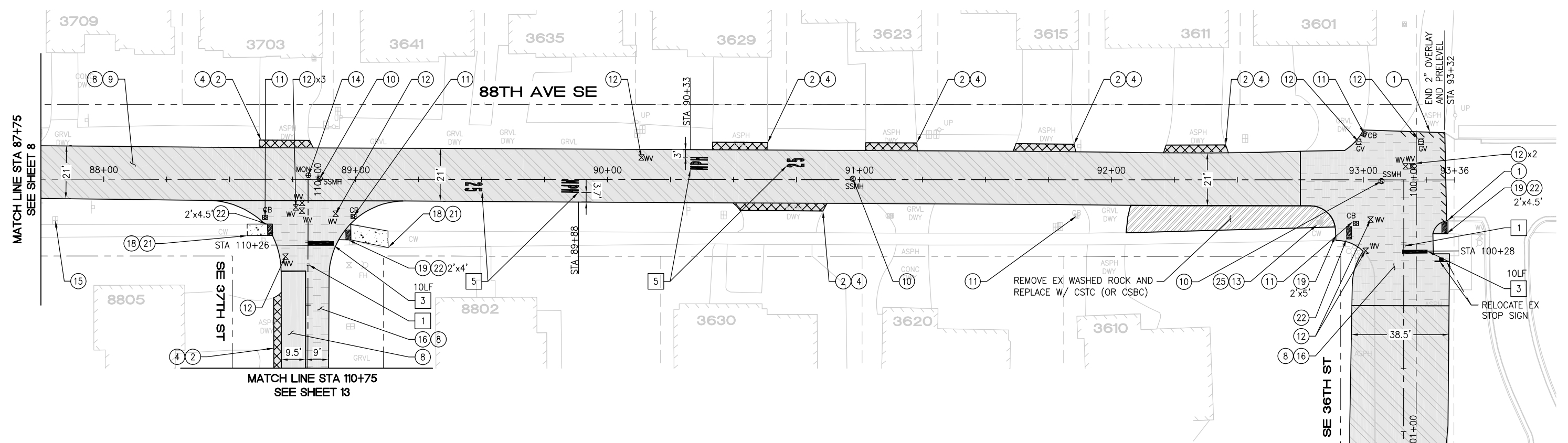

CONSTRUCTION NOTES - MADRONA CREST EAST

- ① BUTT GRIND PAVEMENT PER DTL 2/16
- ② EDGE GRIND DRIVEWAY PER DTL 3/16
- ③ REPAIR PAVEMENT PER DTL 7/16, AS FIELD MARKED, W/ HMA FOR PAVEMENT REPAIR CL B
- ④ PAVE DRIVEWAY W/ HMA FOR PAVING CL B PER DTL 4/16
- ⑤ PAVE HMA THICKENED EDGE W/ HMA FOR PAVING CL B PER DTL 9/16
- ⑥ PAVE HMA BERM W/ HMA FOR PAVING CL B PER DTL 8/16
- ⑦ PLANE BITUMINOUS PAVEMENT, AS FIELD MARKED, AND PAVE W/ HMA FOR PAVING CL B, 2" DEPTH (TYP)
- ⑧ OVERLAY, 2" DEPTH (TYP), W/ HMA FOR PAVING CL B
- ⑨ PRELEVEL, AS FIELD MARKED, WITH HMA FOR PAVING CL B
- ⑩ INSTALL NEW SEWER MANHOLE RING AND COVER (SUPPLIED BY CITY) AND ADJUST TO GRADE PER DTL 1/17
- ⑪ FURNISH AND INSTALL NEW 18"x24" CATCH BASIN FRAME AND VANED GRATE AND ADJUST TO GRADE PER DTL 1/17
- ⑫ ADJUST VALVE BOX TO GRADE PER DTL 1/17
- ⑬ ADJUST CATCH BASIN TO GRADE PER DTL 1/17
- ⑭ ADJUST MONUMENT CASE AND COVER TO GRADE PER DTL 1/17
- ⑮ ADJUST WATER METER BOX TO GRADE PER DTL 1/17
- ⑯ PLANE BITUMINOUS PAVEMENT, 3" DEPTH, AS FIELD MARKED, AND PAVE W/ HMA FOR PAVING CL B, 3" DEPTH (TYP)
- ⑰ WIDEN ROADWAY AS FIELD MARKED W/ HMA FOR PAVING CL B PER HMA RESIDENTIAL ROAD WIDENING DTL 6/16, THEN OVERLAY ROAD W/ HMA FOR PAVING CL B, 2" DEPTH (TYP)
- ⑱ CONSTRUCT 4" CEM CONC SIDEWALK PER WSDOT STD PLAN F-4-30.10-03 OVER CSTC AS NECESSARY TO PREPARE SUBGRADE
- ⑲ GRADE AND PAVE HMA TRANSITION FROM SIDEWALK TO ROADWAY W/ 8.3% MAX RUNNING SLOPE AND 2.0% MAX CROSS SLOPE
- ⑳ FEATHER DRIVEWAY W/ HMA FOR PAVING CL B
- ㉑ SAWCUT, FULL DEPTH
- ㉒ INSTALL DWS
- ㉓ LOWER UTILITY FOR PROFILE GRINDING
- ㉔ FLIP EXISTING FRAME TO MATCH STANDARD PLAN ORIENTATION
- ㉕ FURNISH AND INSTALL RECTANGULAR SOLID METAL COVER PER WSDOT STD PLAN B-30.20-04

CHANNELIZATION NOTES

- ① PLACE ONE BLUE TYPE 2 RPM AT FIRE HYDRANT (TYP)
- ② APPLY EDGE LINE, 4" PAINT, TWO COATS
- ③ APPLY PLASTIC STOP BAR, 12" WHITE, PER DTL 3/17
- ④ APPLY PLASTIC LEFT ARROW PER DTL 1/18
- ⑤ APPLY 25 MPH LEGEND PER MI TRAFFIC STD DTL TR-12

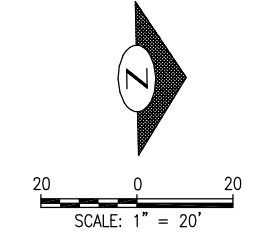
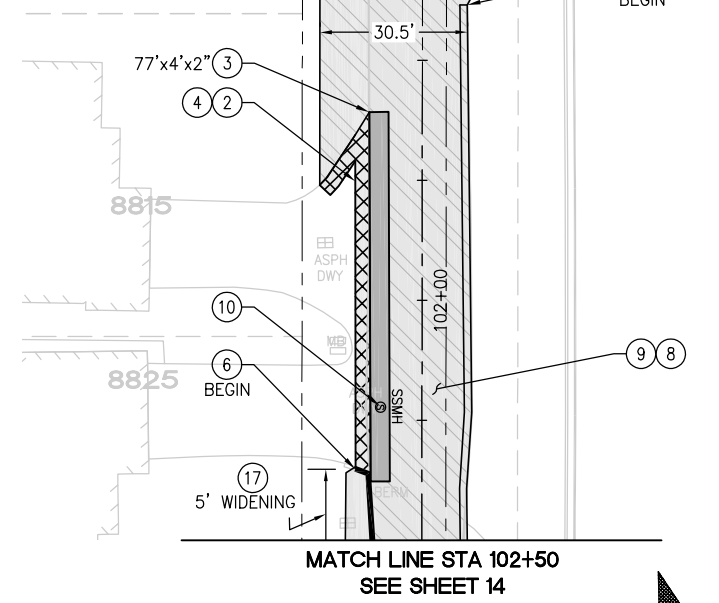
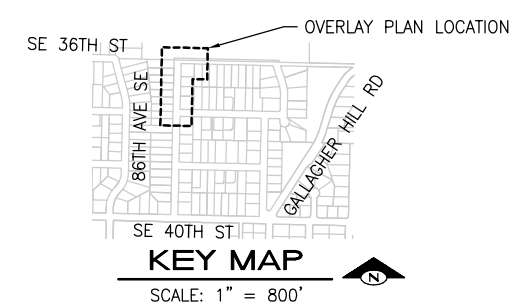

File: Z:\2022 Projects\Bona\2023_MI_Overlay\Bona\2023_MI_Overlay_36TH_37TH_38TH_EAST.dwg, ID: bennard Date: 05-May-23, 2:29:45pm



REV. NO.	DATE	DESCRIPTION

BID DOCUMENT



DATE	5/3/2023
DESIGN	CFG
DRAFT	BDO
CHECK	CEM

CITY OF MERCER ISLAND
2023 RESIDENTIAL STREET OVERLAYS

SCHEDULE B
 MADRONA CREST EAST
 88TH AVE SE

PROJECT	23-16
SCALE	1"=20'
SHEET	9 OF 18

CONSTRUCTION NOTES - MADRONA CREST EAST

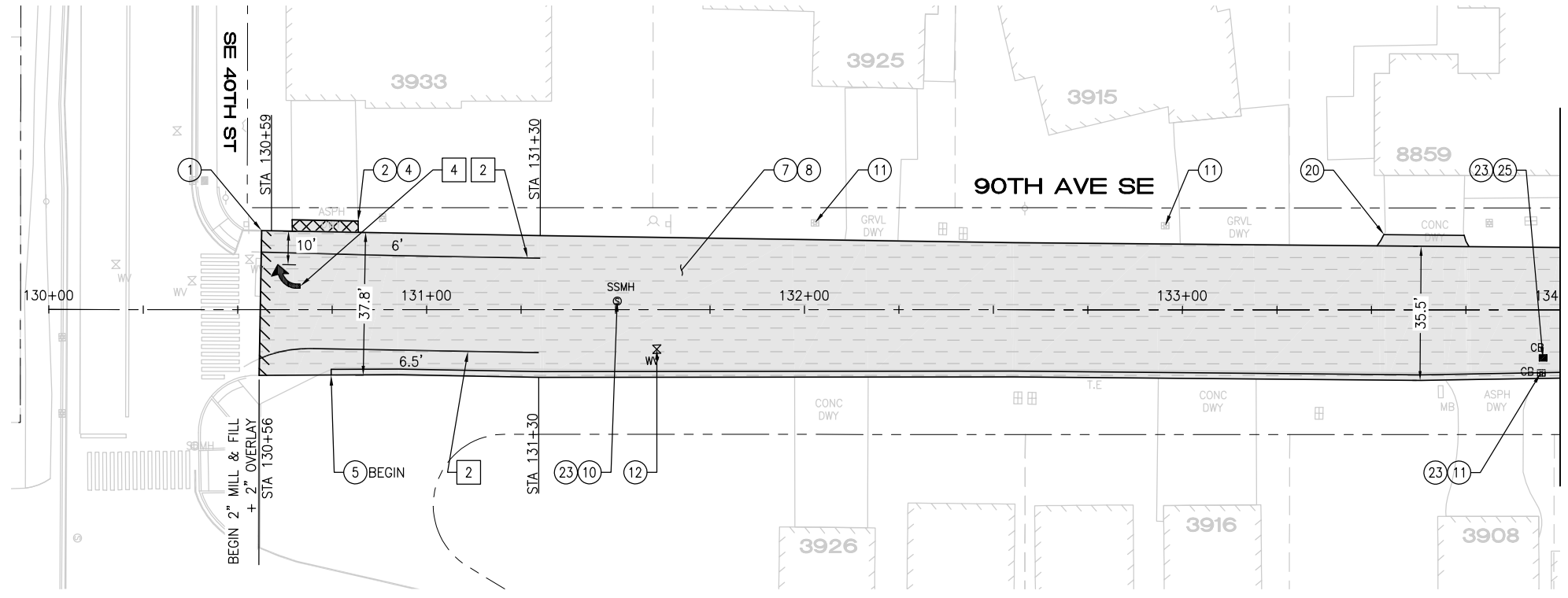

MATCH LINE STA 134+00
SEE BELOW LEFT

- 1 BUTT GRIND PAVEMENT PER DTL 2/16
- 2 EDGE GRIND DRIVEWAY PER DTL 3/16
- 3 REPAIR PAVEMENT PER DTL 7/16, AS FIELD MARKED, W/ HMA FOR PAVEMENT REPAIR CL B
- 4 PAVE DRIVEWAY W/ HMA FOR PAVING CL B PER DTL 4/16
- 5 PAVE HMA THICKENED EDGE W/ HMA FOR PAVING CL B PER DTL 9/16
- 6 PAVE HMA BERM W/ HMA FOR PAVING CL B PER DTL 8/16
- 7 PLANE BITUMINOUS PAVEMENT, AS FIELD MARKED, AND PAVE W/ HMA FOR PAVING CL B, 2" DEPTH (TYP)
- 8 OVERLAY, 2" DEPTH (TYP), W/ HMA FOR PAVING CL B
- 9 PRELEVEL, AS FIELD MARKED, WITH HMA FOR PAVING CL B
- 10 INSTALL NEW SEWER MANHOLE RING AND COVER (SUPPLIED BY CITY) AND ADJUST TO GRADE PER DTL 1/17
- 11 FURNISH AND INSTALL NEW 18"x24" CATCH BASIN FRAME AND VANED GRATE AND ADJUST TO GRADE PER DTL 1/17
- 12 ADJUST VALVE BOX TO GRADE PER DTL 1/17
- 13 ADJUST CATCH BASIN TO GRADE PER DTL 1/17
- 14 ADJUST MONUMENT CASE AND COVER TO GRADE PER DTL 1/17
- 15 ADJUST WATER METER BOX TO GRADE PER DTL 1/17
- 16 PLANE BITUMINOUS PAVEMENT, 3" DEPTH, AS FIELD MARKED, AND PAVE W/ HMA FOR PAVING CL B, 3" DEPTH (TYP)
- 17 WIDEN ROADWAY AS FIELD MARKED W/ HMA FOR PAVING CL B PER HMA RESIDENTIAL ROAD WIDENING DTL 6/16, THEN OVERLAY ROAD W/ HMA FOR PAVING CL B, 2" DEPTH (TYP)
- 18 CONSTRUCT 4" CEM CONC SIDEWALK PER WSDOT STD PLAN F-4-30.10-03 OVER CSTC AS NECESSARY TO PREPARE SUBGRADE
- 19 GRADE AND PAVE HMA TRANSITION FROM SIDEWALK TO ROADWAY W/ 8.3% MAX RUNNING SLOPE AND 2.0% MAX CROSS SLOPE
- 20 FEATHER DRIVEWAY W/ HMA FOR PAVING CL B
- 21 SAWCUT, FULL DEPTH
- 22 INSTALL DWS
- 23 LOWER UTILITY FOR PROFILE GRINDING
- 24 FLIP EXISTING FRAME TO MATCH STANDARD PLAN ORIENTATION
- 25 FURNISH AND INSTALL RECTANGULAR SOLID METAL COVER PER WSDOT STD PLAN B-30.20-04

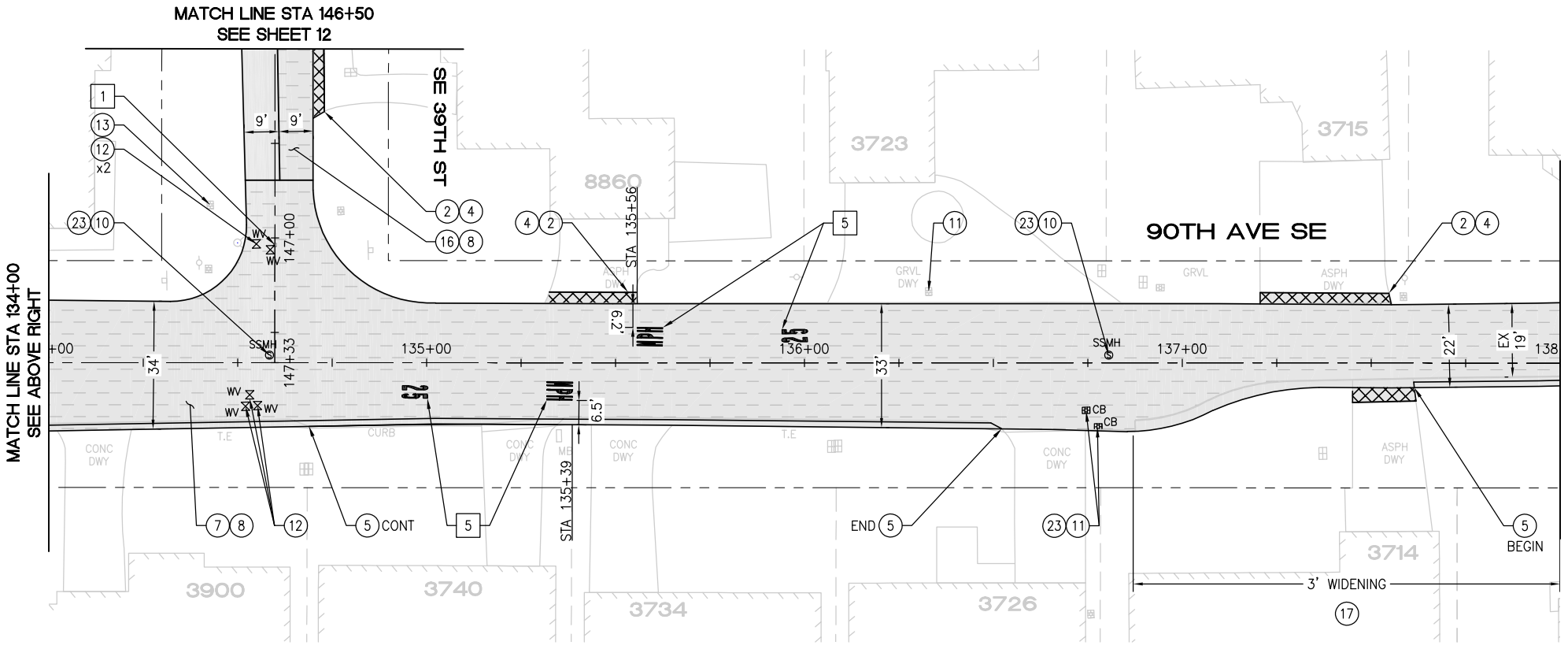

MATCH LINE STA 134+00
SEE ABOVE RIGHT

MATCH LINE STA 138+00
SEE SHEET 11

CHANNELIZATION NOTES

- 1 PLACE ONE BLUE TYPE 2 RPM AT FIRE HYDRANT (TYP)
- 2 APPLY EDGE LINE, 4" PAINT, TWO COATS
- 3 APPLY PLASTIC STOP BAR, 12" WHITE, PER DTL 3/17
- 4 APPLY PLASTIC LEFT ARROW PER DTL 1/18
- 5 APPLY 25 MPH LEGEND PER MI TRAFFIC STD DTL TR-12



KEY MAP
SCALE: 1" = 800'

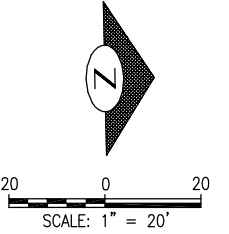

File: Z:\2022 Projects\2012 2023 M1 Overlay\Bona\2012 2023 M1 Overlay\36TH_37TH_39TH_EAST.dwg ID: bernard Date: 05-May-23 2:29:53pm



CM DESIGN GROUP
1318 EAST PIKE ST
SEATTLE, WA 98122
(206) 659-0612

REV. NO.	DATE	DESCRIPTION

BID DOCUMENT



DATE	5/3/2023
DESIGN	CFG
DRAFT	BDO
CHECK	CEM

CITY OF MERCER ISLAND
2023 RESIDENTIAL STREET OVERLAYS

SCHEDULE A
MADRONA CREST EAST
90TH AVE SE

PROJECT	23-16
SCALE	1" = 20'
SHEET	10 OF 18

MATCH LINE STA 116+50
SEE SHEET 13

CONSTRUCTION NOTES - MADRONA CREST EAST

- ① BUTT GRIND PAVEMENT PER DTL 2/16
- ② EDGE GRIND DRIVEWAY PER DTL 3/16
- ③ REPAIR PAVEMENT PER DTL 7/16, AS FIELD MARKED, W/ HMA FOR PAVEMENT REPAIR CL B
- ④ PAVE DRIVEWAY W/ HMA FOR PAVING CL B PER DTL 4/16
- ⑤ PAVE HMA THICKENED EDGE W/ HMA FOR PAVING CL B PER DTL 9/16
- ⑥ PAVE HMA BERM W/ HMA FOR PAVING CL B PER DTL 8/16
- ⑦ PLANE BITUMINOUS PAVEMENT, AS FIELD MARKED, AND PAVE W/ HMA FOR PAVING CL B, 2" DEPTH (TYP)
- ⑧ OVERLAY, 2" DEPTH (TYP), W/ HMA FOR PAVING CL B
- ⑨ PRELEVEL, AS FIELD MARKED, WITH HMA FOR PAVING CL B
- ⑩ INSTALL NEW SEWER MANHOLE RING AND COVER (SUPPLIED BY CITY) AND ADJUST TO GRADE PER DTL 1/17
- ⑪ FURNISH AND INSTALL NEW 18"x24" CATCH BASIN FRAME AND VANED GRATE AND ADJUST TO GRADE PER DTL 1/17
- ⑫ ADJUST VALVE BOX TO GRADE PER DTL 1/17
- ⑬ ADJUST CATCH BASIN TO GRADE PER DTL 1/17
- ⑭ ADJUST MONUMENT CASE AND COVER TO GRADE PER DTL 1/17
- ⑮ ADJUST WATER METER BOX TO GRADE PER DTL 1/17
- ⑯ PLANE BITUMINOUS PAVEMENT, 3" DEPTH, AS FIELD MARKED, AND PAVE W/ HMA FOR PAVING CL B, 3" DEPTH (TYP)
- ⑰ WIDEN ROADWAY AS FIELD MARKED W/ HMA FOR PAVING CL B PER HMA RESIDENTIAL ROAD WIDENING DTL 6/16, THEN OVERLAY ROAD W/ HMA FOR PAVING CL B, 2" DEPTH (TYP)
- ⑱ CONSTRUCT 4" CEM CONC SIDEWALK PER WSDOT STD PLAN F-4-30.10-03 OVER CSTC AS NECESSARY TO PREPARE SUBGRADE
- ⑲ GRADE AND PAVE HMA TRANSITION FROM SIDEWALK TO ROADWAY W/ 8.3% MAX RUNNING SLOPE AND 2.0% MAX CROSS SLOPE
- ⑳ FEATHER DRIVEWAY W/ HMA FOR PAVING CL B
- ㉑ SAWCUT, FULL DEPTH
- ㉒ INSTALL DWS
- ㉓ LOWER UTILITY FOR PROFILE GRINDING
- ㉔ FLIP EXISTING FRAME TO MATCH STANDARD PLAN ORIENTATION
- ㉕ FURNISH AND INSTALL RECTANGULAR SOLID METAL COVER PER WSDOT STD PLAN B-30.20-04

CHANNELIZATION NOTES

- 1 PLACE ONE BLUE TYPE 2 RPM AT FIRE HYDRANT (TYP)
- 2 APPLY EDGE LINE, 4" PAINT, TWO COATS
- 3 APPLY PLASTIC STOP BAR, 12" WHITE, PER DTL 3/17
- 4 APPLY PLASTIC LEFT ARROW PER DTL 1/18
- 5 APPLY 25 MPH LEGEND PER MI TRAFFIC STD DTL TR-12

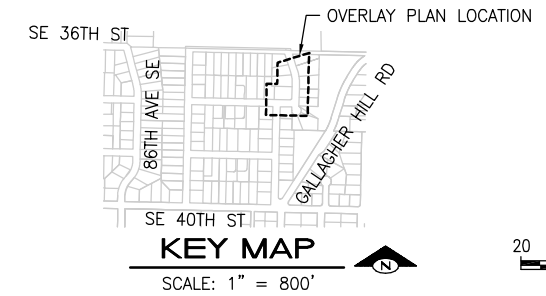
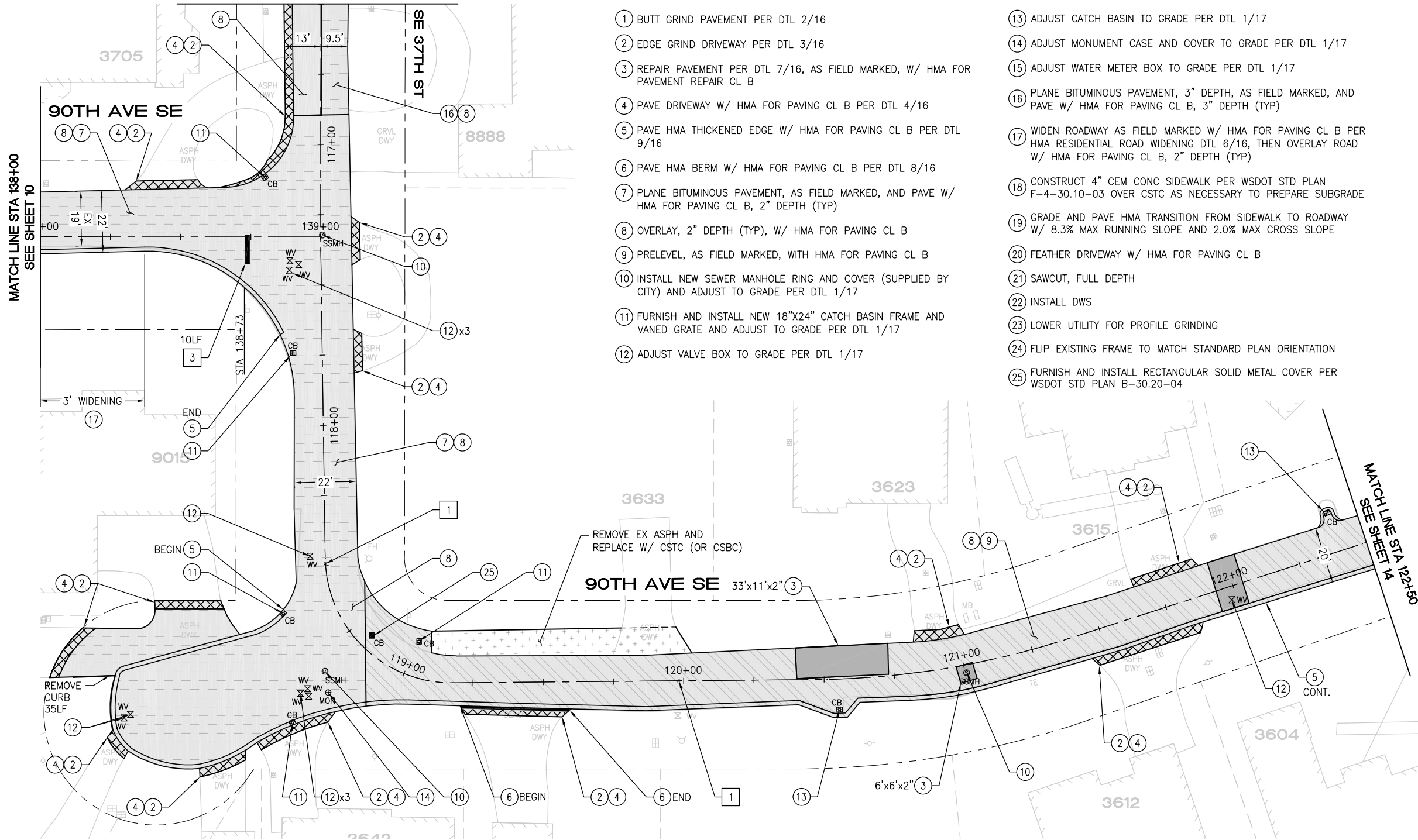

REV. NO.	DATE	DESCRIPTION

BID DOCUMENT

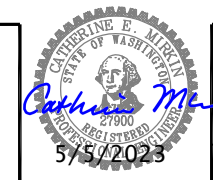

DATE	5/3/2023
DESIGN	CFG
DRAFT	BDO
CHECK	CEM

CITY OF MERCER ISLAND
2023 RESIDENTIAL STREET OVERLAYS

SCHEDULE B
MADRONA CREST EAST
90TH AVE SE

PROJECT	23-16
SCALE	1"=20'
SHEET	11 OF 18

File: Z:\2022 Projects\Bona\2023_MI_Overlay\Bona\2023_MI_Overlay\37th_39th_EAST.dwg ID: bernard Date: 05-May-23 2:30:03pm

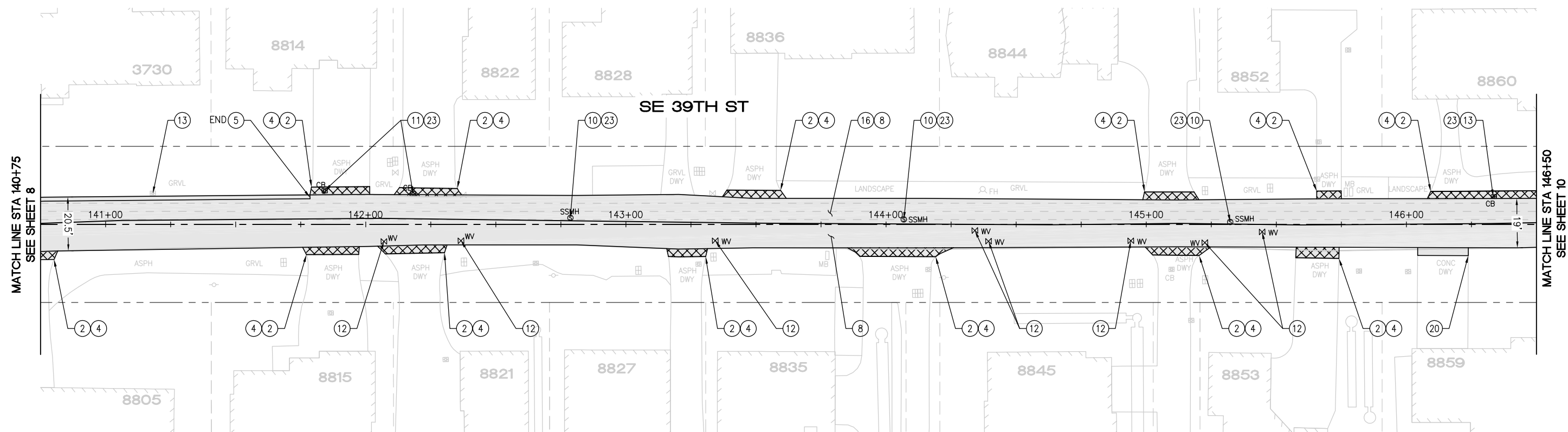

MATCH LINE STA 140+75
SEE SHEET 8

MATCH LINE STA 146+50
SEE SHEET 10

CONSTRUCTION NOTES - MADRONA CREST EAST

- ① BUTT GRIND PAVEMENT PER DTL 2/16
- ② EDGE GRIND DRIVEWAY PER DTL 3/16
- ③ REPAIR PAVEMENT PER DTL 7/16, AS FIELD MARKED, W/ HMA FOR PAVEMENT REPAIR CL B
- ④ PAVE DRIVEWAY W/ HMA FOR PAVING CL B PER DTL 4/16
- ⑤ PAVE HMA THICKENED EDGE W/ HMA FOR PAVING CL B PER DTL 9/16
- ⑥ PAVE HMA BERM W/ HMA FOR PAVING CL B PER DTL 8/16
- ⑦ PLANE BITUMINOUS PAVEMENT, AS FIELD MARKED, AND PAVE W/ HMA FOR PAVING CL B, 2" DEPTH (TYP)
- ⑧ OVERLAY, 2" DEPTH (TYP), W/ HMA FOR PAVING CL B
- ⑨ PRELEVEL, AS FIELD MARKED, WITH HMA FOR PAVING CL B
- ⑩ INSTALL NEW SEWER MANHOLE RING AND COVER (SUPPLIED BY CITY) AND ADJUST TO GRADE PER DTL 1/17
- ⑪ FURNISH AND INSTALL NEW 18"x24" CATCH BASIN FRAME AND VANED GRATE AND ADJUST TO GRADE PER DTL 1/17
- ⑫ ADJUST VALVE BOX TO GRADE PER DTL 1/17
- ⑬ ADJUST CATCH BASIN TO GRADE PER DTL 1/17
- ⑭ ADJUST MONUMENT CASE AND COVER TO GRADE PER DTL 1/17
- ⑮ ADJUST WATER METER BOX TO GRADE PER DTL 1/17
- ⑯ PLANE BITUMINOUS PAVEMENT, 3" DEPTH, AS FIELD MARKED, AND PAVE W/ HMA FOR PAVING CL B, 3" DEPTH (TYP)
- ⑰ WIDEN ROADWAY AS FIELD MARKED W/ HMA FOR PAVING CL B PER HMA RESIDENTIAL ROAD WIDENING DTL 6/16, THEN OVERLAY ROAD W/ HMA FOR PAVING CL B, 2" DEPTH (TYP)
- ⑱ CONSTRUCT 4" CEM CONC SIDEWALK PER WSDOT STD PLAN F-4-30.10-03 OVER CSTC AS NECESSARY TO PREPARE SUBGRADE
- ⑲ GRADE AND PAVE HMA TRANSITION FROM SIDEWALK TO ROADWAY W/ 8.3% MAX RUNNING SLOPE AND 2.0% MAX CROSS SLOPE
- ⑳ FEATHER DRIVEWAY W/ HMA FOR PAVING CL B
- ㉑ SAWCUT, FULL DEPTH
- ㉒ INSTALL DWS
- ㉓ LOWER UTILITY FOR PROFILE GRINDING
- ㉔ FLIP EXISTING FRAME TO MATCH STANDARD PLAN ORIENTATION
- ㉕ FURNISH AND INSTALL RECTANGULAR SOLID METAL COVER PER WSDOT STD PLAN B-30.20-04

CHANNELIZATION NOTES

- 1 PLACE ONE BLUE TYPE 2 RPM AT FIRE HYDRANT (TYP)
- 2 APPLY EDGE LINE, 4" PAINT, TWO COATS
- 3 APPLY PLASTIC STOP BAR, 12" WHITE, PER DTL 3/17
- 4 APPLY PLASTIC LEFT ARROW PER DTL 1/18
- 5 APPLY 25 MPH LEGEND PER MI TRAFFIC STD DTL TR-12

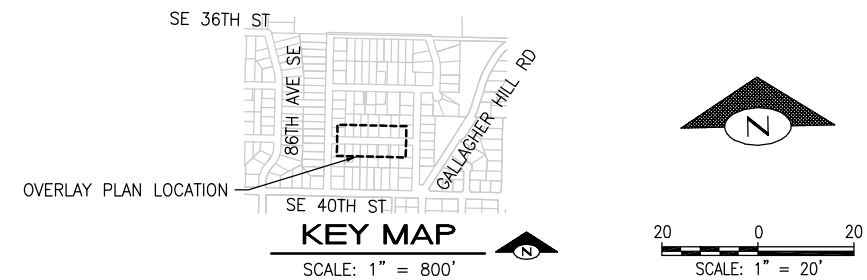

REV. NO.	DATE	DESCRIPTION

BID DOCUMENT



DATE	5/3/2023
DESIGN	CFG
DRAFT	BDO
CHECK	CEM

CITY OF MERCER ISLAND
2023 RESIDENTIAL STREET OVERLAYS
 SCHEDULE B
 MADRONA CREST EAST
 SE 39TH ST

PROJECT	23-16
SCALE	1"=20'
SHEET	12 OF 18

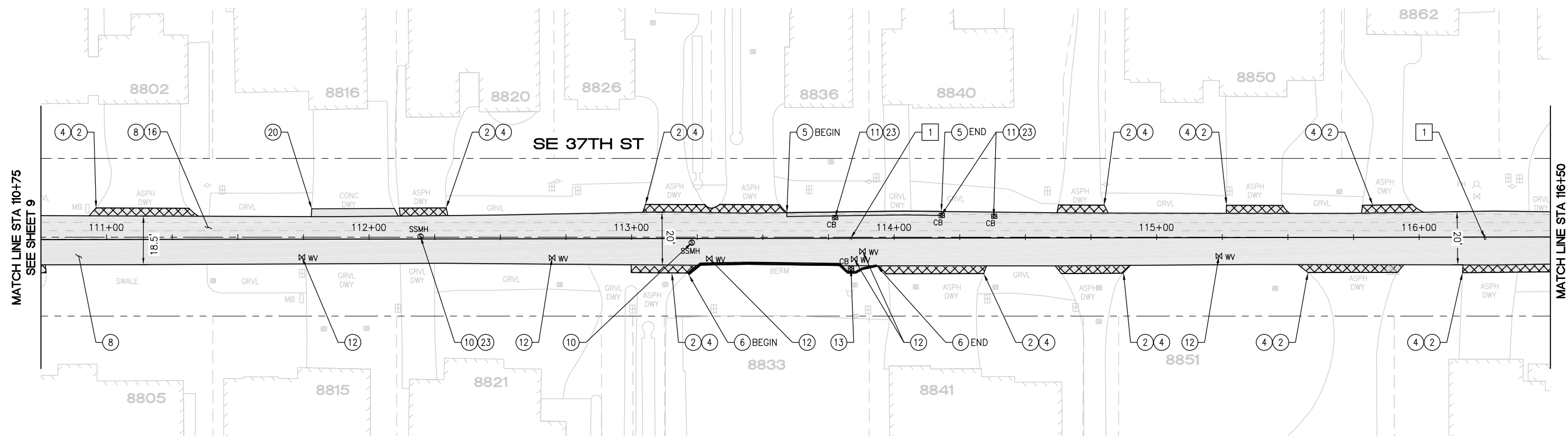

CONSTRUCTION NOTES - MADRONA CREST EAST

- | | |
|--|---|
| <ul style="list-style-type: none"> ① BUTT GRIND PAVEMENT PER DTL 2/16 ② EDGE GRIND DRIVEWAY PER DTL 3/16 ③ REPAIR PAVEMENT PER DTL 7/16, AS FIELD MARKED, W/ HMA FOR PAVEMENT REPAIR CL B ④ PAVE DRIVEWAY W/ HMA FOR PAVING CL B PER DTL 4/16 ⑤ PAVE HMA THICKENED EDGE W/ HMA FOR PAVING CL B PER DTL 9/16 ⑥ PAVE HMA BERM W/ HMA FOR PAVING CL B PER DTL 8/16 ⑦ PLANE BITUMINOUS PAVEMENT, AS FIELD MARKED, AND PAVE W/ HMA FOR PAVING CL B, 2" DEPTH (TYP) ⑧ OVERLAY, 2" DEPTH (TYP), W/ HMA FOR PAVING CL B ⑨ PRELEVEL, AS FIELD MARKED, WITH HMA FOR PAVING CL B ⑩ INSTALL NEW SEWER MANHOLE RING AND COVER (SUPPLIED BY CITY) AND ADJUST TO GRADE PER DTL 1/17 ⑪ FURNISH AND INSTALL NEW 18"x24" CATCH BASIN FRAME AND VANED GRATE AND ADJUST TO GRADE PER DTL 1/17 ⑫ ADJUST VALVE BOX TO GRADE PER DTL 1/17 | <ul style="list-style-type: none"> ⑬ ADJUST CATCH BASIN TO GRADE PER DTL 1/17 ⑭ ADJUST MONUMENT CASE AND COVER TO GRADE PER DTL 1/17 ⑮ ADJUST WATER METER BOX TO GRADE PER DTL 1/17 ⑯ PLANE BITUMINOUS PAVEMENT, 3" DEPTH, AS FIELD MARKED, AND PAVE W/ HMA FOR PAVING CL B, 3" DEPTH (TYP) ⑰ WIDEN ROADWAY AS FIELD MARKED W/ HMA FOR PAVING CL B PER HMA RESIDENTIAL ROAD WIDENING DTL 6/16, THEN OVERLAY ROAD W/ HMA FOR PAVING CL B, 2" DEPTH (TYP) ⑱ CONSTRUCT 4" CEM CONC SIDEWALK PER WSDOT STD PLAN F-4-30.10-03 OVER CSTC AS NECESSARY TO PREPARE SUBGRADE ⑲ GRADE AND PAVE HMA TRANSITION FROM SIDEWALK TO ROADWAY W/ 8.3% MAX RUNNING SLOPE AND 2.0% MAX CROSS SLOPE ⑳ FEATHER DRIVEWAY W/ HMA FOR PAVING CL B ㉑ SAWCUT, FULL DEPTH ㉒ INSTALL DWS ㉓ LOWER UTILITY FOR PROFILE GRINDING ㉔ FLIP EXISTING FRAME TO MATCH STANDARD PLAN ORIENTATION ㉕ FURNISH AND INSTALL RECTANGULAR SOLID METAL COVER PER WSDOT STD PLAN B-30.20-04 |
|--|---|

CHANNELIZATION NOTES

- 1 PLACE ONE BLUE TYPE 2 RPM AT FIRE HYDRANT (TYP)
- 2 APPLY EDGE LINE, 4" PAINT, TWO COATS
- 3 APPLY PLASTIC STOP BAR, 12" WHITE, PER DTL 3/17
- 4 APPLY PLASTIC LEFT ARROW PER DTL 1/18
- 5 APPLY 25 MPH LEGEND PER MI TRAFFIC STD DTL TR-12

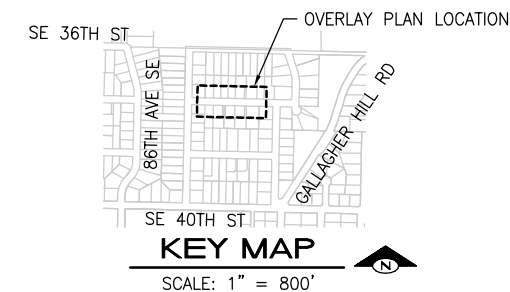

REV. NO.	DATE	DESCRIPTION

BID DOCUMENT



DATE	5/3/2023
DESIGN	CFG
DRAFT	BDO
CHECK	CEM

CITY OF MERCER ISLAND
2023 RESIDENTIAL STREET OVERLAYS
 SCHEDULE B
 MADRONA CREST EAST
 SE 37TH ST

PROJECT	23-16
SCALE	1"=20'
SHEET	13 OF 18

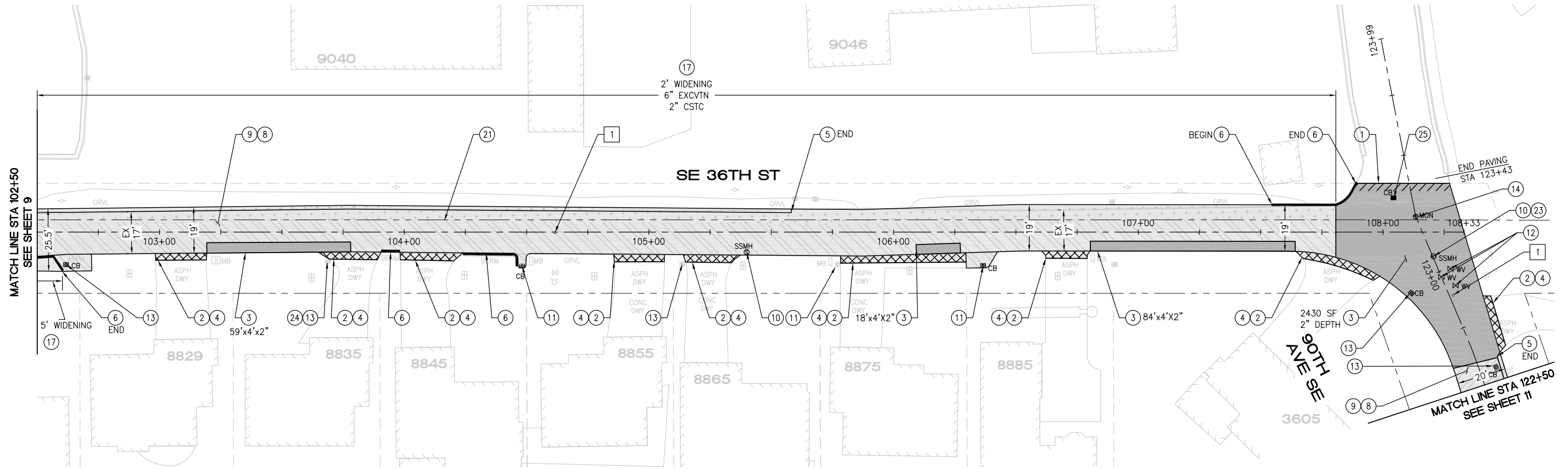

CONSTRUCTION NOTES - MADRONA CREST EAST

- 1 BUTT GRIND PAVEMENT PER DTL 2/16
- 2 EDGE GRIND DRIVEWAY PER DTL 3/16
- 3 REPAIR PAVEMENT PER DTL 7/16, AS FIELD MARKED, W/ HMA FOR PAVEMENT REPAIR CL B
- 4 PAVE DRIVEWAY W/ HMA FOR PAVING CL B PER DTL 4/16
- 5 PAVE HMA THICKENED EDGE W/ HMA FOR PAVING CL B PER DTL 9/16
- 6 PAVE HMA BERM W/ HMA FOR PAVING CL B PER DTL 8/16
- 7 PLANE BITUMINOUS PAVEMENT, AS FIELD MARKED, AND PAVE W/ HMA FOR PAVING CL B, 2" DEPTH (TYP)
- 8 OVERLAY, 2" DEPTH (TYP), W/ HMA FOR PAVING CL B
- 9 PRELEVEL, AS FIELD MARKED, WITH HMA FOR PAVING CL B
- 10 INSTALL NEW SEWER MANHOLE RING AND COVER (SUPPLIED BY CITY) AND ADJUST TO GRADE PER DTL 1/17
- 11 FURNISH AND INSTALL NEW 18"x24" CATCH BASIN FRAME AND VANED GRATE AND ADJUST TO GRADE PER DTL 1/17
- 12 ADJUST VALVE BOX TO GRADE PER DTL 1/17
- 13 ADJUST CATCH BASIN TO GRADE PER DTL 1/17
- 14 ADJUST MONUMENT CASE AND COVER TO GRADE PER DTL 1/17
- 15 ADJUST WATER METER BOX TO GRADE PER DTL 1/17
- 16 PLANE BITUMINOUS PAVEMENT, 3" DEPTH, AS FIELD MARKED, AND PAVE W/ HMA FOR PAVING CL B, 3" DEPTH (TYP)
- 17 WIDEN ROADWAY AS FIELD MARKED W/ HMA FOR PAVING CL B PER HMA RESIDENTIAL ROAD WIDENING DTL 6/16, THEN OVERLAY ROAD W/ HMA FOR PAVING CL B, 2" DEPTH (TYP)
- 18 CONSTRUCT 4" CEM CONC SIDEWALK PER WSDOT STD PLAN F-4-30.10-03 OVER CSTC AS NECESSARY TO PREPARE SUBGRADE
- 19 GRADE AND PAVE HMA TRANSITION FROM SIDEWALK TO ROADWAY W/ 8.3% MAX RUNNING SLOPE AND 2.0% MAX CROSS SLOPE
- 20 FEATHER DRIVEWAY W/ HMA FOR PAVING CL B
- 21 SAWCUT, FULL DEPTH
- 22 INSTALL DWS
- 23 LOWER UTILITY FOR PROFILE GRINDING
- 24 FLIP EXISTING FRAME TO MATCH STANDARD PLAN ORIENTATION
- 25 FURNISH AND INSTALL RECTANGULAR SOLID METAL COVER PER WSDOT STD PLAN B-30.20-04

CHANNELIZATION NOTES

- 1 PLACE ONE BLUE TYPE 2 RPM AT FIRE HYDRANT (TYP)
- 2 APPLY EDGE LINE, 4" PAINT, TWO COATS
- 3 APPLY PLASTIC STOP BAR, 12" WHITE, PER DTL 3/17
- 4 APPLY PLASTIC LEFT ARROW PER DTL 1/18
- 5 APPLY 25 MPH LEGEND PER MI TRAFFIC STD DTL TR-12

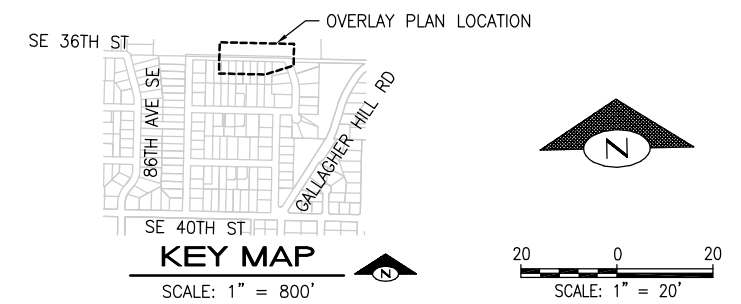

REV. NO.	DATE	DESCRIPTION

BID DOCUMENT



DATE	5/3/2023
DESIGN	CFG
DRAFT	BDO
CHECK	CEM

CITY OF MERCER ISLAND
2023 RESIDENTIAL STREET OVERLAYS

SCHEDULE B
 MADRONA CREST EAST
 SE 36TH ST

PROJECT	23-16
SCALE	1"=20'
SHEET	14 OF 18

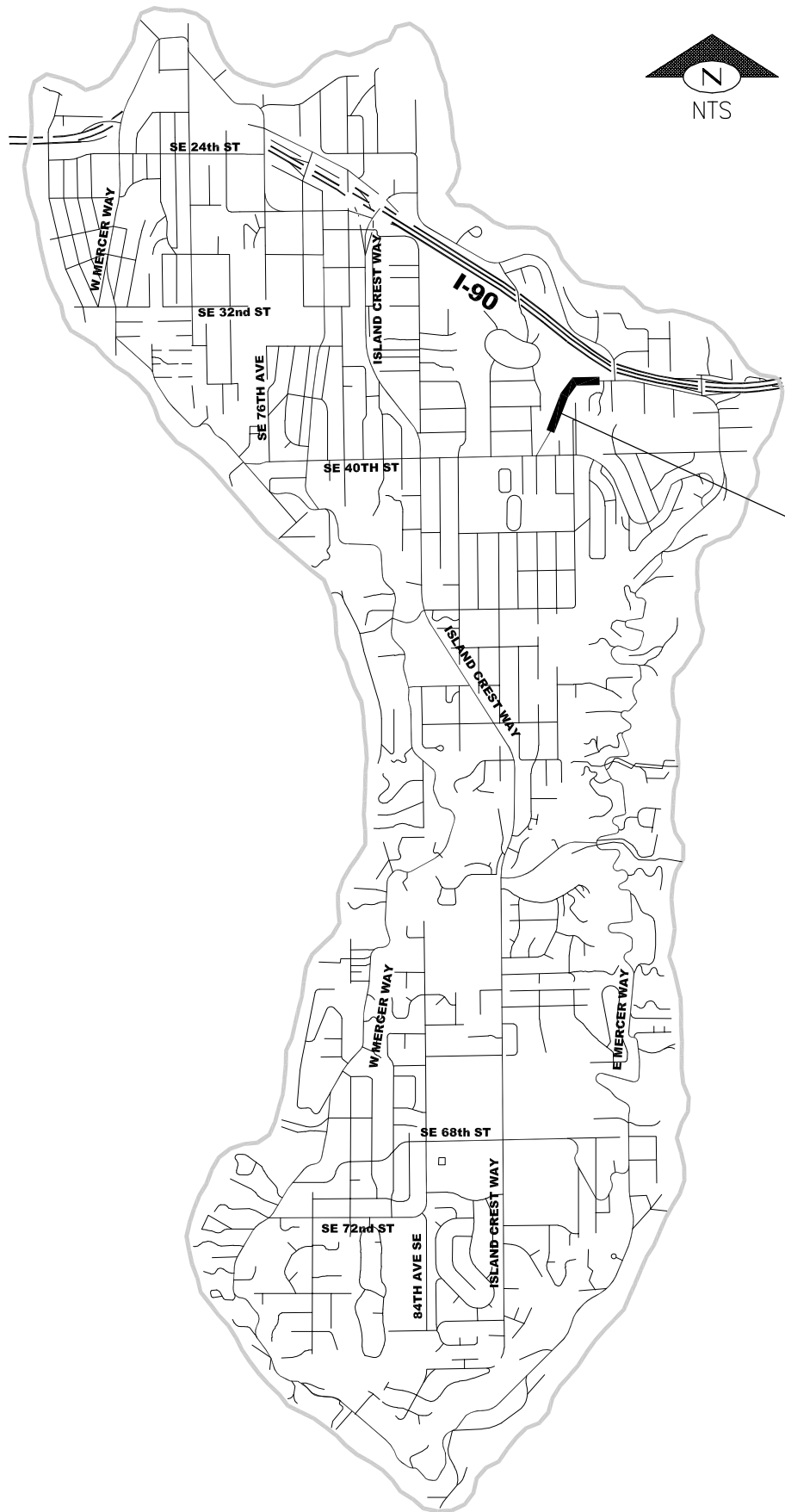

SCHEDULE C - PAVEMENT REPAIRS (VARIOUS LOCATIONS)

LOCATION	ADDRESS	LANE	DESCRIPTION	LENGTH (LF)	WIDTH (FT)	DEPTH (IN)	PAVEMENT REPAIR (SY)	HMA FOR PAVEMENT REPAIR CL 1/2" (TON)	UTILITY QTY (EA)	NOTES
1	3900 GALLAGHER HILL ROAD	SB	ADJUST CB						1 CB	
2	3620 GALLAGHER HILL ROAD	NB	PAVEMENT REPAIR	285	14	4	443	101		
3	3952 GALLAGHER HILL ROAD	NB	INSTALL NEW MH RING & COVER						1 SSMH	
4	9201 SE 36TH STREET	WB	INSTALL NEW MH RING & COVER						1 SSMH	
5	9271 SE 36TH STREET	EB	PAVEMENT REPAIR	100	14	2	156	18		

LOCATION 1-5

File: Z:\2022 Projects\2012 2023 Mt Overlays\Bona\2012_P-04\Y-4RTI-PTD4.dwg ID: bennard Date: 05-May-23 2:30:42pm



REV. NO.	DATE	DESCRIPTION

BID DOCUMENT



DATE	5/3/2023
DESIGN	CFG
DRAFT	CFG
CHECK	CEM

CITY OF MERCER ISLAND
2023 RESIDENTIAL STREET OVERLAYS
 SCHEDULE C
 PAVEMENT REPAIRS (VARIOUS LOCATIONS)

PROJECT	23-16
SCALE	NONE
SHEET	15 OF 18

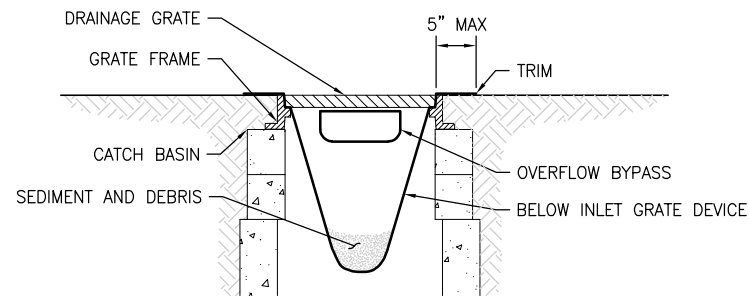

NOTES:

1. SIZE THE BELOW INLET GRATE DEVICE (BIGD) FOR THE STORM WATER STRUCTURE IT WILL SERVICE.
2. THE BIGD SHALL HAVE A BUILT-IN HIGH-FLOW RELIEF SYSTEM (OVERFLOW BYPASS).
3. THE RETRIEVAL SYSTEM MUST ALLOW REMOVAL OF THE BIGD WITHOUT SPILLING THE COLLECTED MATERIAL.

1 INLET PROTECTION
NTS

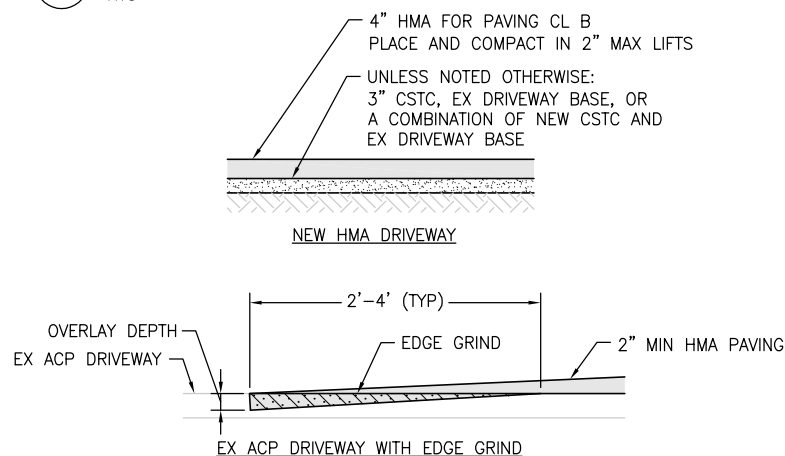

4 HMA DRIVEWAY
NTS

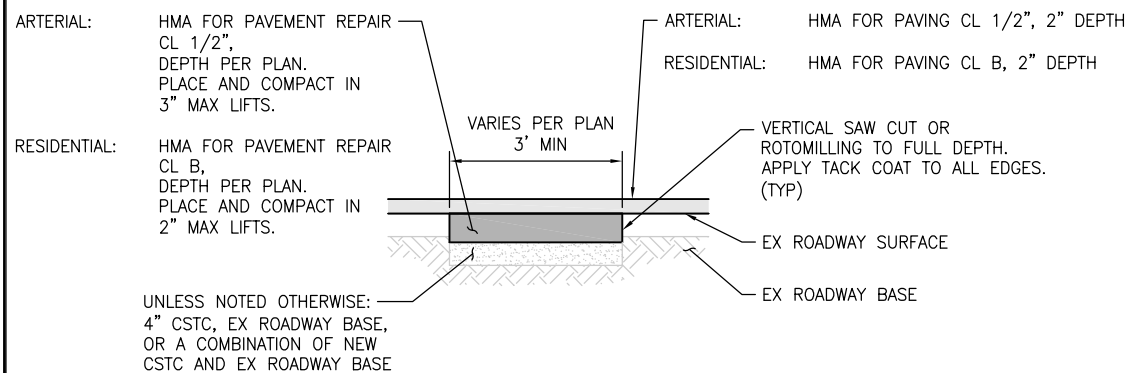

- NOTES:
1. REMOVE SUBGRADE UNTIL SUITABLE MATERIAL IS REACHED OR AS DIRECTED BY ENGINEER.
 2. CSTC OR CSBC MAY BE OMITTED BY ENGINEER.

7 TYPICAL HMA PAVEMENT REPAIR AND PAVING
NTS

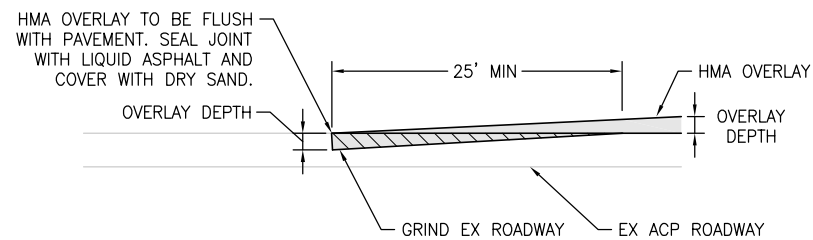

2 BUTT JOINT PLANING
NTS

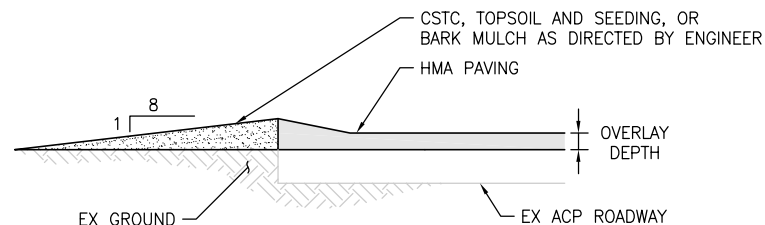

WITH THICKENED EDGE

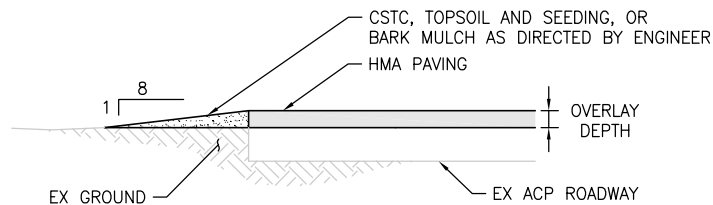

WITHOUT THICKENED EDGE

5 EDGE RESTORATION
NTS

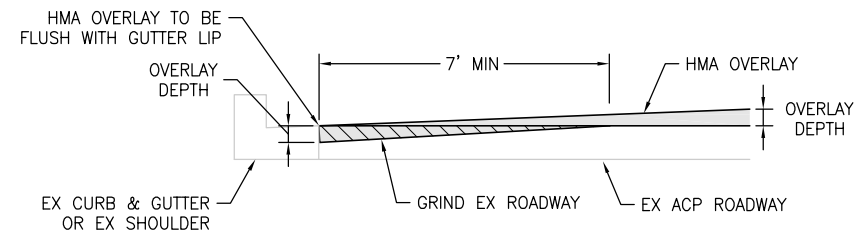

3 EDGE GRIND
NTS

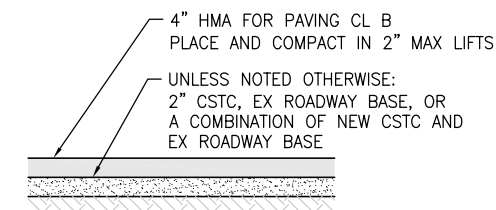

6 HMA RESIDENTIAL ROAD WIDENING
NTS

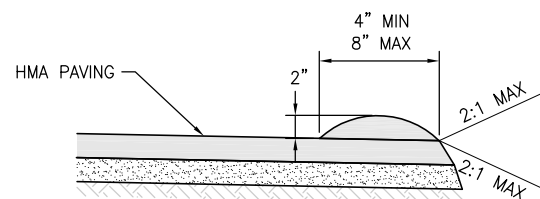

8 HMA BERM
NTS

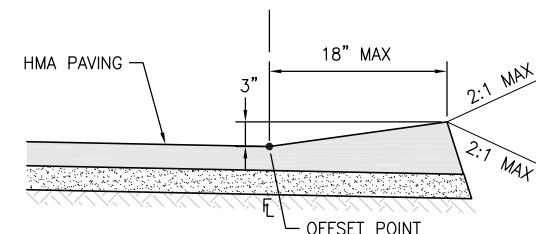

9 HMA THICKENED EDGE
NTS



REV. NO.	DATE	DESCRIPTION

BID DOCUMENT



DATE	5/3/2023
DESIGN	CFG
DRAFT	CFG
CHECK	CEM

CITY OF MERCER ISLAND
2023 RESIDENTIAL STREET OVERLAYS

DETAILS

PROJECT	23-16
SCALE	1"=20'
SHEET	16 OF 18

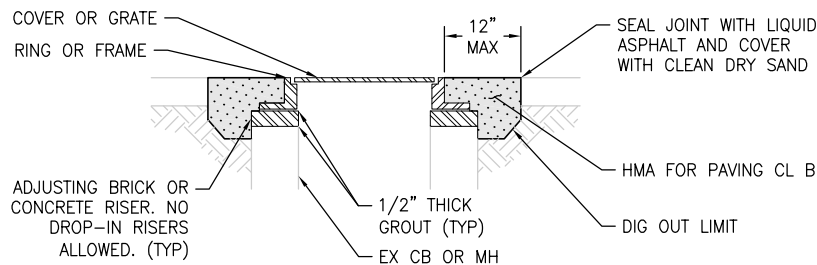
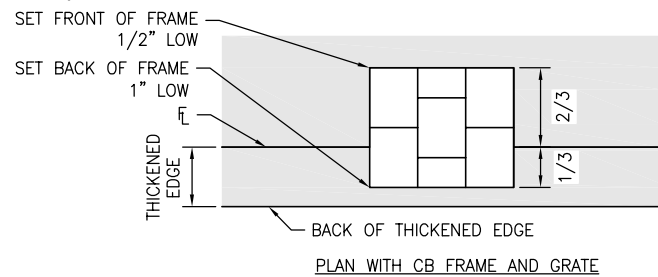

- NOTES:
1. ASPHALT PERIMETER SHALL EXTEND 2" BELOW ADJUSTMENT RINGS.
 2. UTILITIES WITH CONCRETE RINGS AROUND STRUCTURE SHALL HAVE CONCRETE REMOVED AND REPLACED WITH ACP PER THIS DETAIL.
 3. ADD OR REMOVE BRICK AND/OR RISERS TO ACHIEVE REQUIRED FINISHED RIM ELEVATION.
 4. CATCH BASINS IN THE FLOWLINE SHALL BE ADJUSTED TO FINISH GRADE PRIOR TO PAVING UNLESS DIRECTED BY THE ENGINEER.
 5. MANHOLES, VALVE BOXES, AND MONUMENTS SHALL BE ADJUSTED TO FINISH GRADE AFTER PAVING.

1 TYPICAL UTILITY ADJUSTMENT
NTS

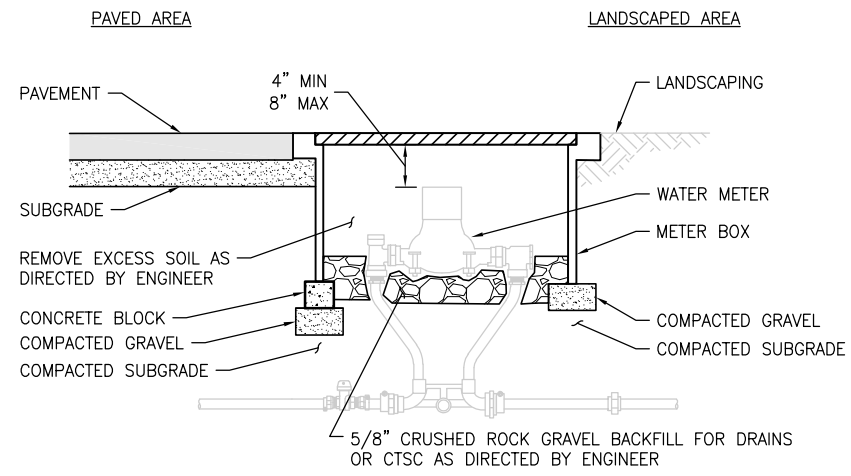

- NOTES:
1. PLACE CRUSHED ROCK BACKFILL TO THE BOTTOM OF THE METER TO PREVENT FREEZING.
 2. PLACE THE METER BOX SO VALVES ON EITHER SIDE OF THE METER ARE OPERABLE FROM THE INSIDE OF THE METER BOX.
 3. METER BOX SHALL BE PROVIDED BY CITY (FOG TITE J20S STEEL BOX OR EQUAL).

2 WATER METER BOX ADJUSTMENT
NTS

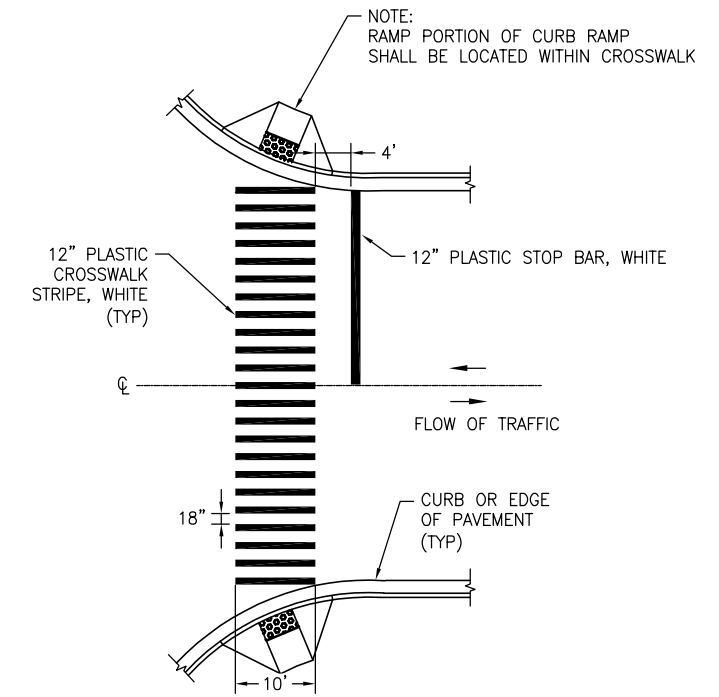

3 CROSSWALK AND STOP BAR STRIPING
NTS

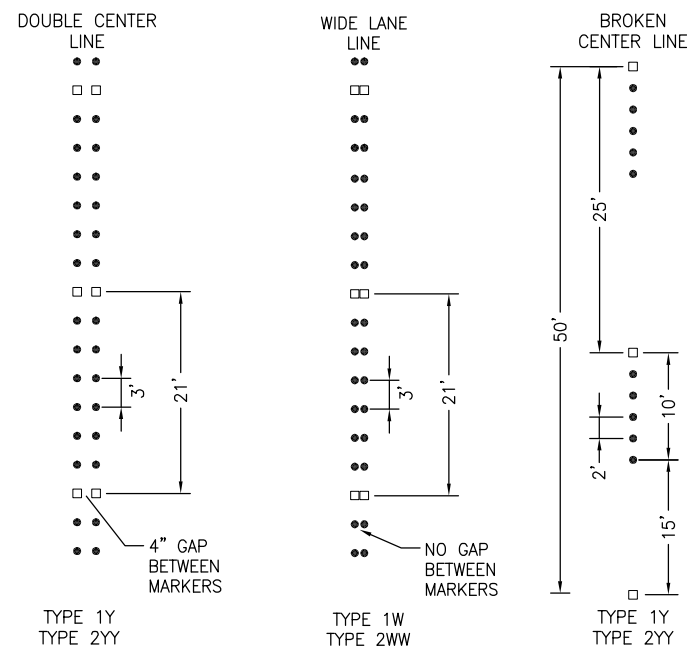

- TYPE 1 RAISED PAVEMENT MARKER
- TYPE 2 RAISED PAVEMENT MARKER

TYPE 2 RPM RAISED FACE COLORS	
TYPE 2YY	YELLOW AND YELLOW
TYPE 2W	WHITE-ONE SIDE ONLY
TYPE 2WW	WHITE-ONE SIDE ONLY
TYPE 1 RPM COLORS	
TYPE 1W	WHITE
TYPE 1Y	YELLOW

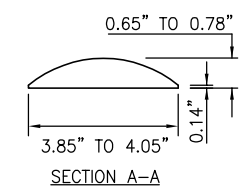
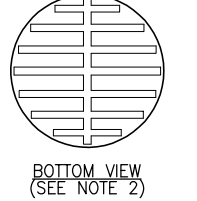
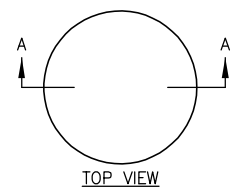

TYPE 1

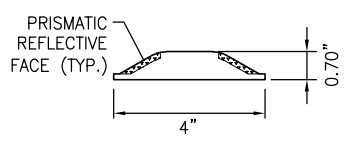
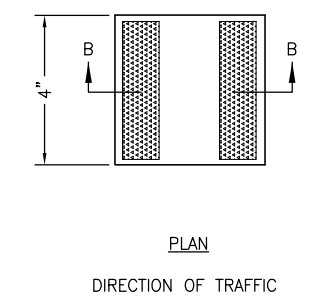

TYPE 2

GENERAL NOTE:
ALL MARKERS INSTALLED ON HMA PAVEMENTS SHALL BE INSTALLED WITH BITUMINOUS ADHESIVE, CRAFCO STANDARD PAVEMENT MARKER ADHESIVE. SEE SPECIFICATION SECTION 9-02.1(8) AND 8-09.

- TYPE 1 NOTES:
1. TYPE 1 MATERIAL-MARKER SHALL BE MOLDED OF A HIGH IMPACT, RECYCLED ACRYLONITRILE BUTADIENE STYRENE (ABS).
 2. MARKER BOTTOM SHALL ALLOW UPWARD FLOW OF ADHESIVE AND VENTING TO PREVENT AIR ENTRAPMENT.

- TYPE 2 NOTES:
1. RAISED PAVEMENT MARKERS TYPE 2 SHALL BE STIMONITE C80 OR APPROVED EQUAL.
 2. SUBSTITUTE PAVEMENT MARKERS SHALL NOT BE ACCEPTED WITHOUT WRITTEN APPROVAL BY THE ENGINEER, PRIOR TO THE INSTALLATION.

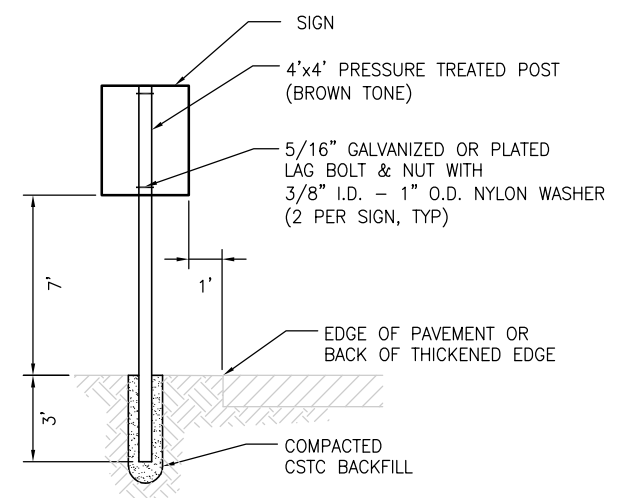

NOTE:
SIGN SHALL BE ATTACHED WITH TOP EDGE OF SIGN FLUSH WITH TOP OF POST.

5 SIGN INSTALLATION
NTS

4 RAISED PAVEMENT MARKERS
NTS



REV. NO.	DATE	DESCRIPTION

BID DOCUMENT



DATE	5/3/2023
DESIGN	CFG
DRAFT	CFG
CHECK	CEM

CITY OF MERCER ISLAND
2023 RESIDENTIAL STREET OVERLAYS

DETAILS

PROJECT	23-16
SCALE	1"=20'
SHEET	17 OF 18

File: Z:\2022 Projects\2012 2023 M Overlays\Bona\2012_P-021.dwg ID: bennard Date: 05-May-23 2:30:40pm

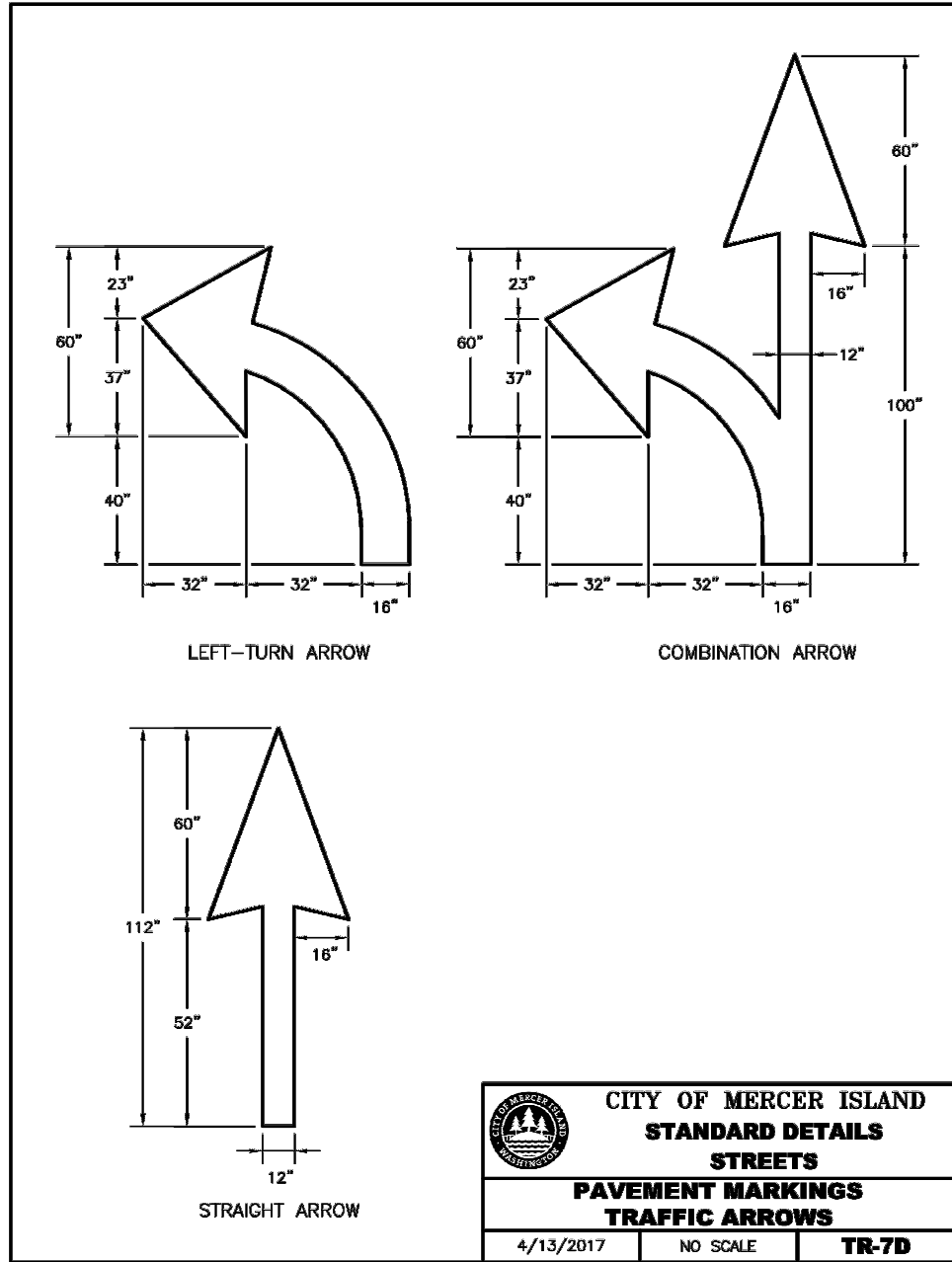

1 TRAFFIC ARROWS
NTS

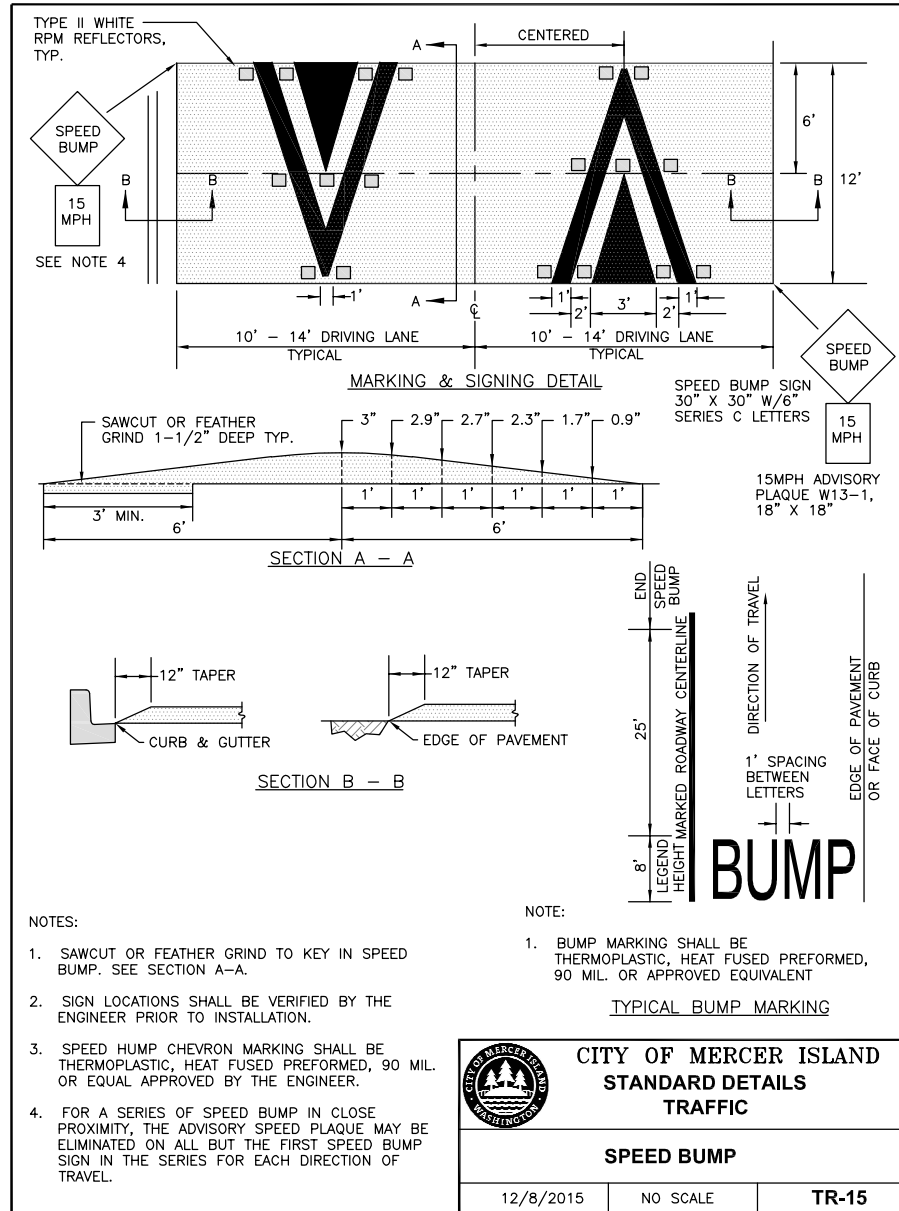

2 SPEED BUMP AND SPEED BUMP MARKINGS
NTS

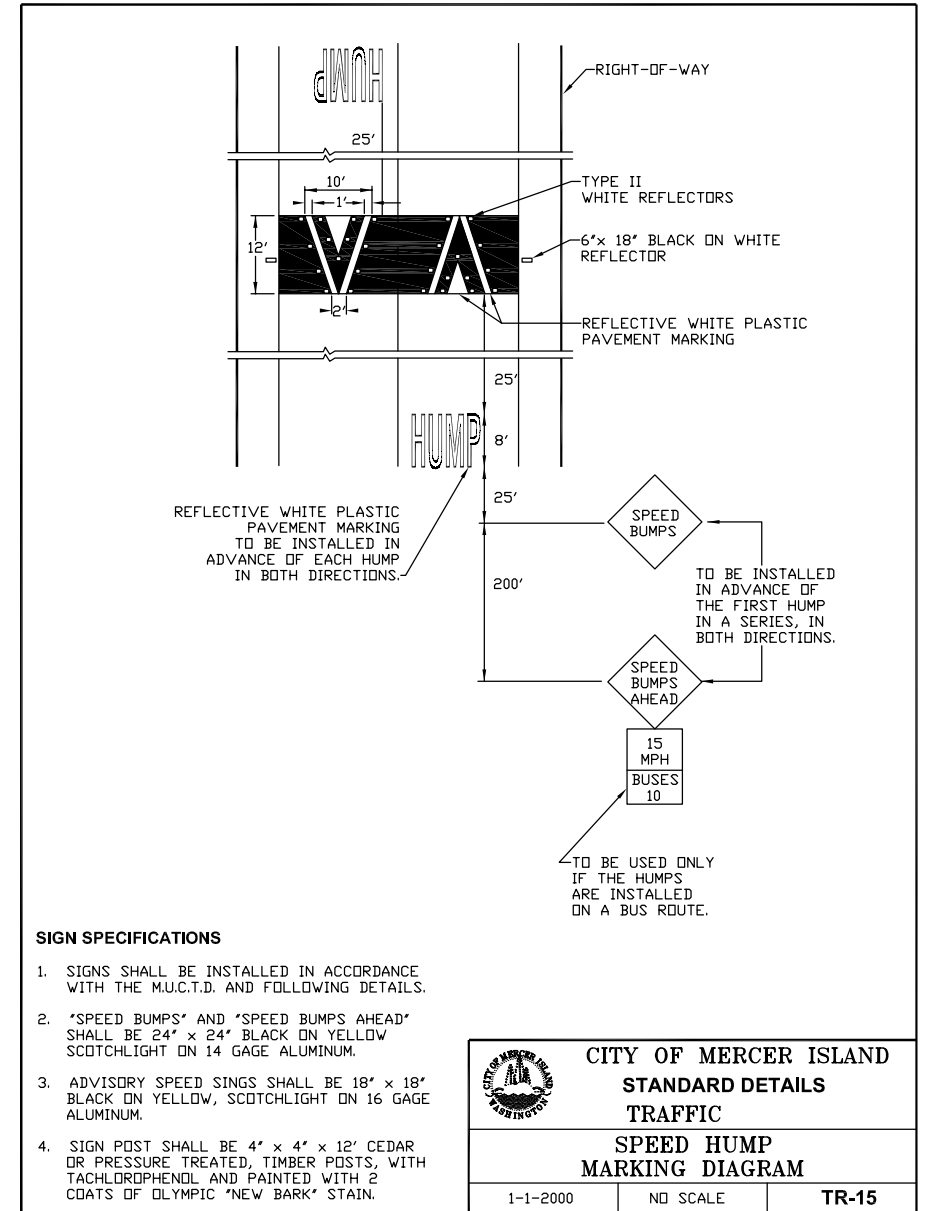

SIGN SPECIFICATIONS

- SIGNS SHALL BE INSTALLED IN ACCORDANCE WITH THE M.U.C.T.D. AND FOLLOWING DETAILS.
- "SPEED BUMPS" AND "SPEED BUMPS AHEAD" SHALL BE 24" x 24" BLACK ON YELLOW SCOTCHLIGHT ON 14 GAGE ALUMINUM.
- ADVISORY SPEED SIGNS SHALL BE 18" x 18" BLACK ON YELLOW, SCOTCHLIGHT ON 16 GAGE ALUMINUM.
- SIGN POST SHALL BE 4" x 4" x 12" CEDAR OR PRESSURE TREATED, TIMBER POSTS, WITH TACHLOROPHENDL AND PAINTED WITH 2 COATS OF OLYMPIC "NEW BARK" STAIN.

4-49



REV. NO.	DATE	DESCRIPTION

BID DOCUMENT



DATE	5/3/2023
DESIGN	CFG
DRAFT	CFG
CHECK	CEM

CITY OF MERCER ISLAND
2023 RESIDENTIAL STREET OVERLAYS

DETAILS

PROJECT	23-16
SCALE	1"=20'
SHEET	18 OF 18